

HE  
370  
.075  
S630  
1966

IOWA STATE HIGHWAY COMMISSION  
LIBRARY

**SPECIAL  
ORIGIN AND DESTINATION  
STUDY  
DELAWARE COUNTY**

**May 1966**

**PREPARED BY  
TRAFFIC AND HIGHWAY PLANNING DEPARTMENT  
DIVISION OF PLANNING  
IOWA STATE HIGHWAY COMMISSION  
IN COOPERATION WITH THE  
UNITED STATES DEPARTMENT OF COMMERCE  
BUREAU OF PUBLIC ROADS**

17-H53HP  
2:Or16  
Delaware  
Co.

ounty 1966

17-H53HP  
2:0r16  
Delaware Co.

TABLE OF CONTENTS

	Page
Summary . . . . .	1
Chart # 1 Flow of Traffic Through Station Number 1 . . . . .	3
Chart # 2 Flow of Traffic Through Station Number 2 . . . . .	4
Chart # 3 Desire Lines of Travel Trips Passing Through Station Number 1 . . . . .	5
Chart # 4 Desire Lines of Travel Trips Passing Through Station Number 2 . . . . .	6
Table # 1 Termini of Trips Passing Through Station Number 1 . . . . .	7
Table # 2 Termini of Trips Passing Through Station Number 2 . . . . .	12

## SUMMARY

The purpose of this study is to present an analysis of the average 1966 Spring weekday traffic in an area of Delaware County. The study is based on a survey of the origin and destination of trips made at two interview stations. The location of these stations are, (#1) the west line of Section 28, Township 89N, Range 3W, and (#2) the west line of Section 3, Township 88N, Range 3W.

The data used was obtained by interviewing drivers at Station # 1 during an eight hour period from 2 p.m. until 10 p.m. on May 24, 1966 and an eight hour period from 6 a.m. to 2 p.m. on May 26, 1966 and by interviewing drivers at Station # 2 during a sixteen hour period from 6 a.m. to 10 p.m. on May 25, 1966.

Each driver was asked the origin, destination, and purpose of his trip. Also recorded were the direction of travel, type of vehicle, state of registration, county of registration of Iowa vehicles, and the number of occupants in the vehicle. Automatic traffic recorders were used to aid in expanding the 16-hour interviews conducted at each station to an average 1966 Spring weekday traffic volume.

The results of the study are presented in the charts and tables described in the following paragraphs.

Chart # 1 and Chart # 2 are traffic flow charts illustrating the dispersion of traffic between points of origin and/or destination through the interview stations described above.

These charts are not intended to show exact routes, but rather to show approximate routes and the travel desire of traffic as it approaches or leaves the interview station. Trip origins and destinations are not differentiated and the individual totals may be considered as either origin or destination. The charts reflect the average 1966 Spring weekday traffic flow at the two stations. It should be noted origins and destinations, if rural, pertain to the section in which the farm is located, and to the municipality if the location is urban.

Charts 3 and 4 are desire line charts, which illustrate the straight line desire between the origins and destinations of all trips entering the two interview stations without regard to existing routes or actual routes traveled.

Tables # 1 and # 2 are listings of the origins and/or destinations of all trips entering Stations # 1 and # 2 respectively.

When expanded to represent an average of 740 trips per Spring weekday, the interview data indicates 456 trips were made within the county and the remaining 284 trips had either or both origin and destination outside of Delaware County.

**FLOW OF TRAFFIC**  
**THROUGH STATION NUMBER 1**  
**COUNTY TRUNK 'G' WEST LINE SEC. 28, T-89N, R-3W**  
**DELAWARE COUNTY**  
**AVERAGE SPRING WEEKDAY 1966**

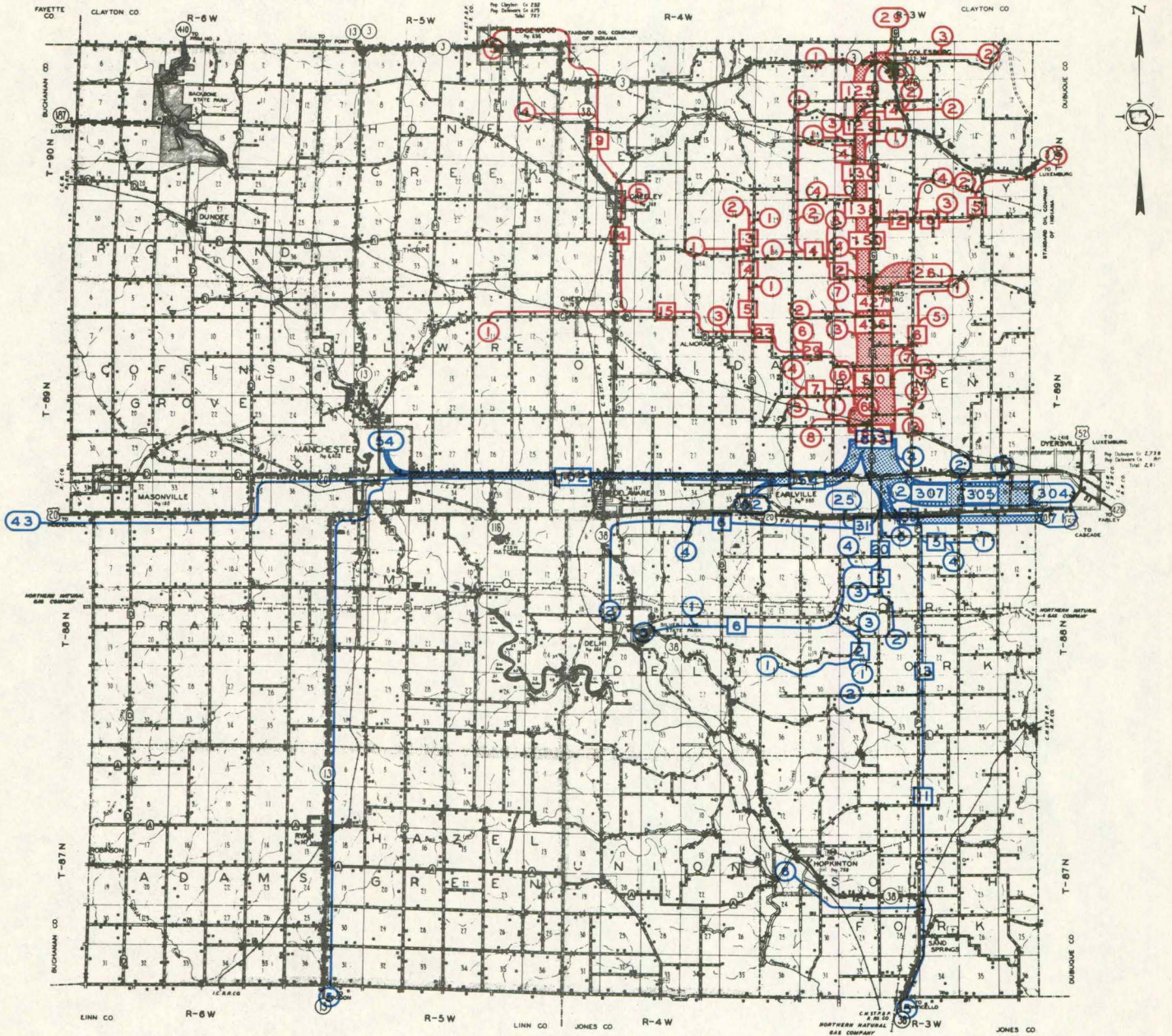

**FLOW OF TRAFFIC**  
**THROUGH STATION NUMBER 2**  
**COUNTY TRUNK 'P' WEST LINE SEC 3, T-88N, R-3W**  
**DELAWARE COUNTY**  
**AVERAGE SPRING WEEKDAY 1966**

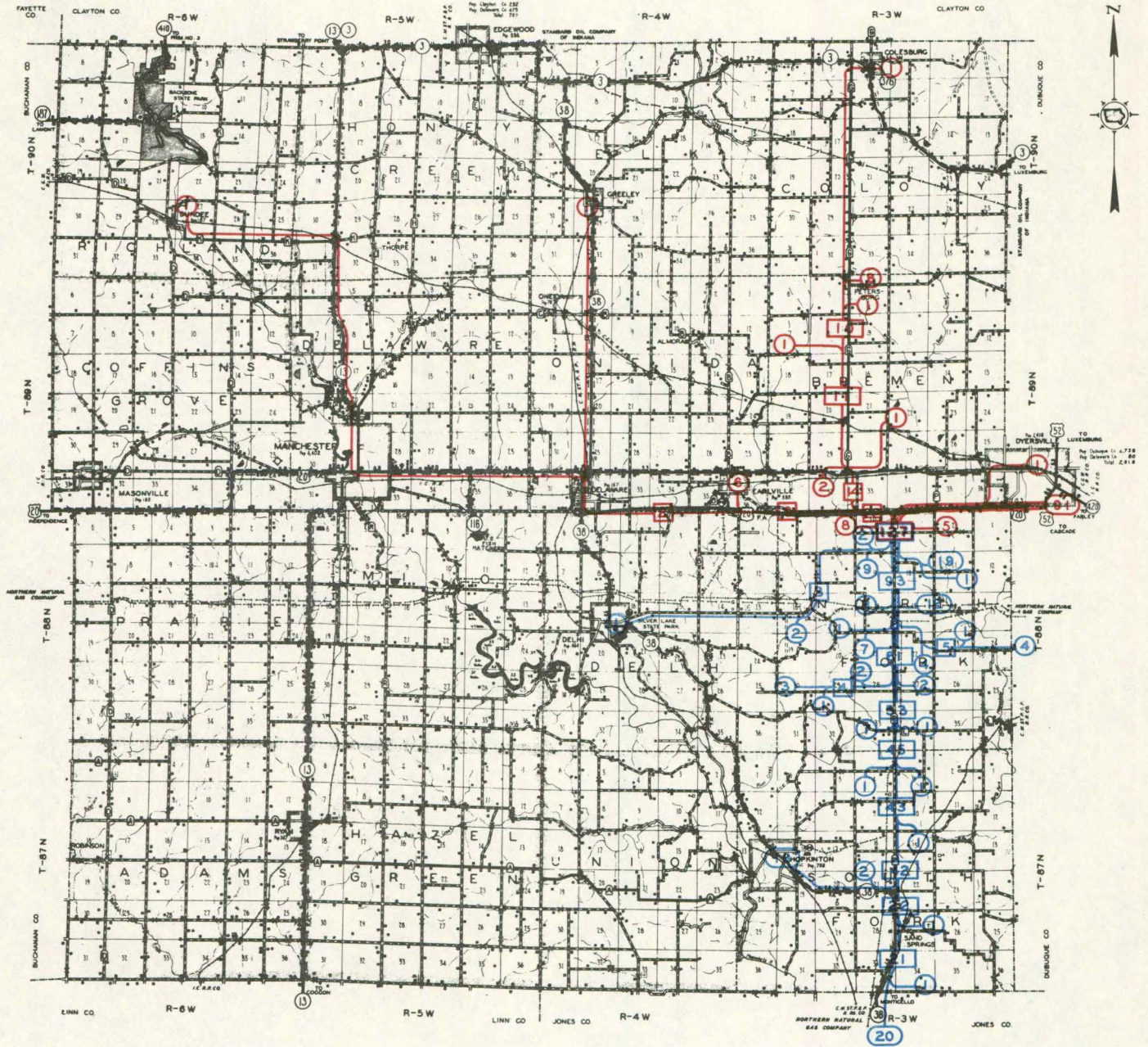

DESIRE LINES OF TRAVEL  
TRIPS PASSING THROUGH STATION NUMBER 1  
COUNTY TRUNK 'G' WEST LINE SEC. 28, T-89N, R-3W  
DELAWARE COUNTY  
AVERAGE SPRING WEEKDAY 1966

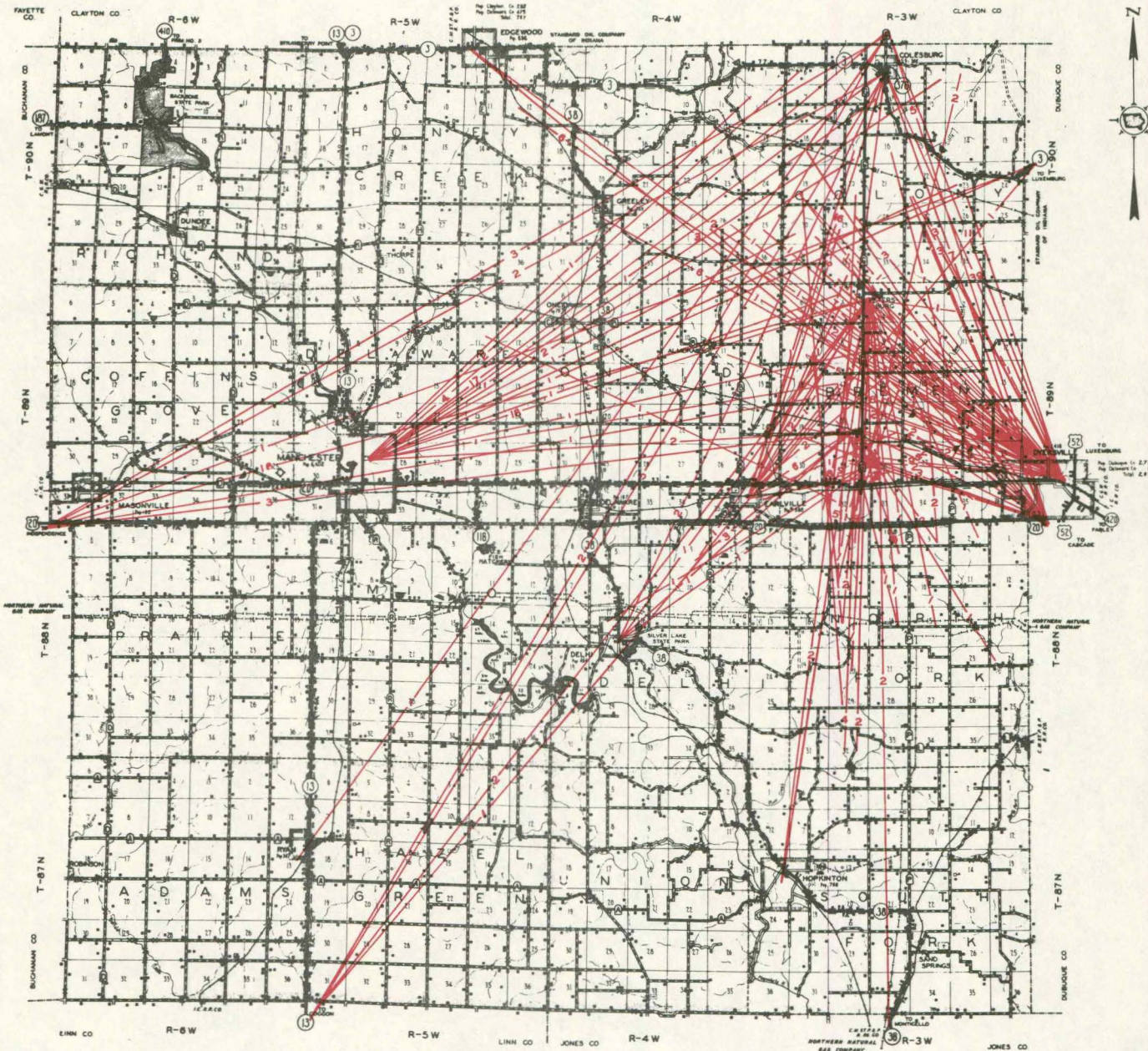

**DESIRE LINES OF TRAVEL**  
**TRIPS PASSING THROUGH STATION NUMBER 2**  
**COUNTY TRUNK 'P' WEST LINE SEC. 3, T-88N, R-3W**  
**DELAWARE COUNTY**  
**AVERAGE SPRING WEEKDAY 1966**

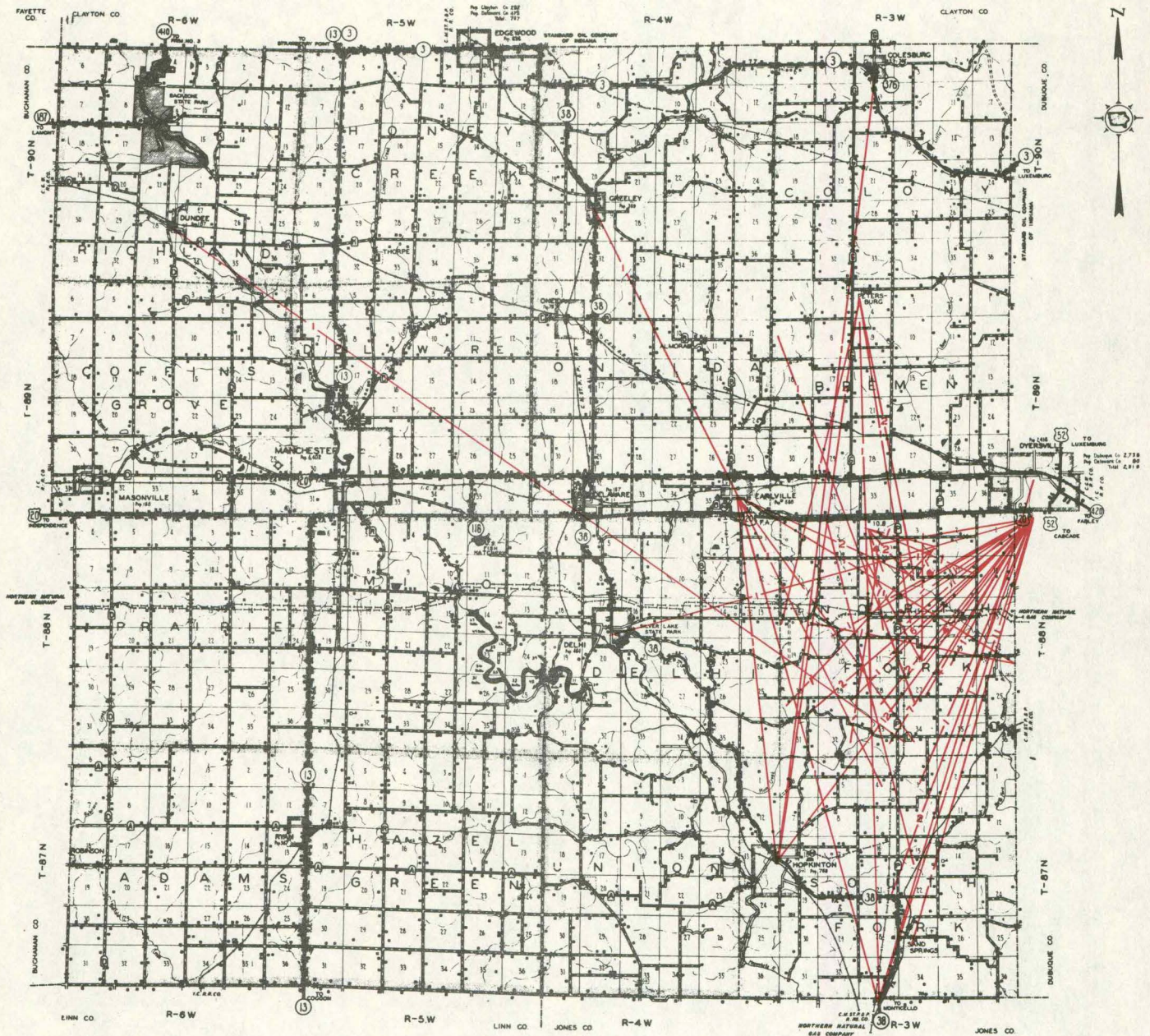



Table-1  
 TERMINI OF TRIPS  
 PASSING THROUGH STATION # 1  
 CO. "G" W-LINE SEC. 28, T-89N, R-3W

Delaware County

Average Spring Week Day 1966

Trip Terminal	Trip Terminal	Total No. of Trips
Cedar Rapids	Decorah	1
Cedar Rapids	Guttenberg	1
Cedar Rapids	Petersburg	1
Cedar Rapids	89-3-17	1
Colesburg	Cedar Rapids	3
Colesburg	Delhi	2
Colesburg	Dubuque	4
Colesburg	Dyersville	38
Colesburg	Earlville	16
Colesburg	Farley	3
Colesburg	Hopkinton	2
Colesburg	Manchester	17
Colesburg	Peoria, Ill.	1
Colesburg	Waterloo	2
Delhi	Petersburg	1
Delhi	Petersburg Spur	1
Delhi	89-3-28	1
Des Moines	Petersburg	1
Dubuque	Edgewood	2
Dubuque	Petersburg Spur	1
Dubuque	Strawberry Point	2
Dubuque	89-3-5	2
Dubuque	89-3-16	1
Dubuque	89-3-17	2
Dubuque	89-3-29	3
Dubuque	90-3-18	1
Dubuque	90-3-27	1
Dyersville	Edgewood	4
Dyersville	Elkport	1
Dyersville	Greeley	6
Dyersville	Petersburg	139
Dyersville	Petersburg Spur	27
Dyersville	Strawberry Point	8
Dyersville	89-3-9	1

\* Rural locations are described by a series of three numbers denoting township, range, and section number, respectively.

Trip Terminal	Trip Terminal	Total No. of Trips
Dyersville	89-4-11	1
Dyersville	89-3-3	1
Dyersville	89-3-5	1
Dyersville	89-3-6	2
Dyersville	89-3-7	5
Dyersville	89-3-8	1
Dyersville	89-3-9	14
Dyersville	89-3-10	1
Dyersville	89-3-12	1
Dyersville	89-3-16	6
Dyersville	89-3-17	7
Dyersville	89-3-18	2
Dyersville	89-3-19	2
Dyersville	89-3-21	6
Dyersville	89-3-28	9
Dyersville	89-3-29	2
Dyersville	89-4-11	1
Dyersville	90-3-19	1
Dyersville	90-3-22	3
Dyersville	90-3-23	1
Dyersville	90-3-27	3
Dyersville	90-3-29	3
Dyersville	90-3-30	1
Dyersville	90-3-31	1
Dyersville	90-3-32	1
Dyersville	90-4-25	1
Dyersville	90-4-26	1
Dyersville	90-4-35	1
Dyersville	90-4-36	1
Dyersville	90-5-12	6
Earlville	Petersburg	11
Earlville	Petersburg Spur	6
Earlville	89-3-5	1
Earlville	89-3-10	2
Earlville	89-3-17	3
Earlville	89-3-18	1
Earlville	89-3-21	1
Earlville	89-3-28	2
Earlville	90-3-17	1
Earlville	90-3-29	6
Earlville	90-3-32	1
Edgewood	Maquoketa	2
Epworth	89-3-17	1
Farley	Petersburg	1

\* Rural locations are described by a series of three numbers denoting, township, range, and section number, respectively.

Trip Terminal	Trip Terminal	Total No. of Trips
Farley	Petersburg Spur	2
Garber	Cedar Rapids	2
Gilbertville	Petersburg	1
Guttenberg	Ryan	1
Holy Cross	Independence	1
Independence	Guttenberg	1
Independence	Luxemburg	1
Jersey Co., Ill	89-3-29	1
Jo Daviess Co., Ill	Petersburg	1
Jo Daviess Co., Ill	89-3-9	1
Jo Daviess Co., Ill	89-3-19	1
Luxemburg	Manchester	1
Manchester	Guttenberg	4
Manchester	Petersburg	8
Manchester	Petersburg Spur	1
Manchester	89-3-5	1
Manchester	89-3-9	1
Manchester	89-3-17	1
Manchester	90-3-3	1
Manchester	90-3-6	2
Manchester	90-3-9	1
Manchester	90-3-17	2
Manchester	90-3-23	1
Manchester	90-3-30	1
Manchester	90-4-12	1
Monticello	Elkader	1
Mount Vernon	89-3-18	1
New Vienna	Earlville	1
Oelwein	Dubuque	1
Oelwein	Petersburg	1
Petersburg	Bernard	1
Petersburg	Cedar Falls	2
Petersburg	Cook Co., Ill.	1
Petersburg	Dubuque	19
Petersburg	Hopkinton	5
Petersburg	Independence	2
Petersburg	Manchester	10
Petersburg	Monticello	4
Petersburg	Preston	3
Petersburg	Walker	2
Petersburg	Washburn	2
Petersburg	Waterloo	2
Petersburg	Winthrop	4
Petersburg	Worthington	5

\* Rural locations are described by a series of three numbers denoting, township, range, and section number, respectively.

Trip Terminal	Trip Terminal	Total No. of Trips
Petersburg	88-3-2	1
Petersburg	88-3-4	1
Petersburg	88-3-5	3
Petersburg	88-3-15	1
Petersburg	88-3-16	1
Petersburg	88-3-17	2
Petersburg	88-3-20	1
Petersburg	88-3-32	2
Petersburg	88-4-3	1
Petersburg	89-3-2	1
Petersburg	89-3-17	1
Petersburg	89-3-32	8
Petersburg	89-3-33	2
Petersburg Spur	Manchester	1
Petersburg Spur	New Vienna	1
Petersburg Spur	Rowley	2
Petersburg Spur	Waterloo	1
Petersburg Spur	88-3-3	2
Petersburg Spur	88-3-4	3
Petersburg Spur	88-3-5	1
Petersburg Spur	88-3-24	1
Petersburg Spur	88-3-32	4
Petersburg Spur	88-4-3	3
Petersburg Spur	88-3-4	3
Petersburg Spur	89-3-28	1
Petersburg Spur	89-3-32	5
Rowley	Petersburg	2
Rowley	Petersburg Spur	1
Sumner	Petersburg	1
Vinton	Petersburg	1
Waterloo	Guttenberg	1
Winnebago Co., Ill.	Petersburg	1
Worthington	90-3-22	1
Worthington	90-3-32	1
Worthington	90-4-26	1
88-3-3	89-3-10	2
88-3-8	90-3-2	2
88-3-8	90-3-20	1
89-3-7	88-3-17	1
89-3-16	89-3-32	5
89-3-17	88-3-16	1
89-3-26	90-3-16	1
89-3-28	88-4-17	1

\* Rural locations are described by a series of three numbers denoting, township, range, and section number respectively.

Trip Terminal	Trip Terminal	Total No. of Trips
89-3-28	89-3-20	1
89-3-28	89-4-36	1
89-3-29	89-3-28	1
89-3-29	89-3-29	1
89-3-32	89-5-11	1
90-3-19	88-3-29	1
90-3-19	89-3-25	1
90-3-32	89-3-26	1
Total		613

\* Rural locations are described by a series of three numbers denoting township, range and section number , respectively.

Table -2  
 TERMINI OF TRIPS  
 PASSING THROUGH STATION # 2  
 CO. "P", W-LINE SEC. 3, T-88N, R-3W

Delaware County

Average Spring Week Day 1966

Trip Terminal	Trip Terminal	Total No. of Trips
Anamosa	Dyersville	1
Anamosa	New Vienna	2
Delhi	Dyersville	1
Dubuque	Cedar Rapids	1
Dubuque	88-3-23	1
Dundee	88-3-34	1
Dyersville	Hopkinton	10
Dyersville	Monticello	5
Dyersville	Sandsprings	1
Dyersville	Wernes Pond	2
Dyersville	87-3-3	1
Dyersville	87-3-21	2
Dyersville	88-3-4	1
Dyersville	88-3-9	5
Dyersville	88-3-10	10
Dyersville	88-3-15	11
Dyersville	88-3-16	3
Dyersville	88-3-17	1
Dyersville	88-3-21	6
Dyersville	88-3-27	4
Dyersville	88-3-28	2
Dyersville	88-3-29	1
Dyersville	88-3-30	2
Dyersville	88-3-33	7
Earlville	Monticello	1
Earlville	88-3-10	2
Earlville	88-3-34	1
Farley	Earlville	1
Farley	88-3-9	1
Farley	88-3-10	1
Farley	88-3-18	1
Garber	Monticello	1
Greeley	87-3-4	1
Hopkinton	Colesburg	1
Hopkinton	Dubuque	2

\* Rural locations are described by a series of three numbers denoting township, range and section.

Trip Terminal	Trip Terminal	Total No. of Trips
Hopkinton	Earlville	1
Hopkinton	Petersburg	4
Iowa City	Dubuque	1
Luxemburg	Wernes Pond	1
Luxemburg	88-3-10	1
Monticello	Guttenberg	1
Monticello	89-3-4	1
New Vienna	Wernes Pond	2
Petersburg	88-3-10	2
Petersburg	88-3-15	1
Petersburg	88-3-18	1
Wernes Pond	88-3-3	1
Wernes Pond	88-3-4	1
87-3-15	89-3-32	1
88-3-3	88-3-3	1
88-3-3	88-3-4	1
88-3-3	88-3-10	1
88-3-3	88-3-30	1
88-3-4	88-3-9	4
88-3-4	88-3-10	2
88-3-4	88-3-16	1
88-3-4	88-3-32	1
88-3-11	88-3-4	1
88-3-27	89-3-7	1
Total		127

\* Rural locations are described by a series of three numbers denoting township, range and section.

