

# A d d e n d u m

Iowa Department of Transportation  
Office of Contracts

Date of Letting: August 15, 2017  
Date of Addendum: August 14, 2017

<b>B.O.</b>	<b>Proposal ID</b>	<b>Proposal Work Type</b>	<b>County</b>	<b>Project Number</b>	<b>Addendum</b>
102	62-7860-601	PCC PAVEMENT - REPLACE	MAHASKA	STP-U-7860(601)--70-62	15AUG102A01

Make the following changes to the PLANS:

Sheet B.01 is in error and the L Sheets are correct. CD baskets are not required. Joints should be L1 and C.

Add the attached sheet B.02.

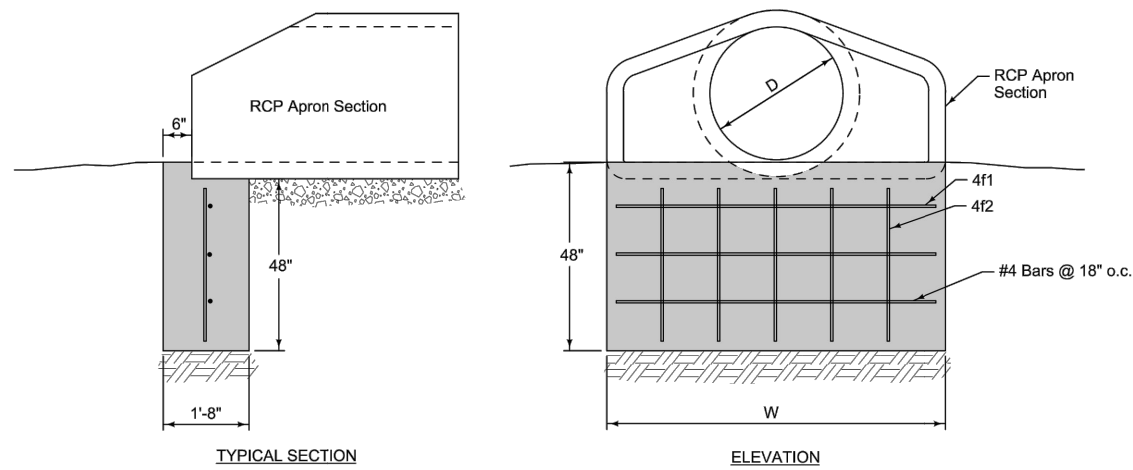

REINFORCING BAR LIST

D	W	Mark	Size	Length	Count	D	W	Mark	Size	Length	Count
12"	2'-4"	4f1	4	2'-0"	3	48"	7'-10"	4f1	4	7'-6"	3
		4f2	4	3'-8"	2			4f2	4	3'-8"	6
15"	2'-10 1/2"	4f1	4	2'-6 1/2"	3	54"	8'-5"	4f1	4	8'-1"	3
		4f2	4	3'-8"	2			4f2	4	3'-8"	6
18"	3'-5"	4f1	4	3'-1"	3	60"	8'-11"	4f1	4	8'-7"	3
		4f2	4	3'-8"	3			4f2	4	3'-8"	6
24"	4'-6"	4f1	4	4'-2"	3	66"	8'-11"	4f1	4	8'-7"	3
		4f2	4	3'-8"	3			4f2	4	3'-8"	6
30"	5'-7"	4f1	4	5'-3"	3	72"	10'-0"	4f1	4	9'-8"	3
		4f2	4	3'-8"	4			4f2	4	3'-8"	7
36"	6'-8"	4f1	4	6'-4"	3	78"	10'-7"	4f1	4	10'-3"	3
		4f2	4	3'-8"	5			4f2	4	3'-8"	7
42"	7'-3"	4f1	4	6'-11"	3	84"	11'-1"	4f1	4	10'-9"	3
		4f2	4	3'-8"	5			4f2	4	3'-8"	8

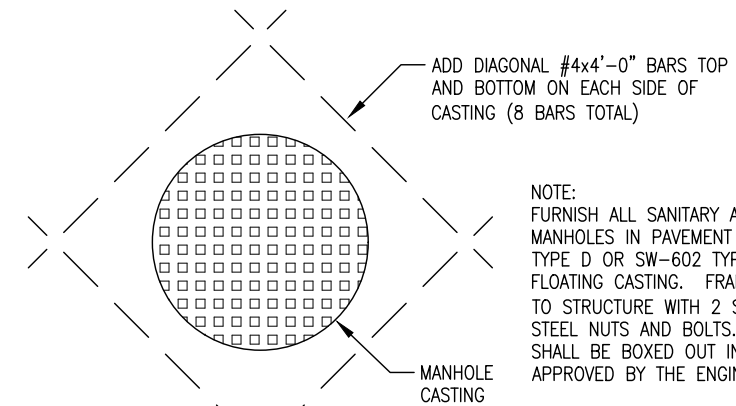
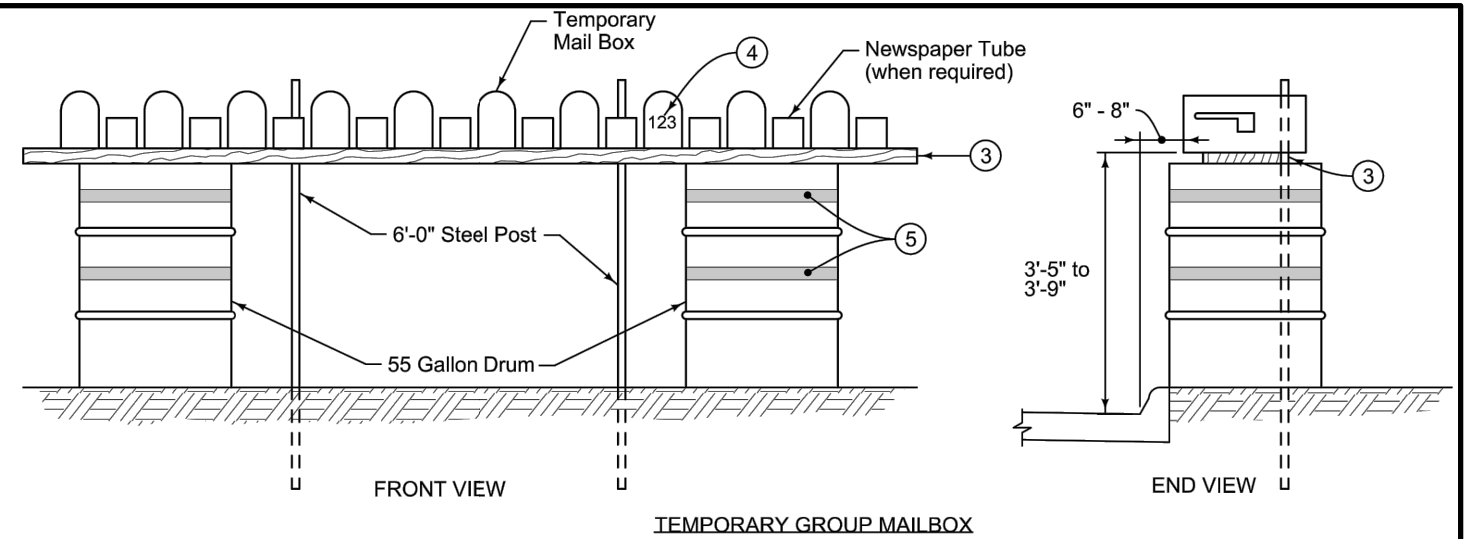
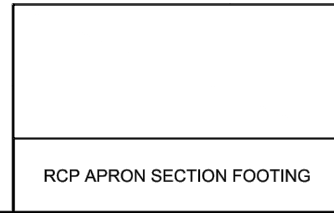

NOTE:  
 FURNISH ALL SANITARY AND STORM SEWER MANHOLES IN PAVEMENT WITH AN SW-601 TYPE D OR SW-602 TYPE F THREE-PIECE FLOATING CASTING. FRAME SHALL BE BOLTED TO STRUCTURE WITH 2 SETS OF 1/2" STAINLESS STEEL NUTS AND BOLTS. NO MANHOLE LIDS SHALL BE BOXED OUT IN PAVEMENT UNLESS APPROVED BY THE ENGINEER.

SANITARY AND STORM SEWER MANHOLE CASTING - PAVEMENT REINFORCEMENT  
 NO SCALE

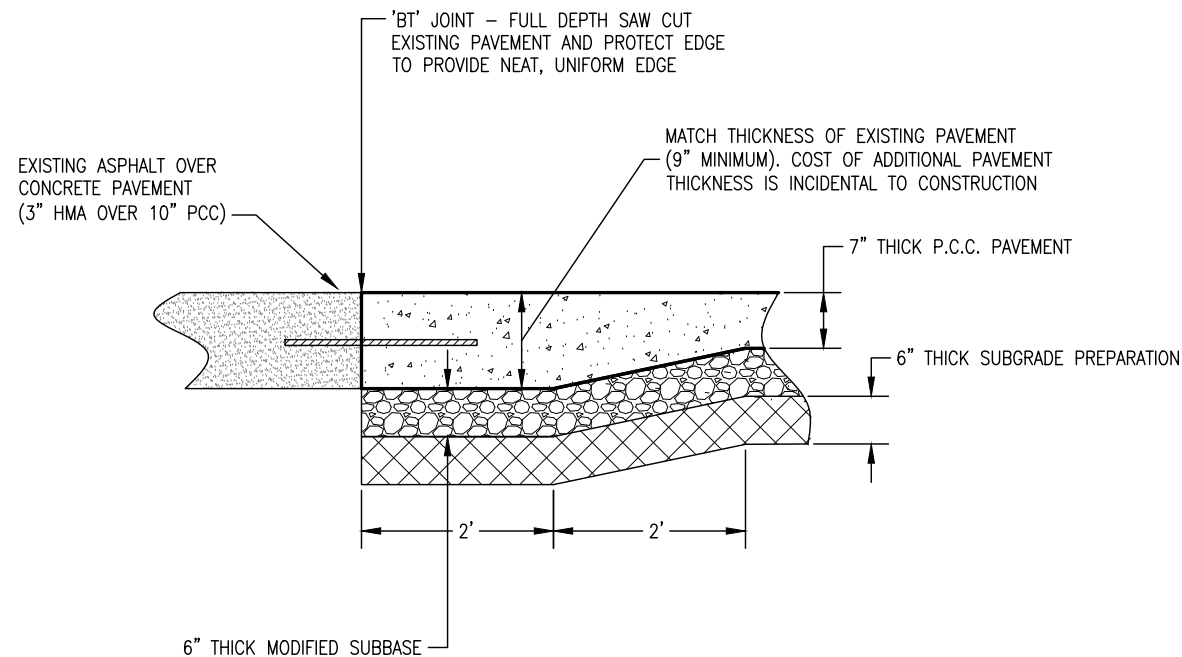

THICKENED EDGE SECTION DETAIL  
 NO SCALE

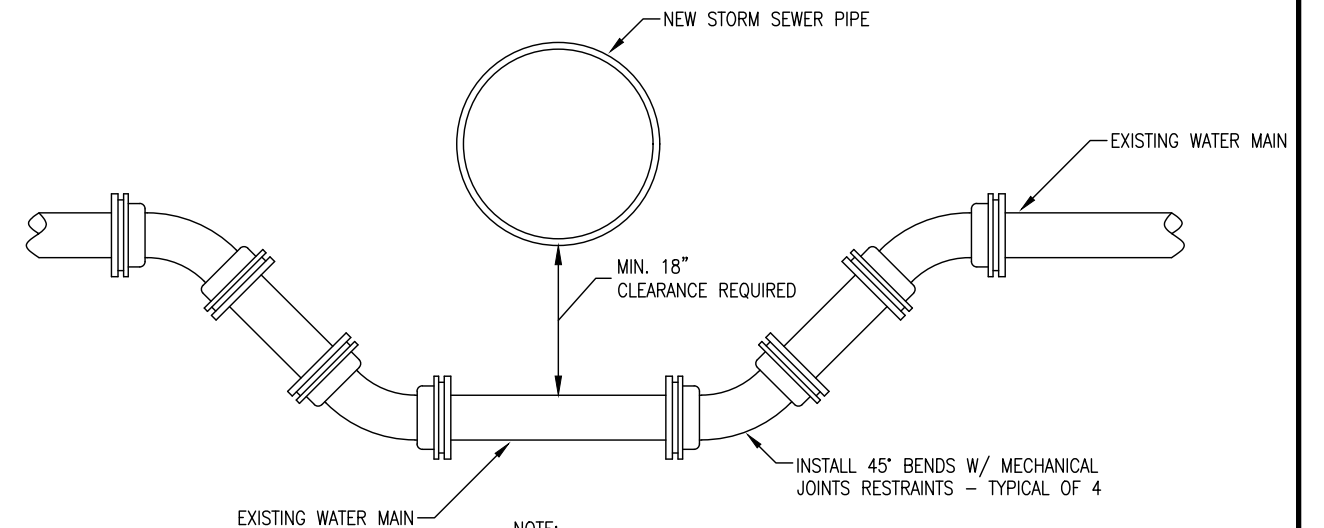

DETAIL - LOWER EXISTING WATER MAIN  
 NO SCALE

NOTE:  
 PROVIDE THRUST BLOCKS FOR PIPE BENDS IN ACCORDANCE WITH STANDARD ROAD PLAN WM-101.