

A d d e n d u m

Iowa Department of Transportation
Office of Contracts

Date of Letting: April 19, 2016
Date of Addendum: March 25, 2016

B.O.	Proposal ID	Proposal Work Type	County	Project Number	Addendum
104	34-C034-094	PCC OVERLAY - UNBOUNDED	FLOYD	FM-C034(94)--55-34	19APR104.A01

Notice: Only the bid proposal holders receive this addendum and responsibility for notifying any potential subcontractors or suppliers remains with the proposal holder.

Make the following changes to the PROPOSAL SCHEDULE OF PRICES:

Add Proposal Line No. 0035 2301-1033080 STANDARD OR SLIPFORM PORTLAND CEMENT CONCRETE PAVEMENT, CLASS C, CLASS 3 DURABILITY, 8 IN., 3603.000 SY

Change Proposal Line No. 0060 2310-5151040 PORTLAND CEMENT CONCRETE OVERLAY, FURNISH ONLY:

From: 13,585.000 CY

To: 12,777.000 CY

Change Proposal Line No. 0070 2310-5151251 PORTLAND CEMENT CONCRETE OVERLAY, PLACEMENT ONLY (UNBONDED):

From: 70,356.000 SY

To: 66,084.000 SY

If the above changes are not made, they will be made as shown here.

Make the following changes to the PLANS:

Replace SHEETS 2 of 4 and 4 of 4 with the attached SHEETS 2 of 4 and 4 of 4.

ESTIMATE OF QUANTITIES				
ITEM CODE NO.	REF NO.	ITEM	UNIT	Contract TOTAL
2102-2710090	1	Excavation, Class 10, Waste	Cu.Yd.	724.81
2121-7425020	2	Granular Shoulders, Type B	Ton	16,415.00
2212-0475095	3	Cleaning and Preparation of Base	Mile	5.50
2301-1033080	4	Std./Slip PCC Class C, Class 3, 8"	Sq.Yd.	3,603.00
2301-9091000	5	Rumble Strip Panel (PCC Surface)	Each	4.00
2303-0245828	6	Asphalt Binder, 58-28	Ton	223.00
2310-5151040	7	Portland Cement Concrete Overlay, Furnish Only	Cu.Yd.	12,777.00
2310-5151251	8	Portland Cement Concrete Overlay, Placement Only (Unbonded)	Sq.Yd.	66,084.00
2310-8300540	9	HMA Stress Relief Course	Ton	3,717.17
2510-6745850	10	Removal of Pavement	Sq.Yd.	3,603.00
2518-6910000	11	Safety Closure	Each	9.00
2527-9263109	12	Painted Pavement Marking, Waterborne or Solvent Based	Sta.	724.81
2528-8445110	13	Traffic Control	L.S.	1.00
2528-8445113	14	Flaggers	Day	Per Proposal
2533-4980005	15	Mobilization	L.S.	1.00
2599-9999020	16	Modified Subbase	Ton	1,175.00

Estimate Reference Information

- Material removed from the roadway shall be wasted off site to a location provided by the contractor. No payment for overhaul shall be made on this project. Pay quantity will be plan quantity adjusted for obvious errors, plan revisions, or change orders.
- Shoulders shall be 6' wide with 4% slope. See Shoulder Detail on sheet 4. Quantity includes Driveways and intersections.
- See tabulation for locations of 8" x 22' pavement. CD baskets are required at 12' spacing. No skew on transverse joints. Longitudinal joint shall be either BT-1 or L-1. Class 3 durability aggregate is required. The contractor shall provide certified plant inspection for this project. IDOT Standard Specification 2316 (pavement smoothness) shall not apply. Macrotexture shall be provided by longitudinal grooving. Maturity Method of testing shall be used for determining the time for opening pavement to traffic and shall be incidental. See intersection detail on sheet 3. Construction staking (string or stringless) supplied by Floyd County. Saw cutting for transition pavement and at tie in locations shall be included in the price of the PCC Paving.
- Contractors option to select installation method. See Road Standard PV-10 and sheet 4 for tabulations.
- Estimated at 6%
- See tabulation for locations of 7" x 22'. Where 7" pavement is specified, Transverse joints shall be spaced at 12' and shall be a "C" joint. No skew on transverse joints. Longitudinal joint shall be either BT-1 or L-1. Class 3 durability aggregate is required. The contractor shall provide certified plant inspection for this project. IDOT Standard Specification 2316 (pavement smoothness) shall not apply. Macrotexture shall be provided by longitudinal grooving. Maturity Method of testing shall be used for determining the time for opening pavement to traffic and shall be incidental. See intersection detail on sheet 3. Construction staking (string or stringless) supplied by Floyd County. Saw cutting for transition pavement and at tie in locations shall be included in the price of the concrete overlay.
- HMA shall be placed full width of the roadway. Labor, Tack Coat shall be incidental Construct as per Section 2303.03. Certified plant inspection will be required.
- Material removed from the roadway shall be taken off site to a location provided by the contractor. Pay quantity will be measured and paid for actual material removed from the site.
- Place according to tabulation on sheet 4.
- See tabulation on sheet 4.
- Flaggers shall be used to control traffic when paving HMA Stress Relief Course. One flagger an intersection ahead of the paver and one an intersection behind. Two flaggers will be needed while Paving operations commence at the two intersections (B60 and B47).
- 6" of Modified Subbase shall be placed in transition sections at the BOP, two bridges, and EOP. Subgrade preparation will be required. The work shall be done in accordance to section 2115, Certified weight tickets are required. Basis of Payment will be by the ton. Modified Subbase shall be certified material from an IDOT approved source.

STANDARD ROAD PLANS				
The following Standard Road Plans shall be considered applicable to construction work on this project				
NUMBER	DATE	SHEETS	TITLE	
PV-10	04-19-11	1	RUMBLE STRIP PANEL FOR INTERSECTION APPROACH	
PV-101	04-19-16	8	JOINTS	
TC-202	04-21-15	1	WORK WITHIN 15 FT OF TRAVELED WAY	
TC-213	04-17-12	1	LANE CLOSURE WITH FLAGGERS	
TC-252	04-19-16	3	ROUTES CLOSED TO TRAFFIC	

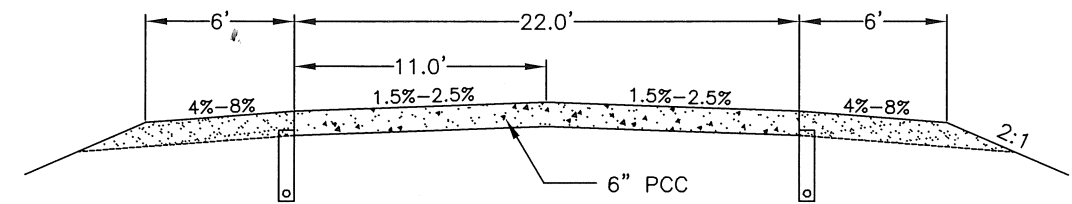

Typical Existing Cross Section
Not To Scale

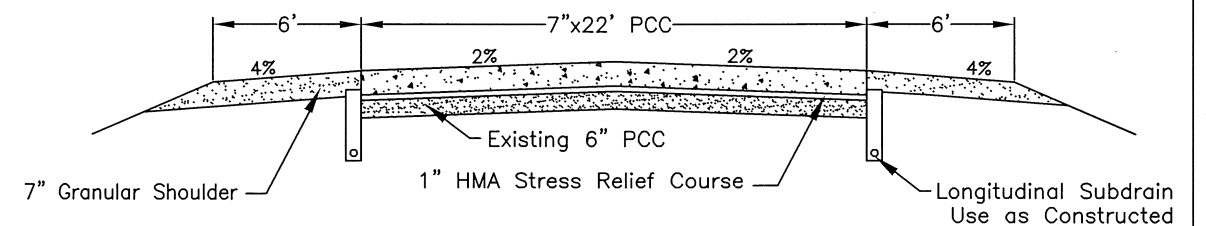

Typical Proposed Cross Section
Not To Scale

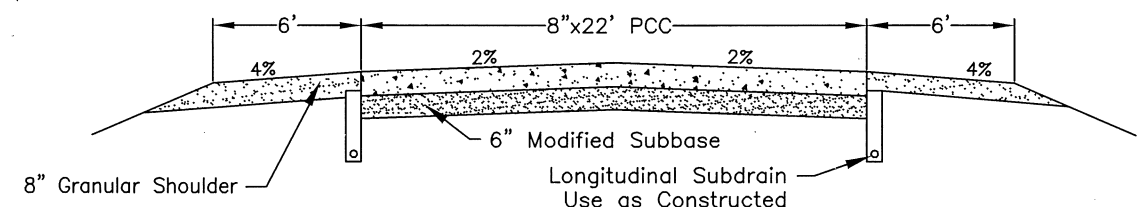

Typical Proposed Cross Section for 8" Paving
Not To Scale

TABULATION OF PAVEMENT MARKINGS

ROAD IDENTIFICATION	LOCATION	STATION TO STATION	SIDE		LENGTH (In Stations)												REMARKS		
			L	R	②	③	⑤	⑥	⑦	⑧	⑨	⑩	⑪	⑫	⑬	⑭		⑮	⑯
Dancer Ave.	Entire Project				19,560	2,019	7,455		58,068							34			
	Length Subtotals																		
	Quantity Factors				.25	2	1.25	.25	1.0	1.0	.33	1.0	2.0	2.0	6.0	1.5	3.0	3.0	
	TOTALS				48.90		93.19		580.68						2.04				724.81

RUMBLE STRIP PANELS

Refer to Standard Road Plan PV-10			
Road ID	Station	Side	Remarks
Dancer Ave.	6+45	Lt.	PCC Surface
Dancer Ave.	10+05	Lt.	PCC Surface
Dancer Ave.	277+90	Rt.	PCC Surface
Dancer Ave.	282+44	Rt.	PCC Surface

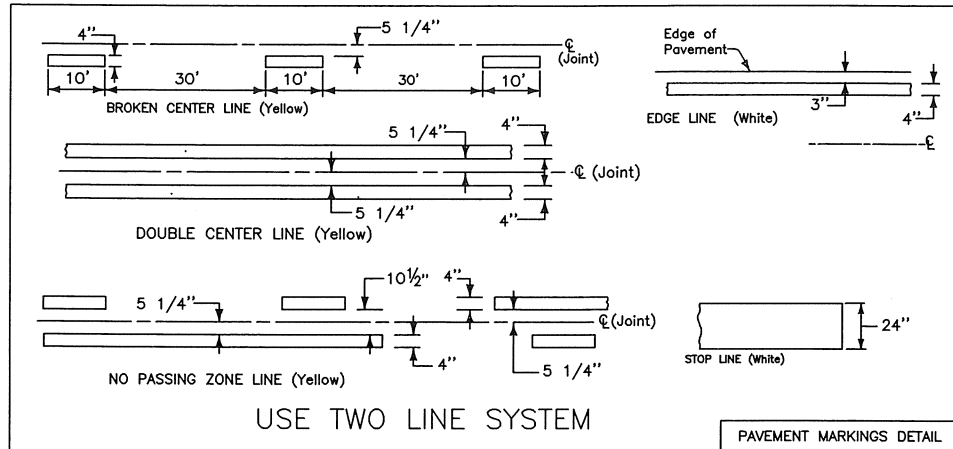

PCC PAVING TABULATION

Refer to Section 2310 of the Standard Specifications

Station to	Station	22' Wide Pavmnt.		INTERSECTION RAD.	6" PCC REMOVALS	REMARKS
		7"	8"			
0+11	2+11		200	(167 SY'S X 2)	X	8" TRANSITION PAVEMENT B.O.P. (B60)
2+11	72+18	7,007				7" UNBONDED OVERLAY
72+18	74+18		200		X	8" NEW CONSTRUCTION W/ MOD. SUBBASE
74+18	78+18					SKIP FOR BRIDGE FHWA #154131
78+18	80+18		200		X	8" NEW CONSTRUCTION W/ MOD. SUBBASE
80+18	237+05	15,687				7" UNBONDED OVERLAY
237+05	239+05		200		X	8" NEW CONSTRUCTION W/ MOD. SUBBASE
239+05	243+05					SKIP FOR BRIDGE FHWA #154890
243+05	245+05		200		X	8" NEW CONSTRUCTION W/ MOD. SUBBASE
245+05	288+45	4,340				7" UNBONDED OVERLAY
288+45	290+45		200	(167 SY'S X 2)	X	8" TRANSITION PAVEMENT E.O.P. - 215th (B47)
	TOTAL LF	27,034	1,200			
	TOTAL SY'S	66,084	3,603		3,603	Includes Radius and Mainline Paving
	TOTAL CY'S	12,777				

TABULATION OF SAFETY CLOSURES

Refer to Section 2518 of the Standard Specifications

Station	Closure Type		REMARKS
	Road Quantity	Hazard Quantity	
0+11	1		B.O.P. - 270th (B60)
52+80.29		2	260th St.
105+23.89		2	250th St.
158+21.56		1	240th St.
211+23.08		2	230th St.
290+45.00	1		E.O.P. - 215th (B47)
Total	2	7	

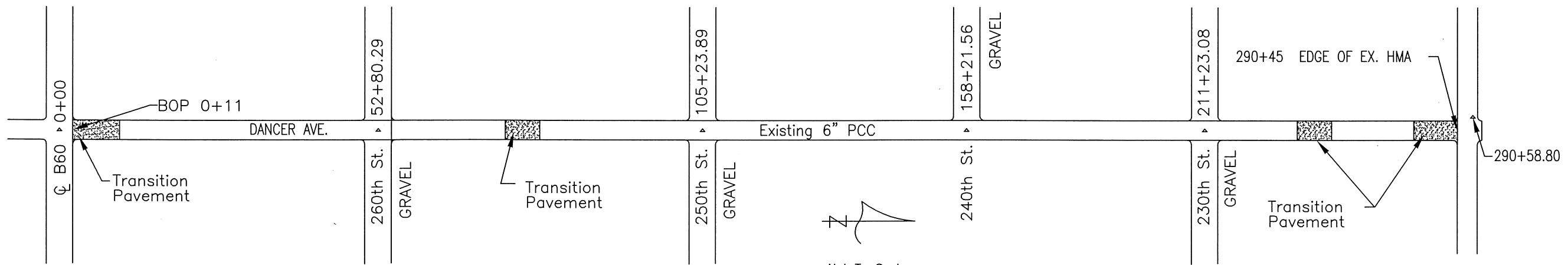

Not To Scale