

End.

# Township N<sup>o</sup> 89. 1; Range N<sup>o</sup> 27 West 5<sup>th</sup> Mer.

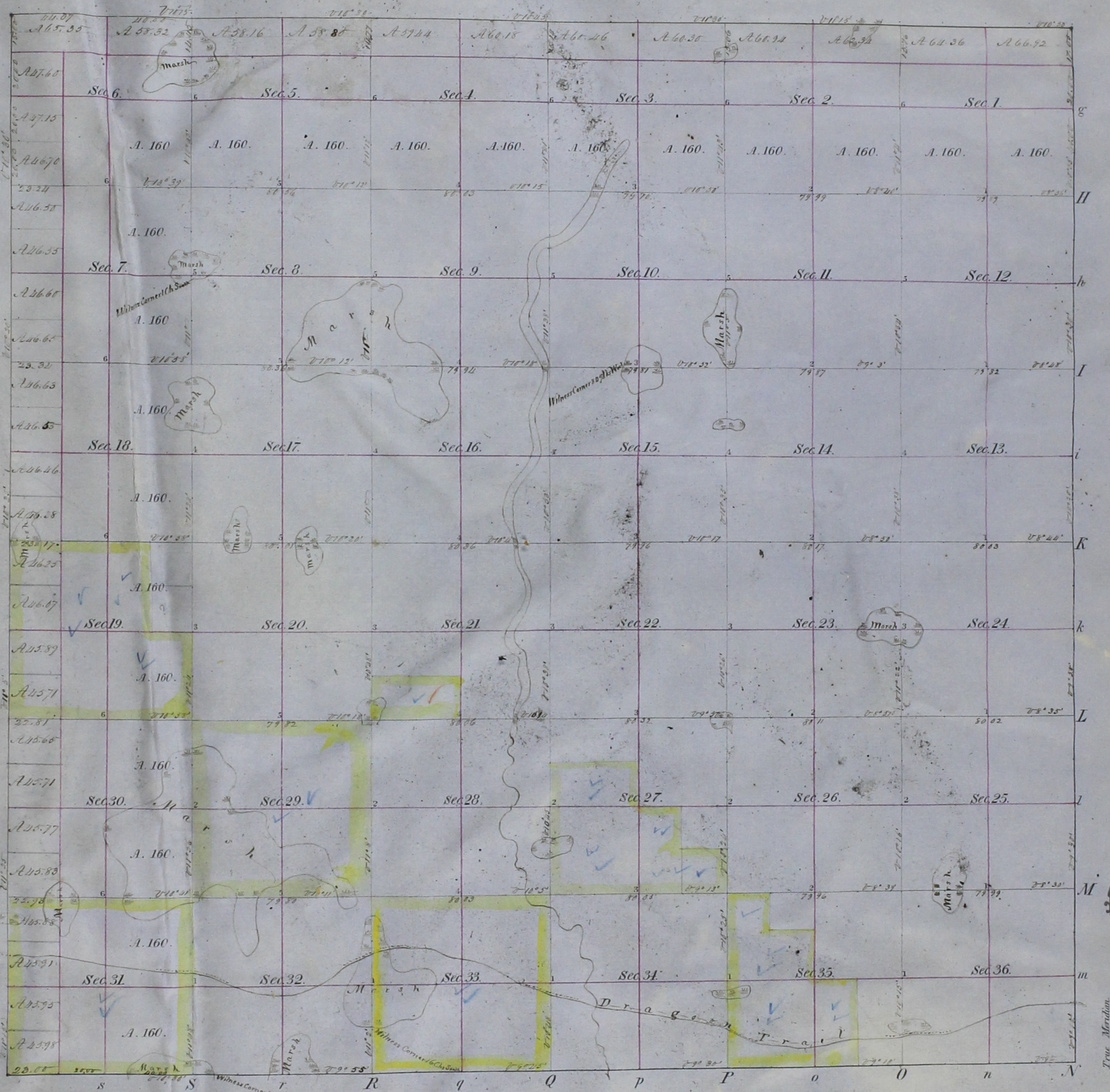

Surveyed in 1851 by W. Williams Deputy Surveyor.

I certify that the above plat has been compared with the original in this office and is correct.

Wm. Lewis  
Sur. Gen.

I certify that the above is a true copy of the original plat in this Office.  
Surveyor General's Office.  
Dec 8<sup>th</sup> 1857

George B. Sargent  
Sur. Gen.

Scale, 40 chains to an Inch.