

Township N<sup>o</sup> 87N, Range N<sup>o</sup> 28 West 5<sup>th</sup> Mer. *White*

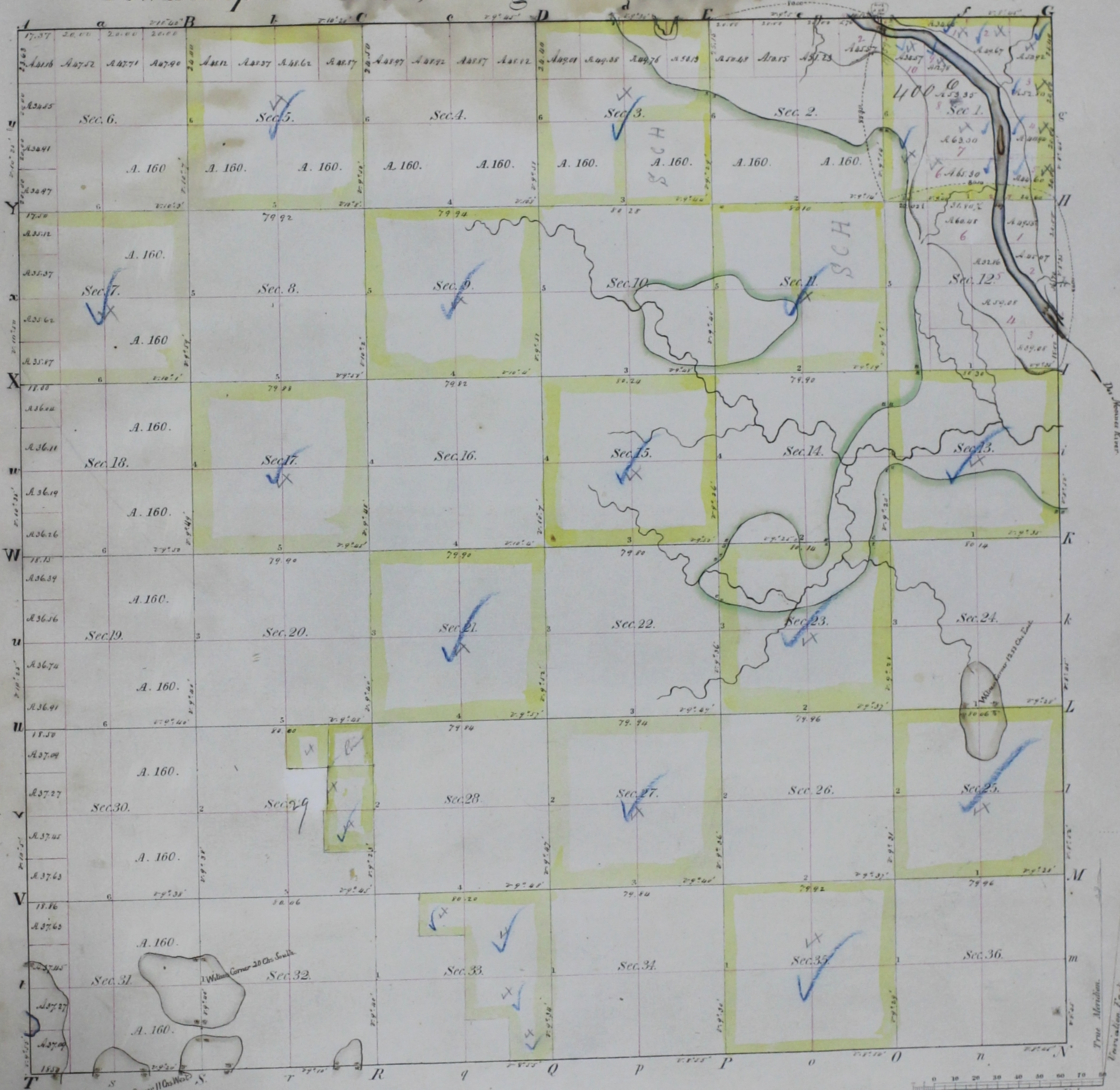

Surveyed in 1849 by *E. J. Norris* Deputy Surveyor.

I certify that the above is a true copy of the Original plot in this office.  
*C. H. Booth*  
 Surveyor General's Office,  
 St. Louis, Mo. 1<sup>st</sup> 1850.  
 Sur. Genl