

Township N^o 86 N, Range N^o 28 West 5th Mer.

Robertson Can

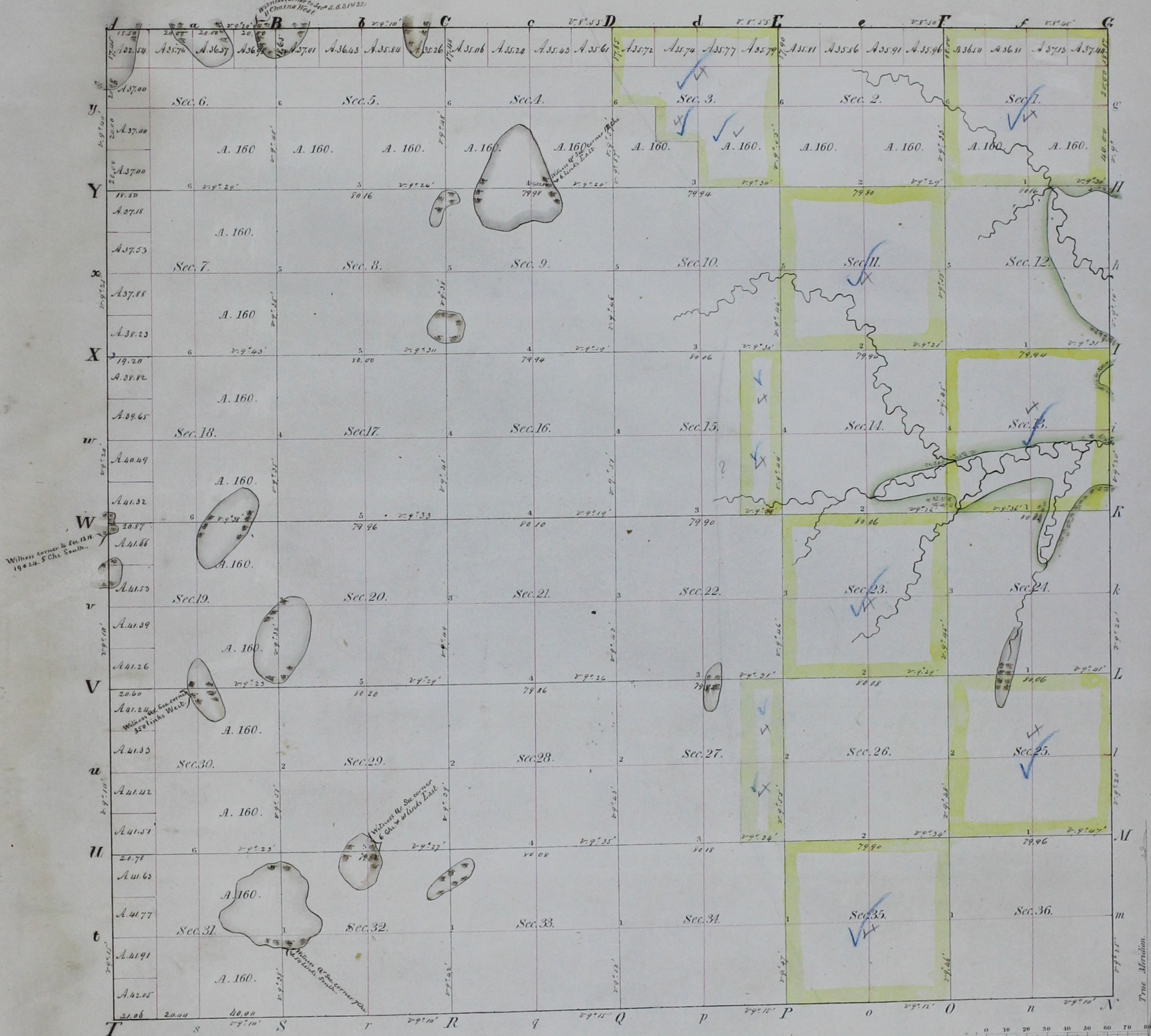

Surveyed in 1849 by *C. J. Norris* Deputy Surveyor.

I certify that the above is a true copy of the Original plot in this Office.

Surveyor General's Office,
Dubuque May 1st 1850

C. H. Booth

Sur. Genl.