

A d d e n d u m

Iowa Department of Transportation
Office of Contracts

Date of Letting: March 19, 2013
Date of Addendum: March 14, 2013

B.O.	Proposal ID	Proposal Work Type	County	Project Number	Addendum
102	07-0636-089-A	PCC PAVEMENT - GRADE & REPLACE	BLACK HAWK	NHSX-063-6(89)--3H-07 CS-3577(605)--84-07	19MAR102.A08

Notice: Only the bid proposal holders receive this addendum and responsibility for notifying any potential subcontractors or suppliers remains with the proposal holder.

Make the following changes to the PROPOSAL SCHEDULE OF PRICES:

Change Proposal Line No. 0080 2122-5190007 PAVED SHOULDER, P.C. CONCRETE, 7 IN.:
From: 31,129.000 SY
To: 27,870.000 SY

Change Proposal Line No. 0140 2301-1003095 STANDARD OR SLIP-FORM PORTLAND
CEMENT CONCRETE PAVEMENT, QM-C, CLASS 3 DURABILITY, 9.5 IN.:
From: 103,630.000 SY
To: 107,035.000 SY

Change Proposal Line No. 0180 2301-9090000 QUALITY MANAGEMENT - CONCRETE
(QM-C):
From: 28,834.000 CY
To: 34,311.000 CY

If the above changes are not made, they will be made as shown here.

Make the following change to the Plans for Project No. NHSX-063-6(89)--3H-07:

Delete the Plan Sheets B.1, B.2, B.3, C.18, L.5, L.6, L.7, L.8, and L.9 and replace with the
attached Plan Sheets B.1, B.2, B.3, C.18, L.5, L.6, L.7, L.8, and L.9.

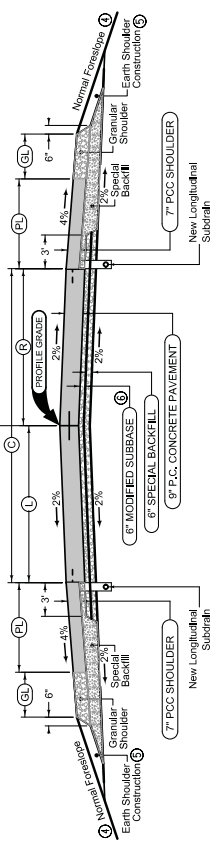

- Notes:**
- ① See E, L and X Sheets for additional information.
 - ② **Mainline Jointing:**
 Transverse Joints: 20' spacing
 Longitudinal Joints: 11-2'
 - ③ **PCC Shoulder Jointing:**
 Longitudinal Joints: 30' spacing or 81-5'
 Transverse Joints: 30' spacing or 81-5'
 Tie bars spaced at 3.5' centers.
 - ④ **Transverse Joints:** Match joint locations in adjacent pavement.
 - ⑤ Class 13, Embankment will be needed. Not a bid item.
 - ⑥ Normal foreslope shall match or be flatter than existing Earth Shoulder Finishing. In areas of new construction the foreslope shall be 4:1 to 6:1.
 - ⑦ Nominal 8 inches of topsoil shall be placed for Earth Shoulder Construction.
 - ⑧ No crushed composite pavement or salvaged RMA (RAP) will be allowed in the modified subbase. If recycled PCC concrete is used for modified subbase, the Contractor will not be permitted to drive on it. If virgin material is used for modified subbase, the Contractor will be permitted to drive on it.

TABLE OF DESIGN QUANTITIES (unless noted)

LOCATION	Per Station (unless noted)											#Quantities Per Station Range	REMARKS			
	STATION TO	LANE	C	L	R	FL	FR	GL	GR	CLASS 13, EMBANKMENT	MODIFIED SUBBASE			MAINLINE PAVEMENT	SPECIAL BACKFILL	SHOULDER PAVEMENT
STATION TO	LANE	Feet	Feet	Feet	Feet	Feet	Feet	Feet	Feet	Cu. Yds.	Cu. Yds.	Sq. Yds.	Cu. Yds.	Sq. Yds.	Tons	
MAINLINE	IA 58															
1573226.6	80TH	VAR.	VAR.	VAR.	VAR.	VAR.	VAR.	VAR.	VAR.	149*	813*	149*				INTERSECTION
1573226.7	80TH	36	22	14	14	14	14	14	14	79.7	400.1	79.7				
1573273	80TH	36-28	22-14	14	14	14	14	14	14	184*	908*	184*				
SHOULDERS	IA 58															
1572228.8	80TH				4	4	2	2	2	39.4	141*	39.4		141*	18.3	INTERSECTION
1572228.9	80TH				4	4	2	2	2	39.4	196*	39.4		196*	18.3	
1575445	80TH				4	4	2	2	2	39.4	89.0	39.4		89.0	18.3	
1575445	80TH															

**TYPICAL CROSS SECTION
PCC PAVEMENT
IA 58**

TABULATION OF PAVEMENT

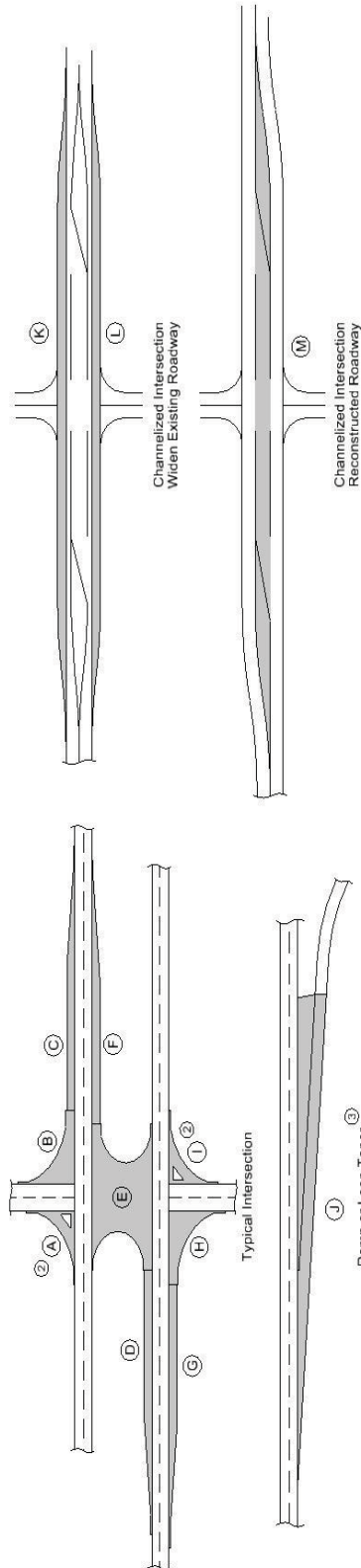

- ① Quantity includes Pavement Header.
- ② Does not include Island area.
- ③ Refer to PV-410, PV-411, PV-412, and PV-414.

Road Identification	Station to Station		Length FT	Area SY	Area (1)													Total Area By Pavement Thickness SY	Remarks
	Location				Area (2)														
	FT	SY			A	B	C	D	E	F	G	H	I	J	K	L	M		
US 63	553+86.64	581+99.82	2833.2														3931.7	Refer to D sheets	
IA 58	1572+28.75	1573+28.70	100.0	302.2	113.3												415.5	42.3 LE of 4" sloped curb	
US 63 and Wood Street	588+71.56	589+66.56		85.6	42.8												85.6	Refer to sheet L-5	
US 63 and Schrock Rd.	589+09.56	590+80.56		154.0													154.0	Refer to sheet L-5	
US 63 and 3rd Street West	608+00.00	609+40.00		101.4	50.7												101.4	Refer to sheet L-5	
US 63 and 3rd Street East	608+00.00	609+40.00		70.0													70.0	Refer to sheet L-5	
US 63 and East Eldora Rd.	624+30.00	624+35.03		298.9		298.9											298.9	Refer to sheet L-6	
US 63 and Waterloo Rd.	623+70.00	625+33.13		143.0													143.0	Refer to sheet L-6	
US 63 and Waterloo Rd.	625+33.13	630+22.70		577.2													577.2	Refer to sheet L-6	
US 63 and Eddystone Dr. W.	647+00.00	649+20.00		115.6	57.8												115.6	Refer to sheet L-7	
US 63 and Eddystone Dr. E.	647+00.00	649+20.00		115.6	57.8												115.6	Refer to sheet L-7	
US 63 and West Shaulis Rd.	773+20.00	776+30.00		309.2	154.6												309.2	Refer to sheet L-7	
US 63 and East Shaulis Rd.	774+40.00	776+80.00		254.8	154.6												254.8	Refer to sheet L-7	
US 63 and Southland Dr.	797+00.00	799+00.00		169.0													169.0	Refer to sheet L-7	
US 63, 2 Lane to 4 Lane	814+10.00	818+50.00		677.1													677.1	Refer to sheet L-8	
US 63, 2 Lane to 4 Lane	818+50.00	820+40.00		204.5													204.5	Refer to sheet L-8	
US 63, Ranchoero Rd. West	827+90.00	829+10.00		102.2													102.2	Refer to sheet L-9	
US 63, Ranchoero Rd. East	827+90.00	829+30.00		120.0	51.1												120.0	Refer to sheet L-9	
US 63, NB Left Turn Lane	826+50.00	828+24.19		173.6		173.6											173.6	Refer to sheet L-9	
US 63, Median crossing	828+11.69	828+88.39		220.2		220.2											220.2	Refer to sheet L-9	
US 63, NB Right Turn Lane	836+87.00	838+97.00		213.3		213.3											213.3	Refer to sheet L-9	

NOTES (FOR L5 TO 6039)

All longitudinal joints shall be either KT-2 or L-2 unless indicated otherwise.
 All traverse joints shall be CD joints with a maximum 20' spacing unless indicated otherwise.
 If a joint length is 4', a C joint shall be used instead of a CD joint.
 Refer to Standard Road Plans for details of paved header, if applicable.
 Refer to Standard Road Plan PV-1 for additional details.
 Refer to Standard Road Plans for additional jointing details around physical features.

[pavement sections between shoulders at intersections, turn lanes and median crossings and the edge of public pavements.](#)

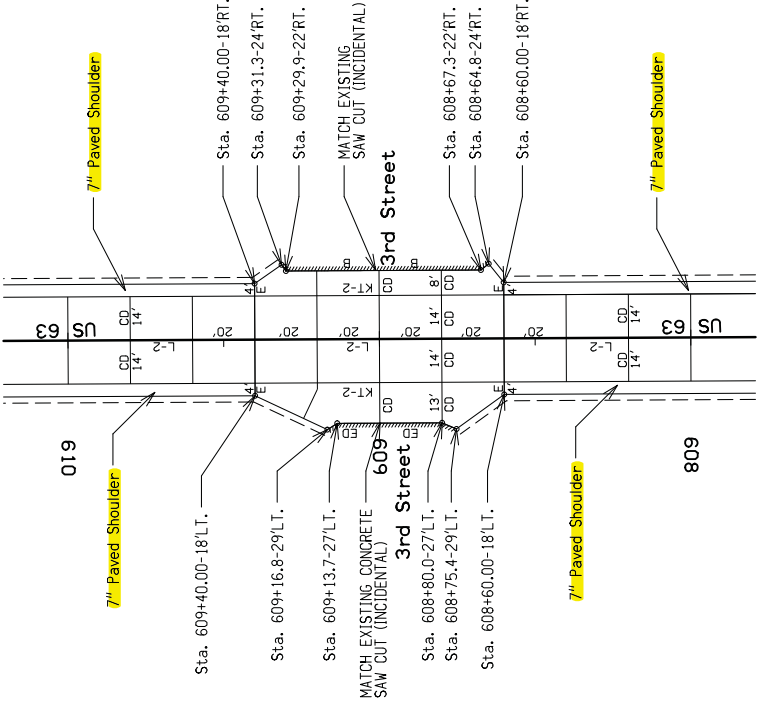
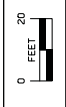
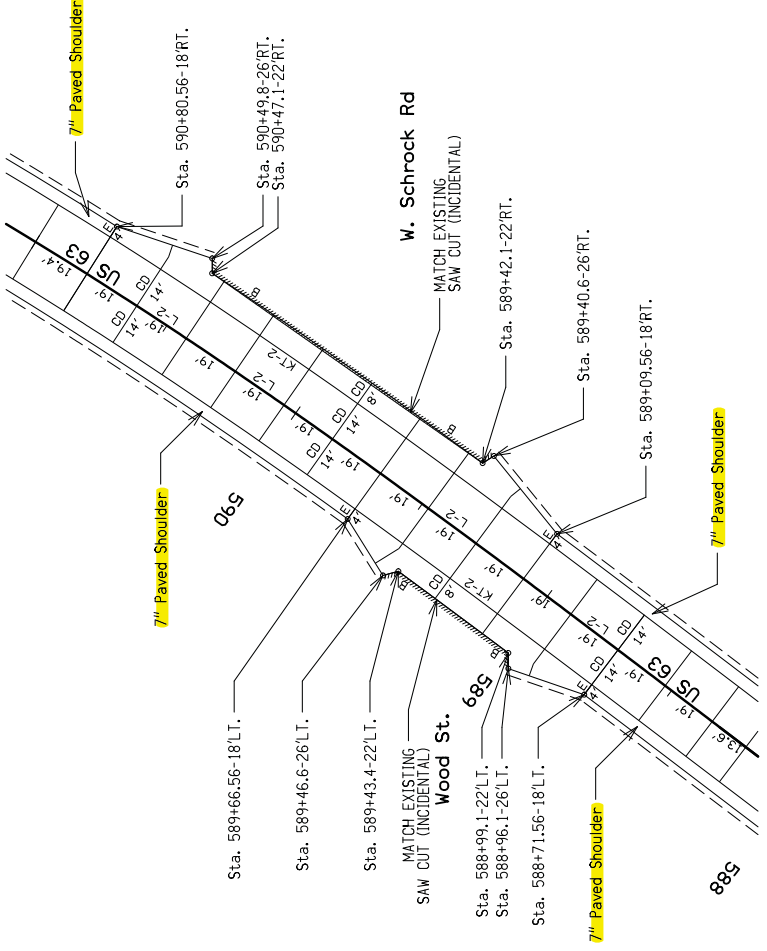

Jointing & Layout Details Intersection of US 63 & Wood St./W. Schrock Rd.

ENGLISH | DWA DOT | DESIGN TEAM | Callahan\Coggins\Suntken | PROJECT NUMBER | NHSX-063-6(89)-3H-07 | SHEET NUMBER | L-5

Jointing & Layout Details Intersection of US 63 & 3rd St.

PROJECT NUMBER | NHSX-063-6(89)-3H-07 | SHEET NUMBER | L-5

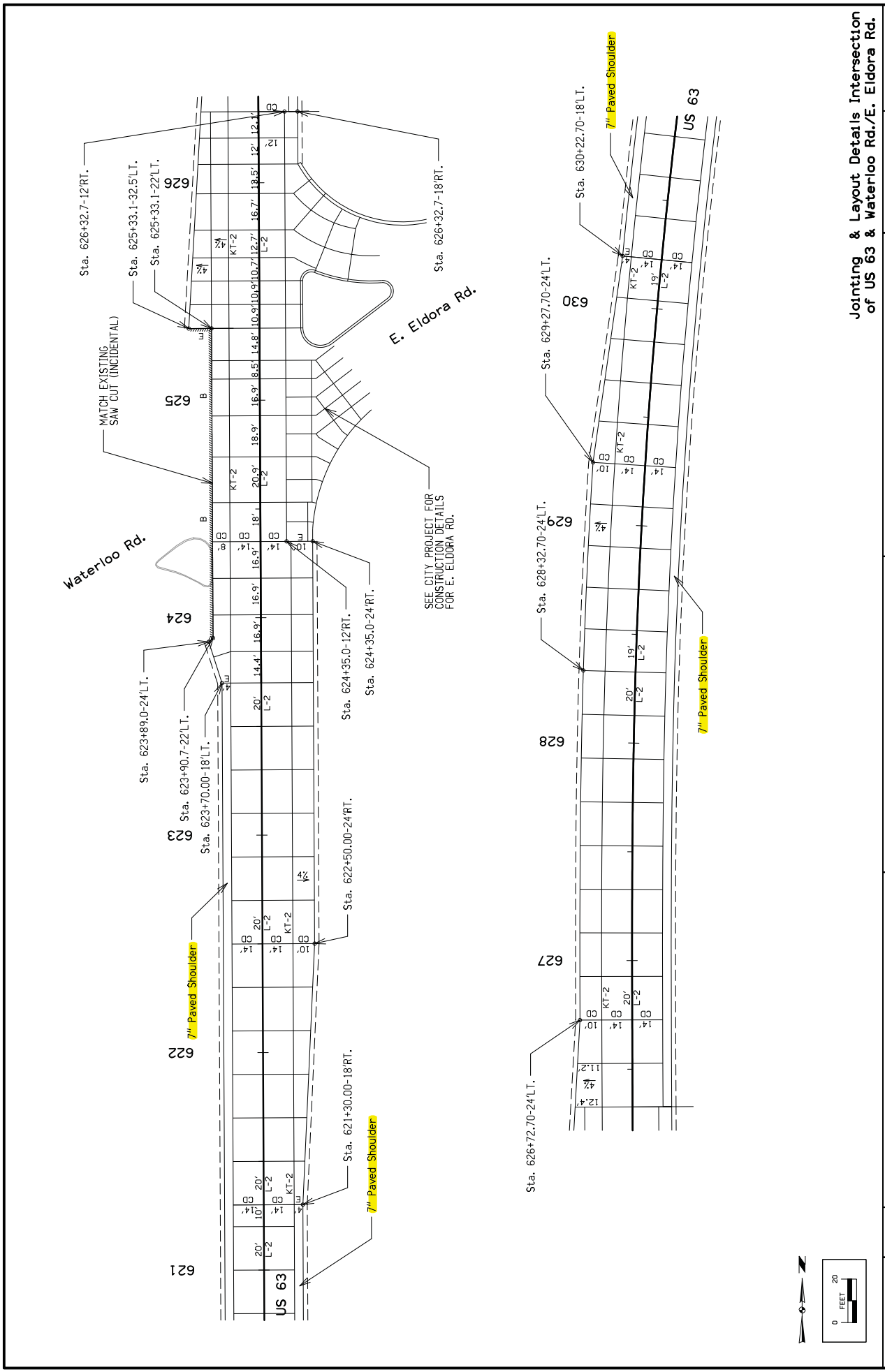

ENGLISH | IOWA DOT | DESIGN TEAM | **Callahan\Coggins\Suntken** | PROJECT NUMBER | **BLACK HAWK COUNTY** | **NHSX-063-6(89)-3H-07** | SHEET NUMBER | **L.6**

11:14:54 AM 3/14/2013 | bcoggins | W:\Projects\0706301012\01strict\design\0706308105.sht

**Jointing & Layout Details Intersection
 of US 63 & Waterloo Rd./E. Eldora Rd.**

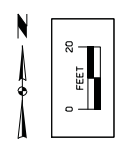

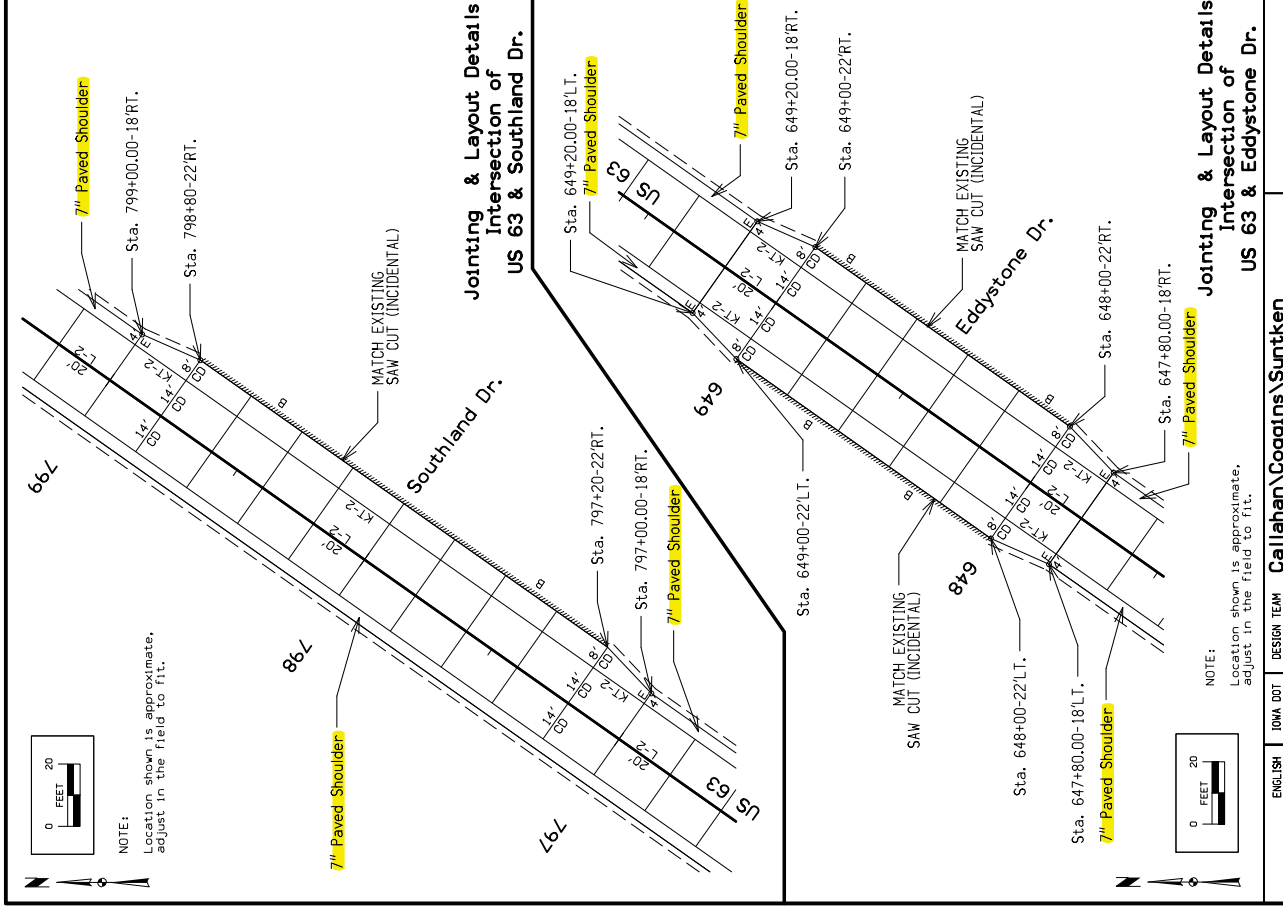
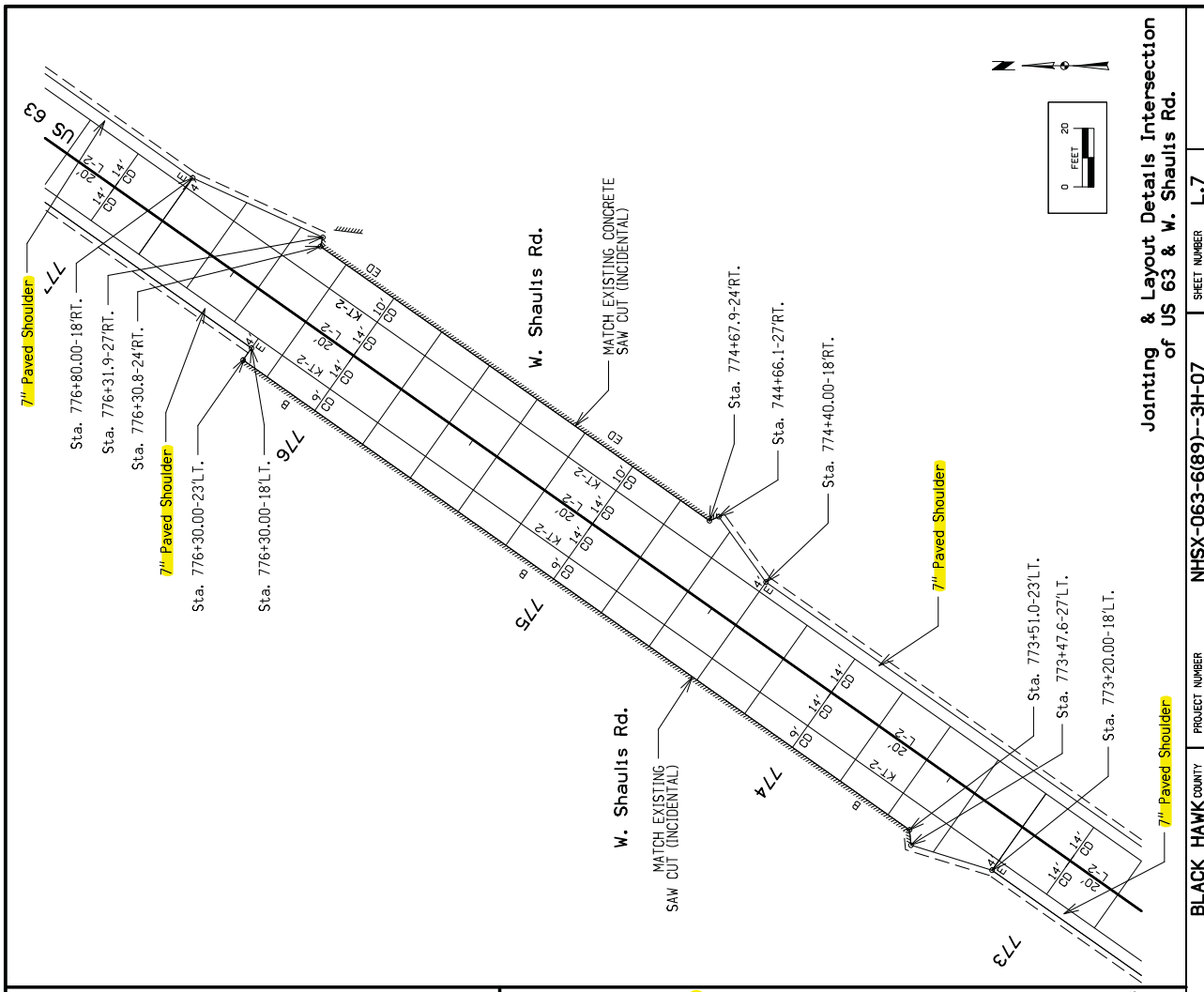

11:14:55 AM 3/14/2013 bccoggin W:\Projects\07063010\2\01\strict\design\0706308105.dwg

ENGLISH | DWG.DOT | DESIGN TEAM | Callahan\Coggins\Suntken | PROJECT NUMBER | NHX-063-6(89)-3H-07 | SHEET NUMBER | L-7

BLACK HAWK COUNTY

Jointing & Layout Details Intersection of US 63 & W. Shaulls Rd.

Jointing & Layout Details Intersection of US 63 & Southland Dr.

Jointing & Layout Details Intersection of US 63 & Eddystone Dr.

NOTE:
Location shown is approximate, adjust in the field to fit.

NOTE:
Location shown is approximate, adjust in the field to fit.

NOTE:
Location shown is approximate, adjust in the field to fit.

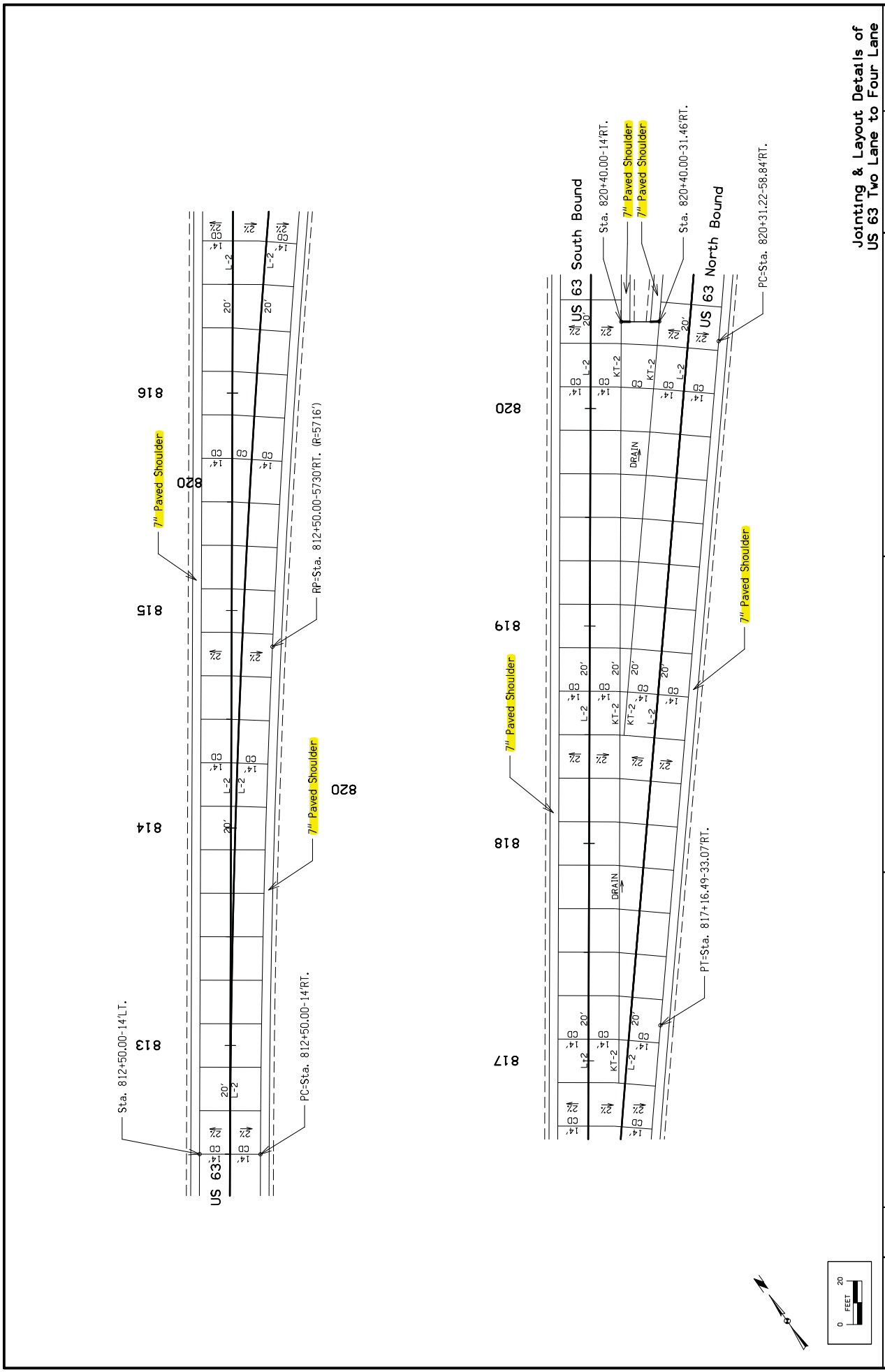

**Jointing & Layout Details of
 US 63 Two Lane to Four Lane**



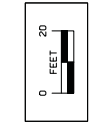
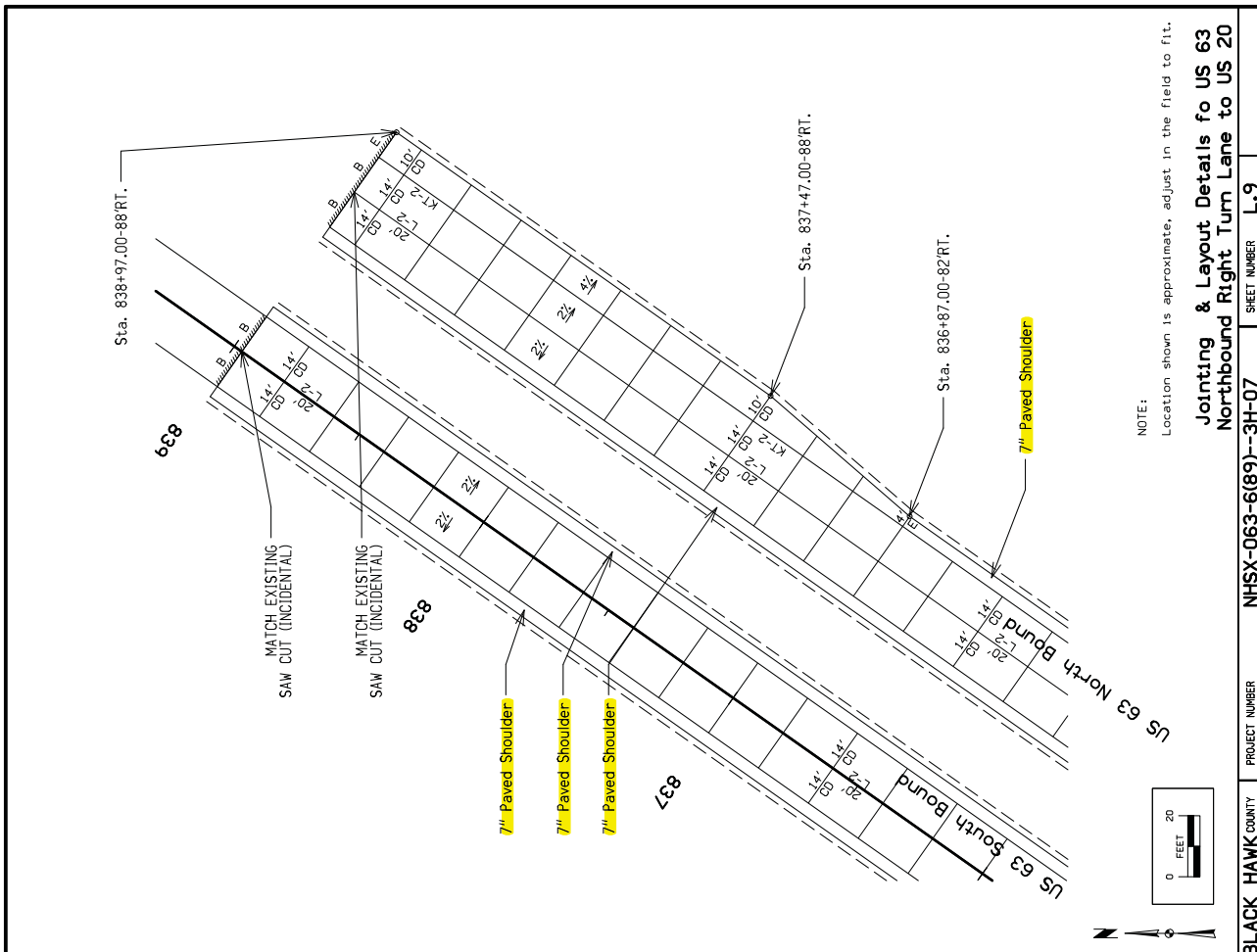

NOTE:
Location shown is approximate, adjust in the field to fit.

Jointing & Layout Details fo US 63 Northbound Right Turn Lane to US 20

SHEET NUMBER **L-9**

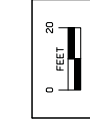
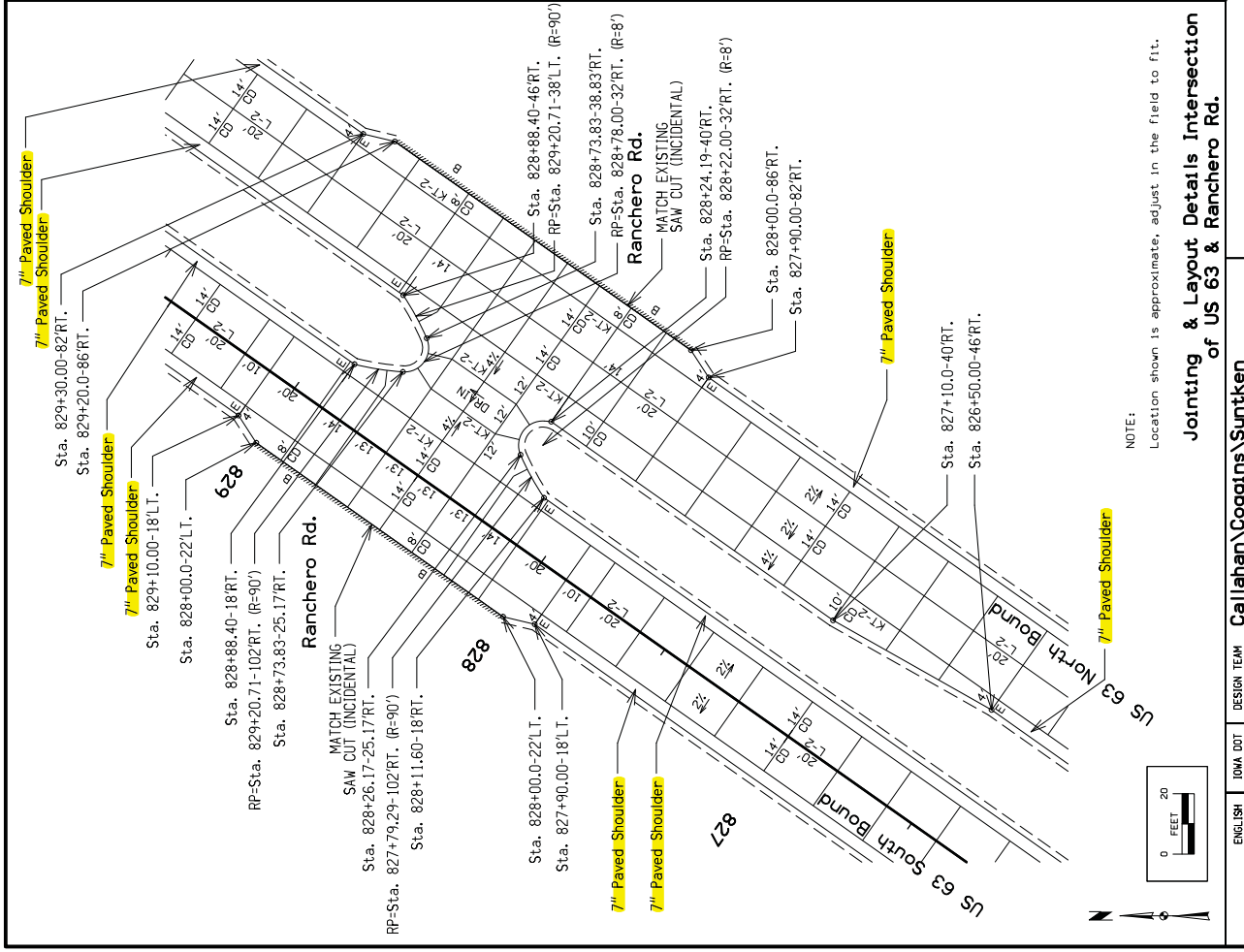

NOTE:
Location shown is approximate, adjust in the field to fit.

Jointing & Layout Details Intersection of US 63 & Rancho Rd.

PROJECT NUMBER **NHSX-063-6(89)-3H-07**

DESIGN TEAM **Callahan\Coggins\Suntken**

PROJECT NUMBER **L-9**

11:14:56 AM 3/14/2013 bccoggin W:\Projects\0706301012\01stricdesign\0706308105.sht