

A d d e n d u m

Iowa Department of Transportation
Office of Contracts

Date of Letting: September 18, 2012
Date of Addendum: August 28, 2012

B.O.	Proposal ID	Proposal Work Type	County	Project Number	Addendum
001	01-0802-220	Bridge New - Steel Girder	Adair	IMX-080-2(220)85--02-01	18sep001.a01

Notice: Only the bid proposal holders receive this addendum and responsibility for notifying any potential subcontractors or suppliers remains with the proposal holder.

Make the following change to the PROPOSAL section 0003:

From Section 0003 ALTERNATE AA - OPTION 1

To:

Section 0003 ALTERNATE 'AA' OPTION 1: PCC SHOULDER
BID THIS SECTION IF ALTERNATE 'AA' OPTION 1 IS CHOSEN
Alt Group AA1

Make the following change to the PROPOSAL section 0004:

From Section 0004 ALTERNATE AA - OPTION 2

To:

Section 0004 ALTERNATE 'AA' OPTION 2: HMA SHOULDERS
BID THIS SECTION IF ALTERNATE 'AA' OPTION 2 IS CHOSEN
Alt Group AA2

Make the following change to the plan:

Add the attached cross-section sheets.

I-80 EB

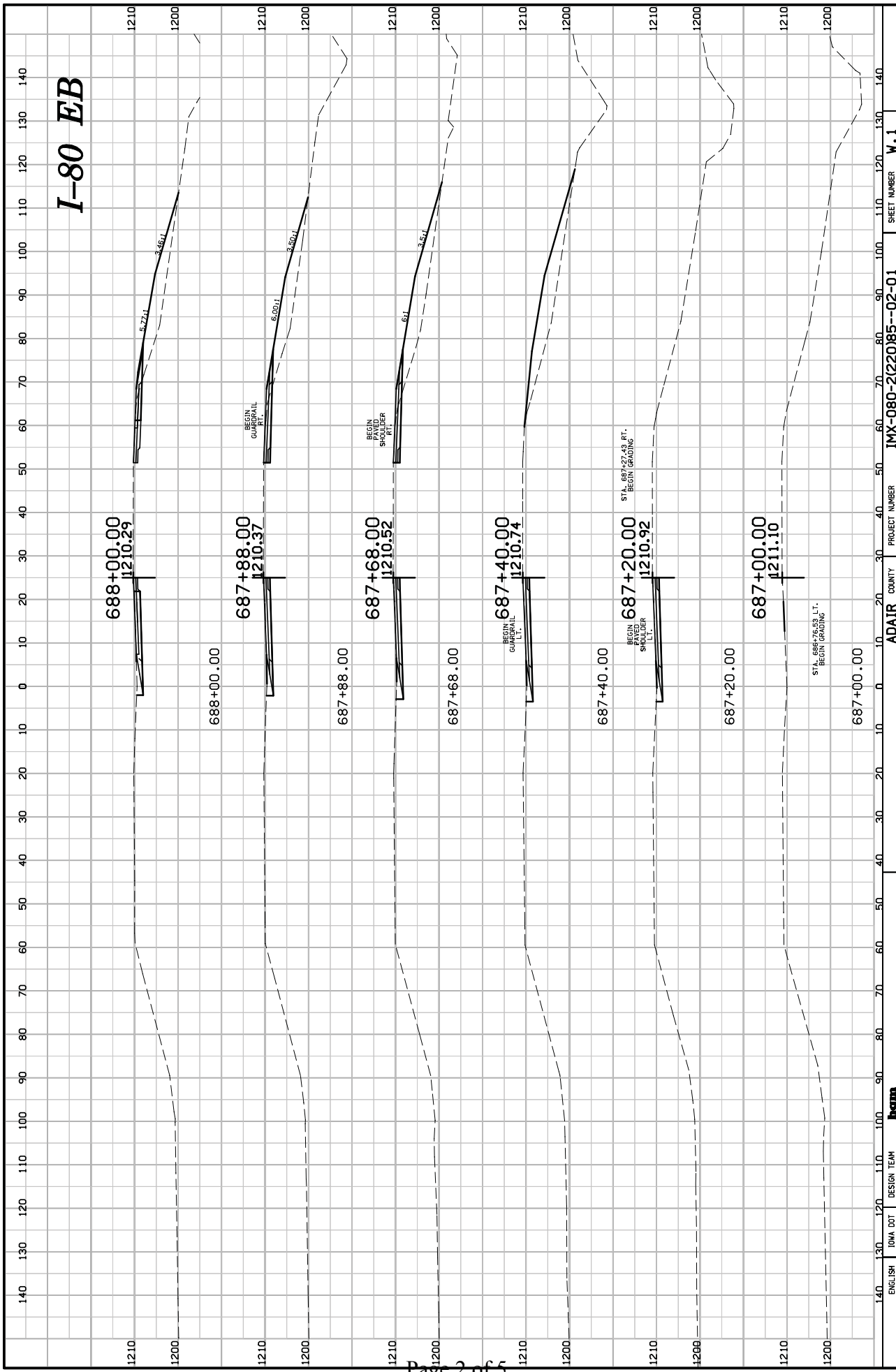

STATION	ELEVATION	DESCRIPTION
688+00.00	1210.29	BEGIN GRADE
687+88.00	1210.37	BEGIN GRADE
687+68.00	1210.52	BEGIN GRADE
687+40.00	1210.74	BEGIN GRADE
687+20.00	1210.92	BEGIN GRADE
687+00.00	1211.10	BEGIN GRADE

I-80 EB

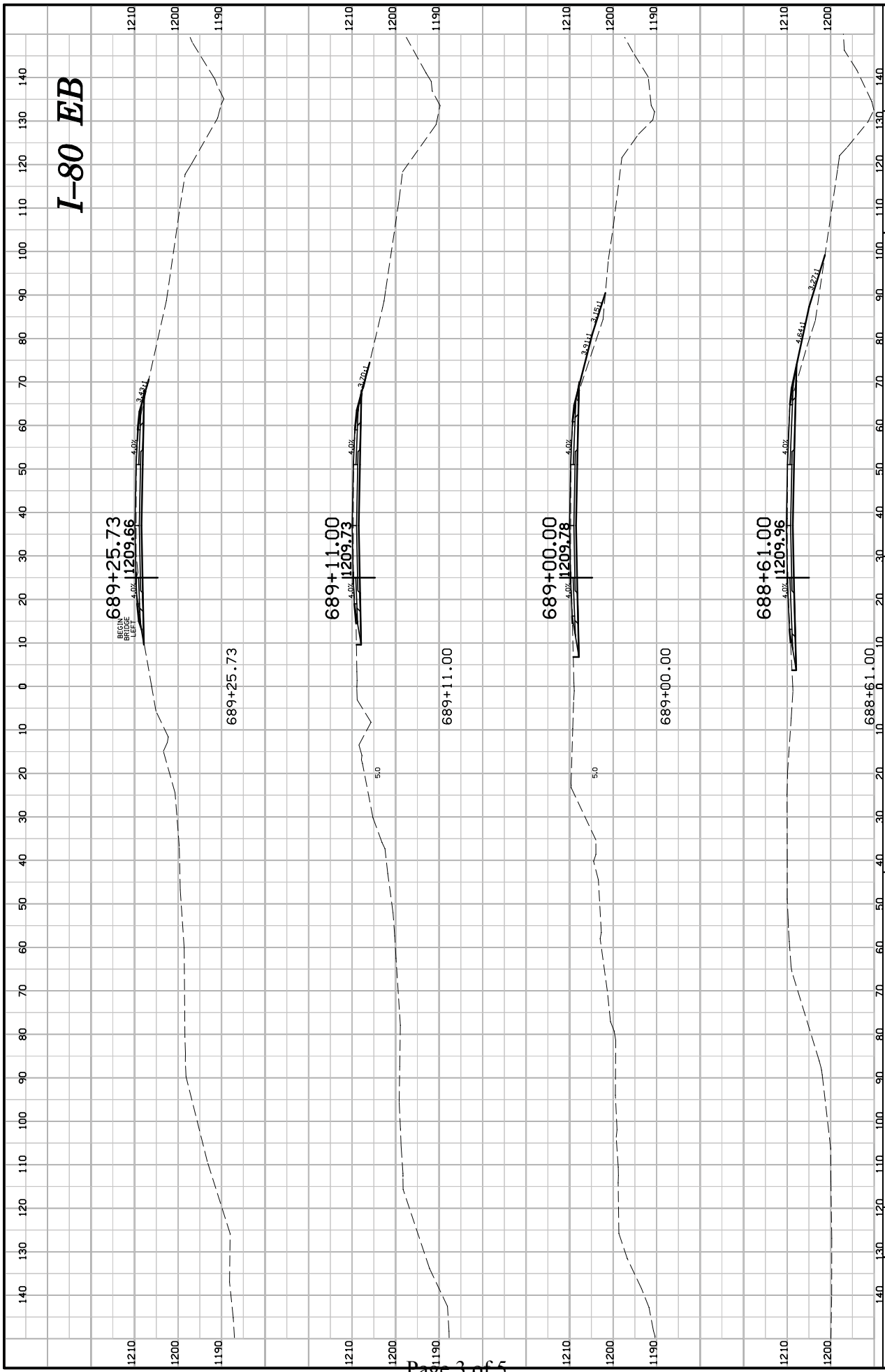

140	130	120	110	100	90	80	70	60	50	40	30	20	10	0	10	20	30	40	50	60	70	80	90	100	110	120	130	140		
1210	1210	1200	1200	1190	1190	1190	1190	1190	1190	1190	1190	1190	1190	1190	1190	1190	1190	1190	1190	1190	1190	1190	1190	1190	1190	1190	1190	1190		
															689+25.73															
															689+11.00															
															689+00.00															
															688+61.00															
															ADAIR															
															IMX-080-2(220)85-02-01															
															PROJECT NUMBER															
															ADAIR															
															COUNTY															
															ADAIR															
															PROJECT NUMBER															
															IMX-080-2(220)85-02-01															
															SHEET NUMBER															
															W.2															

I-80 EB

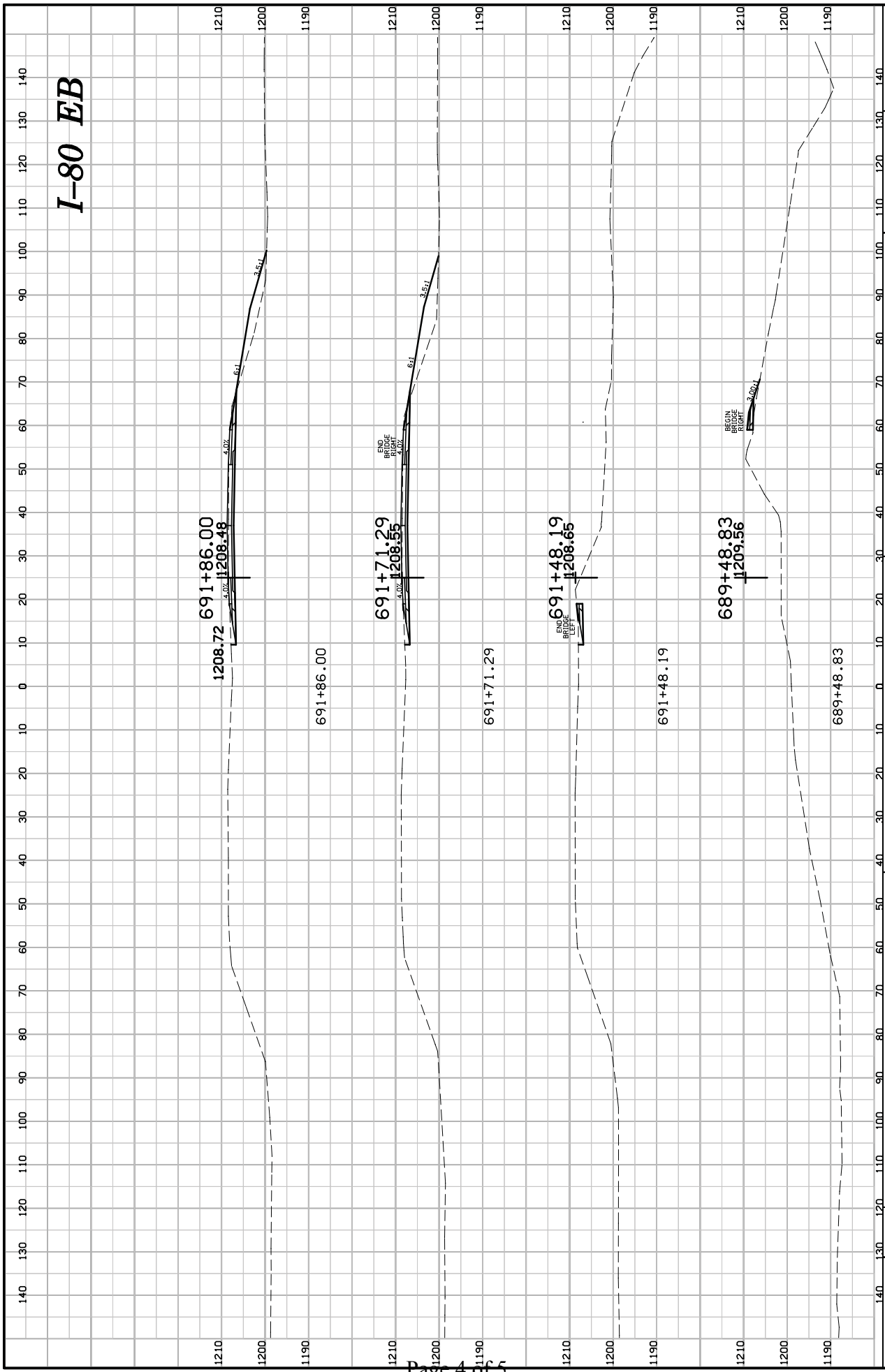

STATION	ELEVATION	DESCRIPTION
1208.72	1208.48	691+86.00
691+86.00		
691+71.29	1208.55	691+71.29
691+71.29		
691+48.19	1208.65	691+48.19
691+48.19		
689+48.83	1209.56	689+48.83
689+48.83		

S:\Projects\108002004\Design\Adair-EB\1080220W1.sht

I-80 EB

