

# A d d e n d u m

Iowa Department of Transportation  
Office of Contracts

Date of Letting: September 18, 2012  
Date of Addendum: August 24, 2012

<b>B.O.</b>	<b>Proposal ID</b>	<b>Proposal Work Type</b>	<b>County</b>	<b>Project Number</b>	<b>Addendum</b>
103	77-0805-275	PCC Pavement - Grade and New	Polk	IM-080-5(275)142--13-77 IM-080-5(277)142--13-77 IM-080-5(296)142--13-77 BRFIM-080-5(299)142--05-77	18sep103.a01

---

Notice: Only the bid proposal holders receive this addendum and responsibility for notifying any potential subcontractors or suppliers remains with the proposal holder.

---

The following applies to work on this contract:

The Contractor shall ensure areas (including haul roads and staging areas) selected for waste or disposal for excess material (excavated material or broken concrete) or borrow have been reviewed for:

- Culturally sensitive sites or graves; consult with the Office of the State Archaeologist as necessary.
- Wetlands or “Waters of the U.S.”, including streams or stream banks below the “ordinary high water mark”; obtain a U.S. Army Corps of Engineers Section 404 Permit as necessary.
- Threatened or endangered species; consult with Iowa DNR as necessary.
- Storm water; obtain an Iowa DNR storm water permit as necessary.
- Floodplain impacts; obtain an Iowa DNR floodplain permit as necessary.

The Contractor shall obtain necessary environmental clearances and permits and comply with all restrictions attached to these clearances and permits.

Excess material shall not be placed within the right-of-way unless specifically stated on the plans.

Make the following changes to the PROPOSAL SCHEDULE OF PRICES:

Change Line No. 0190 2301-9090000 QUALITY MANAGEMENT - CONCRETE (QM-C) from 394,058.600 CY to 39,058.600 CY.

Change Line No. 0240 2402-0425040 FLOODED BACKFILL from 30,580.600 CY to 343.200 CY.

If the quantities are not changed on the proposal form, the bid amount will be extended using the unit price times the correct quantities as shown here.

Make the following change to the plan: IM-080-5(275)142--13-77

Replace the attached 108-23A TRAFFIC CONTROL PLAN and the 108-26A STAGING NOTES on sheet J.1 with the attached 108-23A and 108-26A

Replace plan SHEET J.30 and J.31 with the attached plan sheets.

## TRAFFIC CONTROL PLAN

1. Traffic shall be maintained on I-80, US 65, US 6, and Hubbell Ave. at all times, except as noted below.

2. Two lanes of traffic shall be maintained on I-80 at all times except as noted in Notes 3 & 4.

3. Night time work will only be allowed on I-80 for the strengthening of the eastbound shoulder; and removal of the existing median crossovers, and construction of the new crossover. Work will only be allowed from 9:00pm on Sunday to 6:00am on Monday, and from 8:00pm to 6:00am Monday through Thursday, beginning at 9:00pm on Sunday and ending at 6:00am on Friday.

On each allowed work day, no traffic control devices shall be placed before 9:00pm on Sunday or 8:00pm on Monday through Thursday. All traffic control devices shall be removed before 6:00am each working day.

4. US 65/Hubbell Ave will be closed and detoured at night for the removal of the existing westbound and eastbound bridges.

Night time closures for the removal will only be allowed from 11:00pm to 5:00am Sunday nights through Friday mornings. The Contractor shall notify the Engineer at least 72 hours in advance.

The IDOT will be responsible for signing the detour during the closure for the removal of the westbound I-80 bridge.

5. Short term night closures on US 65/Hubbell Ave will be allowed for the setting of bridge beams on the new westbound I-80 bridge from 11:00pm to 5:00am Sunday nights through Friday mornings. The Contractor shall notify the Engineer at least 72 hours in advance.

6. Lane closures on Hubbell Ave will not be allowed from 7:00am to 9:00am and from 3:00pm to 6:00pm.

7. Traffic control on this project shall be in accordance with Standard Road Plans listed in Tab. 104-5 in the C Sheets and the J Sheets in this plan. For additional complimentary information refer to Part 6 of the Manual on Uniform Traffic Control Devices and to the current Standard Specifications.

**STAGING NOTES****2013 Construction Season****STAGE 1A:**

All traffic to remain on existing lanes, with inside night lane closures on EB & WB I-80.

Construct 12' strengthened EB median shoulder from Sta. 1319+14 (ML080EB) to Sta. 1379+00 (ML080).  
Remove existing median crossovers at Sta. 1368+00 and 1382+00; construct new median crossover at Sta. 1368+00.

**STAGE 1B:**

WB I-80 traffic to remain on the existing WB lanes.  
EB I-80 traffic to be reduced to two lanes from Sta. 1255+50 (ML080) to Sta. 1303+60 (ML080EB) with outside lane closure.  
US 65 NB to EB I-80 Ramp closed and detoured.  
All other traffic to remain on existing lanes.

Construct new US 65 NB to I-80 EB ramp taper from Sta. 1257+25 to 1273+23.82. Resurface ramp pavement to match new taper. No work may begin on Stage 1C until the US65 NB to EB I-80 ramp is open to traffic.

**STAGE 1C:**

WB I-80 traffic to remain on the existing WB lanes.  
EB I-80 traffic to be reduced to two lanes from Sta. 1255+50 (ML080) to Sta. 1303+60 (ML080EB) with outside lane closure; and shifted 6' left on to strengthened median shoulder from Sta. 1319+14 (ML080EB) to 1379+00 (ML080).  
US 65 NB to EB I-80 Ramp open to thru traffic.  
All other traffic to remain on existing lanes.

Construct EB widening from Sta. 1273+23.82 (ML080) to Sta. 1301+88.4 (ML080EB); and Sta. 1330+55.5 (ML080EB) to Sta. 1373+93.6 (ML080).  
Remove concrete median barrier from Sta. 1263+90 to 1267+85.  
Begin grading Hubbell Ave. ramps A and C.

**STAGE 2:**

WB I-80 traffic to remain on the existing WB lanes.  
EB I-80 traffic to be reduced to two lanes from Sta. 1245+05 (ML080) to Sta. 1303+60 (ML080EB) with inside lane closure and shifted right on to new widening; and shifted on to new widening from Sta. 1319+14 (ML080EB) to 1379+00 (ML080).  
All other traffic to remain on existing lanes.

Install sheet pile wall on EB I-80 from Sta. 1302+00 to 1306+00  
Grade and pave new EB pavement from Sta. 1296+00 to Sta. 1342+50.  
Construct new EB bridge approaches.  
Complete grading on Hubbell Ave. Ramps A and C.

**2014 Construction Season****STAGE 3:**

WB I-80 traffic to be shifted on to new EB lanes from Sta. 1261+55 to 1373+10. Maintain two lanes of traffic through construction area.  
EB I-80 traffic to remain shifted right on to new widening.  
Hubbell Ave. Ramps A & C closed and detoured during Stage 3B and Stage 3C.  
All other traffic to remain on existing lanes.

Remove existing WB I-80 bridge at Hubbell Ave.  
Construct new WB I-80 bridge and bridge approaches.  
Remove existing Ramps A & C after completion of Stages 3A, 3B, and 3C.

**Stage 3A:**

Pave Hubbell Ave. median crossing for Ramp A, and proposed Ramps A & C.

**Stage 3B:**

Grade and pave WB lanes from Sta. 1337+09 to 1341+25 (including ramp taper connection) as shown on Sheets J.32 & J.33.

**Stage 3C:**

Grade and pave WB lanes from Sta. 1303+50 to 1306+50 (including ramp taper connection) as shown on Sheet J.30.

**STAGE 4:**

WB & EB I-80 traffic to remain in Stage 3 lanes.  
Hubbell Ave. Ramps A & C open to thru traffic.  
Hubbell Ave. NB to I-80 WB traffic (Ramp C) on detour by IDOT.  
All other traffic to remain on existing lanes

Grade and pave WB I-80 widening to outside from Sta. 1236+20 to 1282+00; 1364+75 to 1369+15.  
Grade and pave new WB pavement from Sta. 1282+00 to 1303+50; Sta. 1306+50 to 1337+09; Sta. 1341+25 to 1364+75.  
Grade and pave Hubbell Ave. Loop E

**STAGE 5:**

WB I-80 traffic placed on new WB lanes.  
EB I-80 traffic placed on new EB lanes (two lanes).  
Hubbell Ave Loop E open to thru traffic.  
All other traffic to remain on existing lanes.

Remove existing EB I-80 bridge.  
Remove existing EB I-80 from Sta. 1305+90 to Sta. 1324+50.  
Grade remaining portion of the EB I-80 foreslopes and ditches.

**STAGE 6:**

WB & EB I-80 traffic to remain in Stage 5 lanes.  
All other traffic to remain on existing lanes.

Remove TBR along finished slopes.



DELAWARE TWP.  
T-79N R-23W  
SEC. 11

1295

1300

1305

1310

CHWB

CHY8

ELY4

BLW4

ELY4

WB 1-80

EB 1-80

840' Shift

Ramp B

Proposed Ramp C



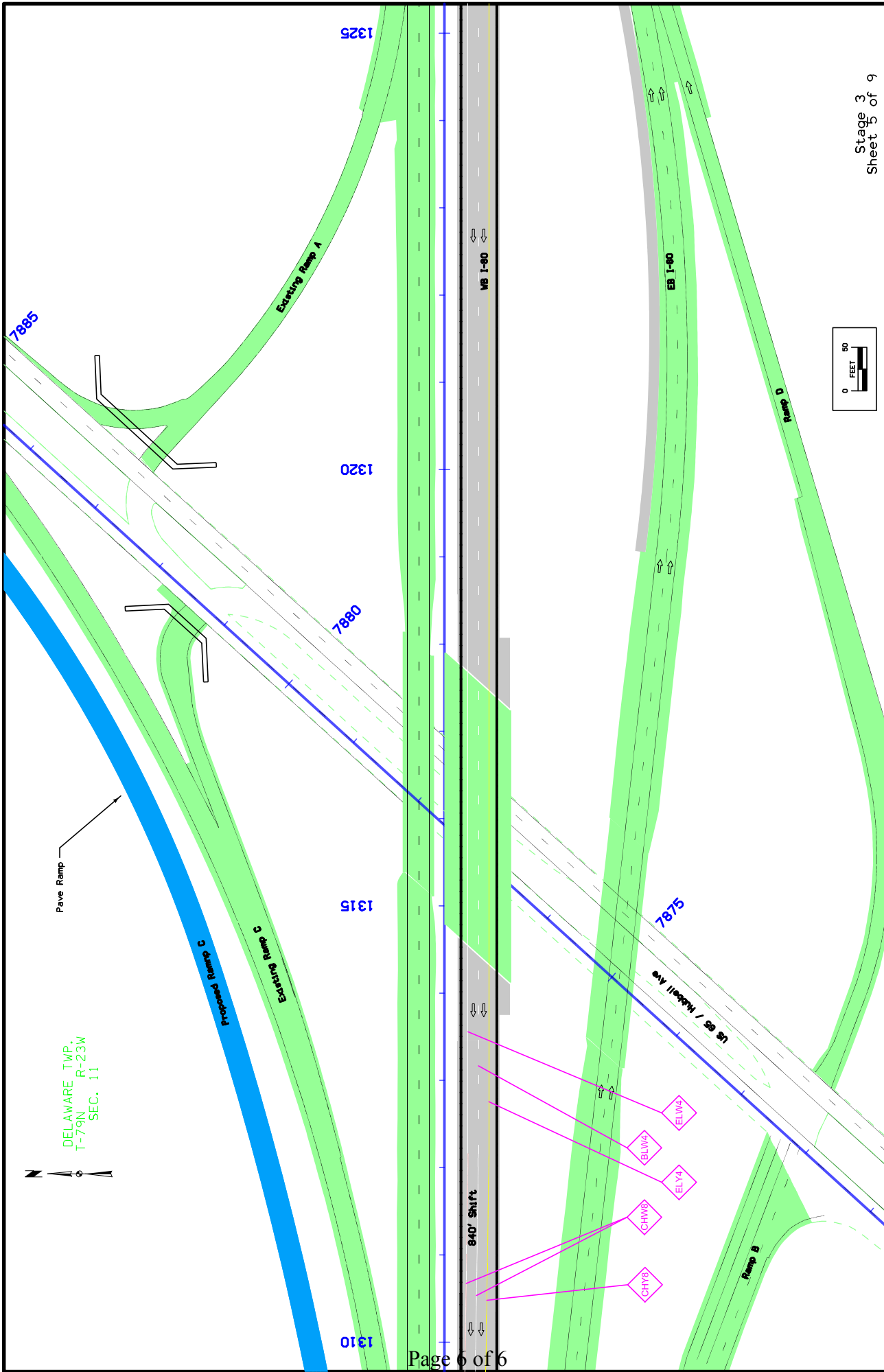

DELAWARE TWP.  
T-79N R-23W  
SEC. 11

Pave Ramp

Existing Ramp A

Proposed Ramp C

Existing Ramp B

Ramp D

US 58 / Kibben Ave

WB I-90

EB I-90

840' Shift

CHY3

CHY4

ELW3

ELW4



Stage 3  
Sheet 5 of 9

SHEET NUMBER

PROJECT NUMBER

POLK COUNTY

DESIGN TEAM

ENGLISH

7/25/2012

egensen

W:\Projects\77080160894\DESIGN\275) Grade and Pave\7708027527.sht

FlatteryGansen

IM-080-5(275)142--13-77

J.31