

A d d e n d u m

Iowa Department of Transportation
Office of Contracts

Date of Letting: March 20, 2012
Date of Addendum: February 29, 2012

B.O.	Proposal ID	Proposal Work Type	County	Project Number	Addendum
981	50-0801-706	Revetment	Jasper	MPIN-080-1(706)180--0N-50	20mar981.a01

Notice: Only the bid proposal holders receive this addendum and responsibility for notifying any potential subcontractors or suppliers remains with the proposal holder.

Make the following additions to the plan:

Add the attached 24 Sheets of Cross- Sections.

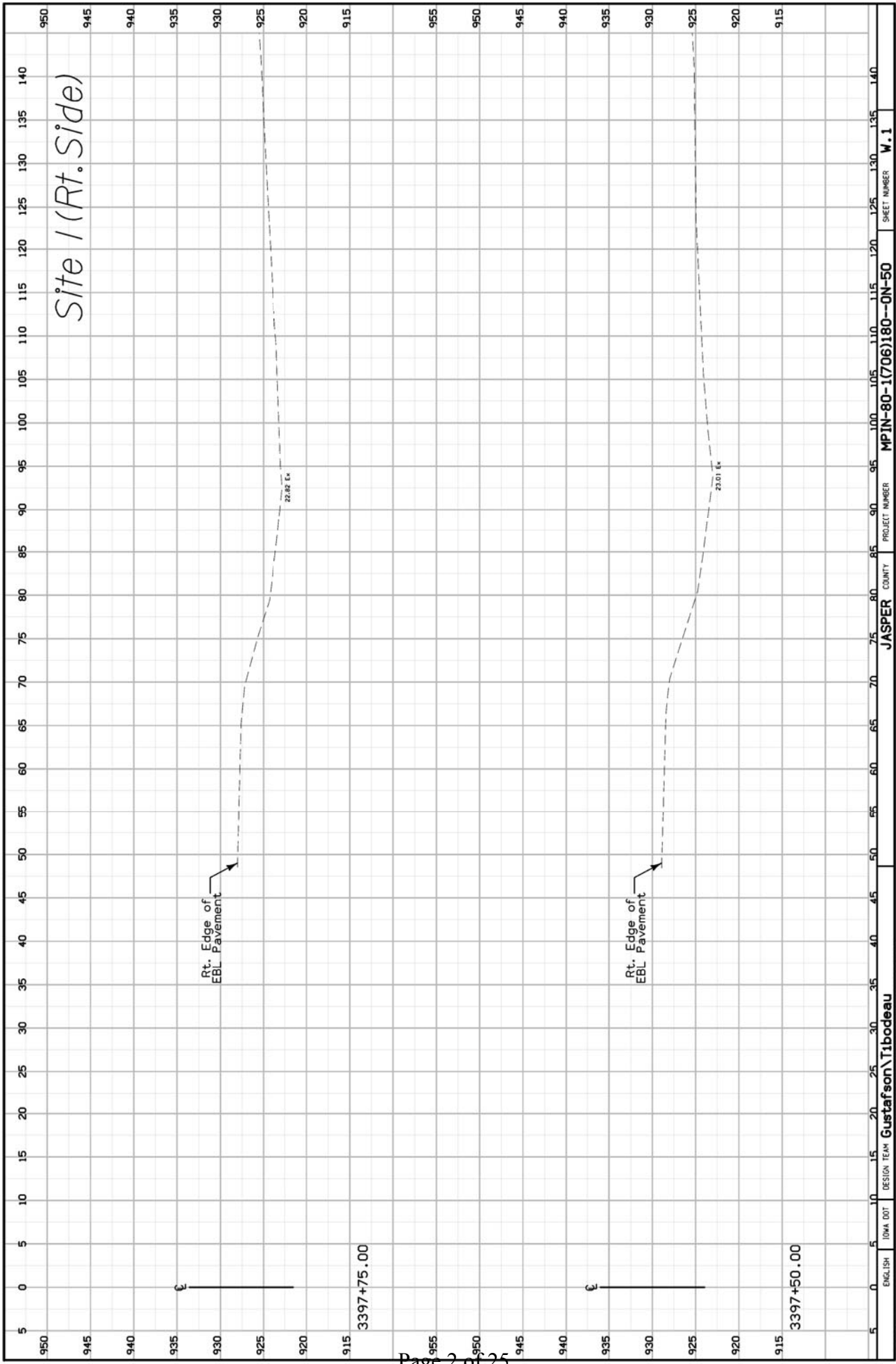

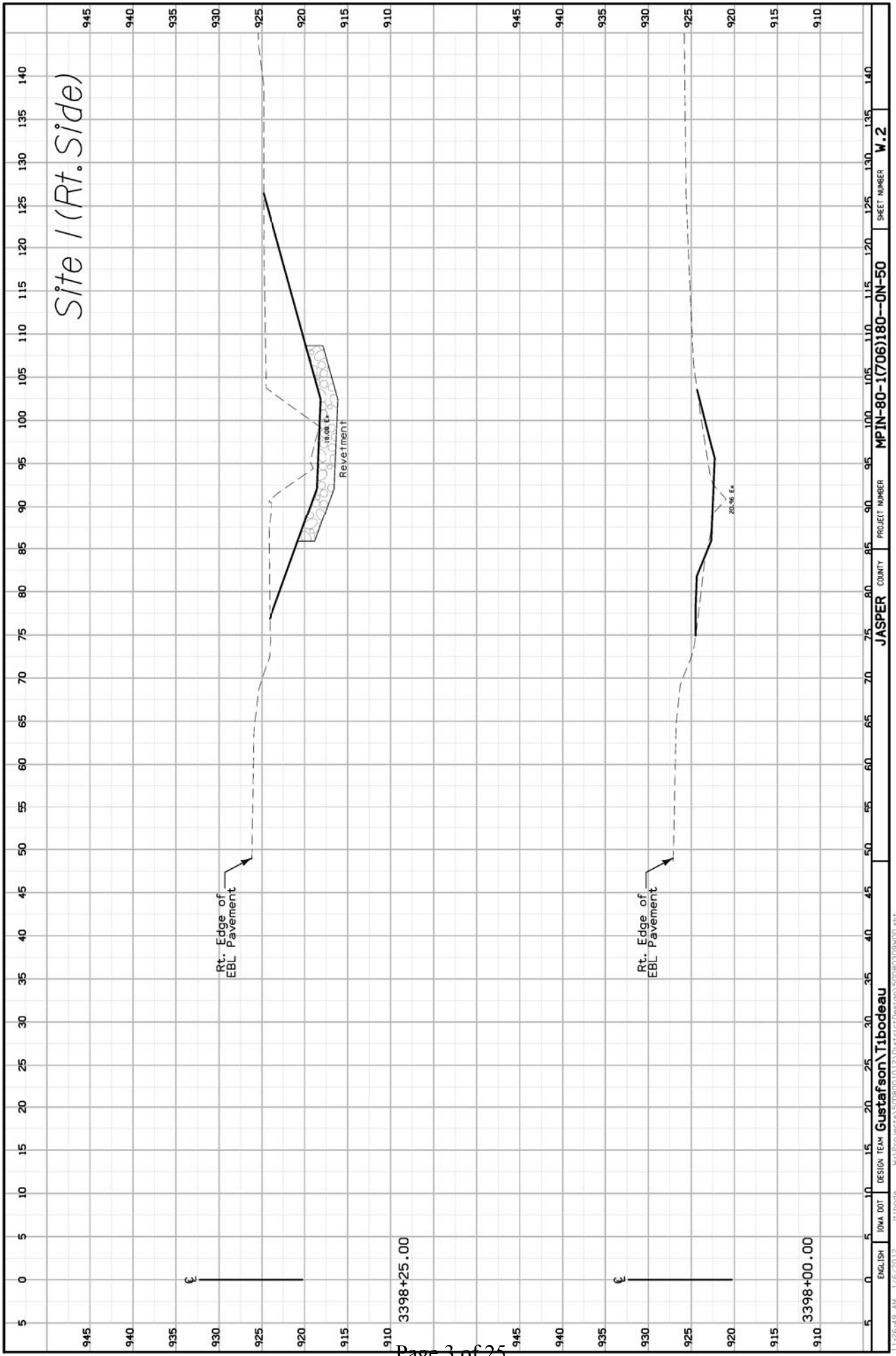

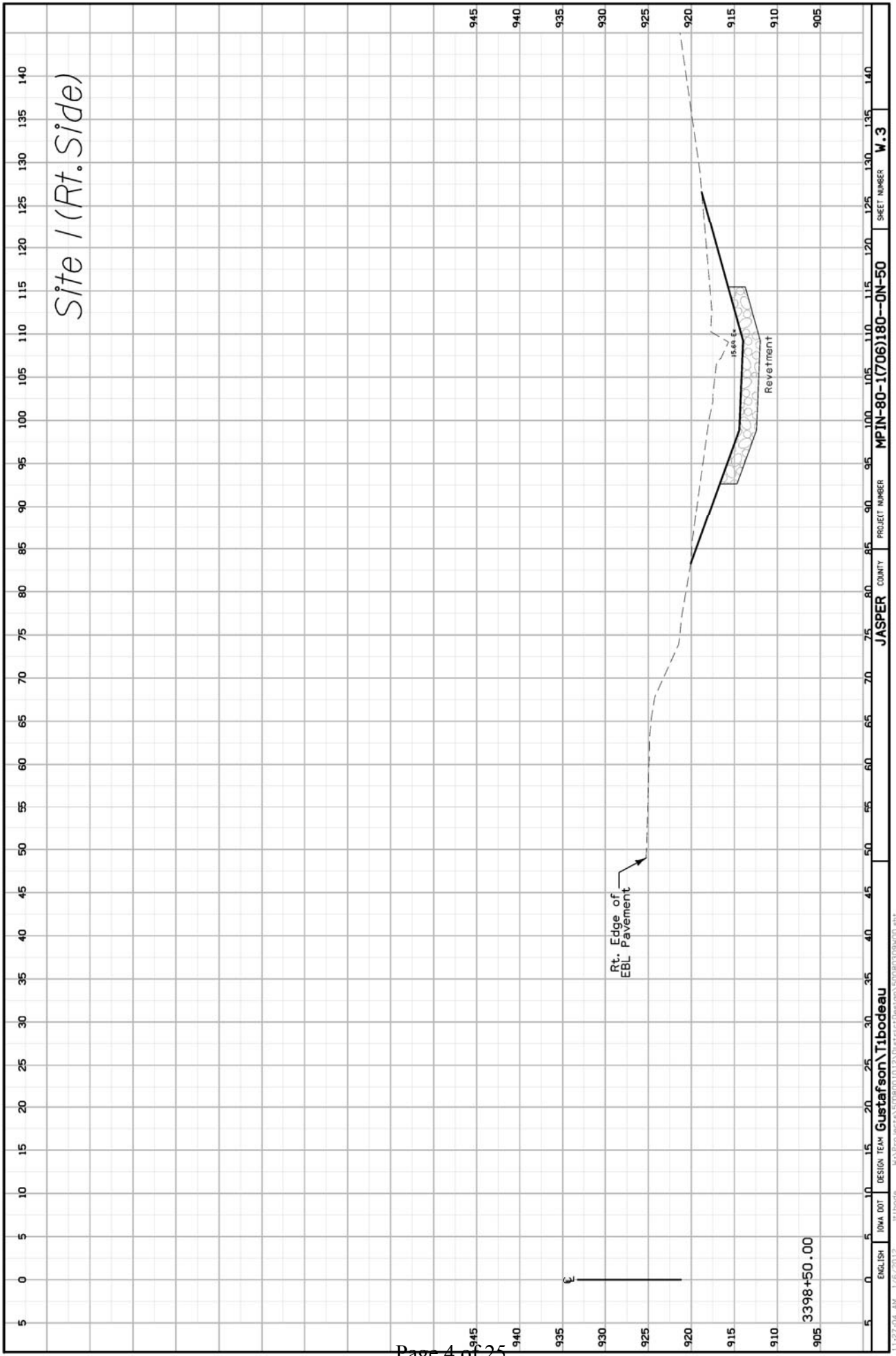

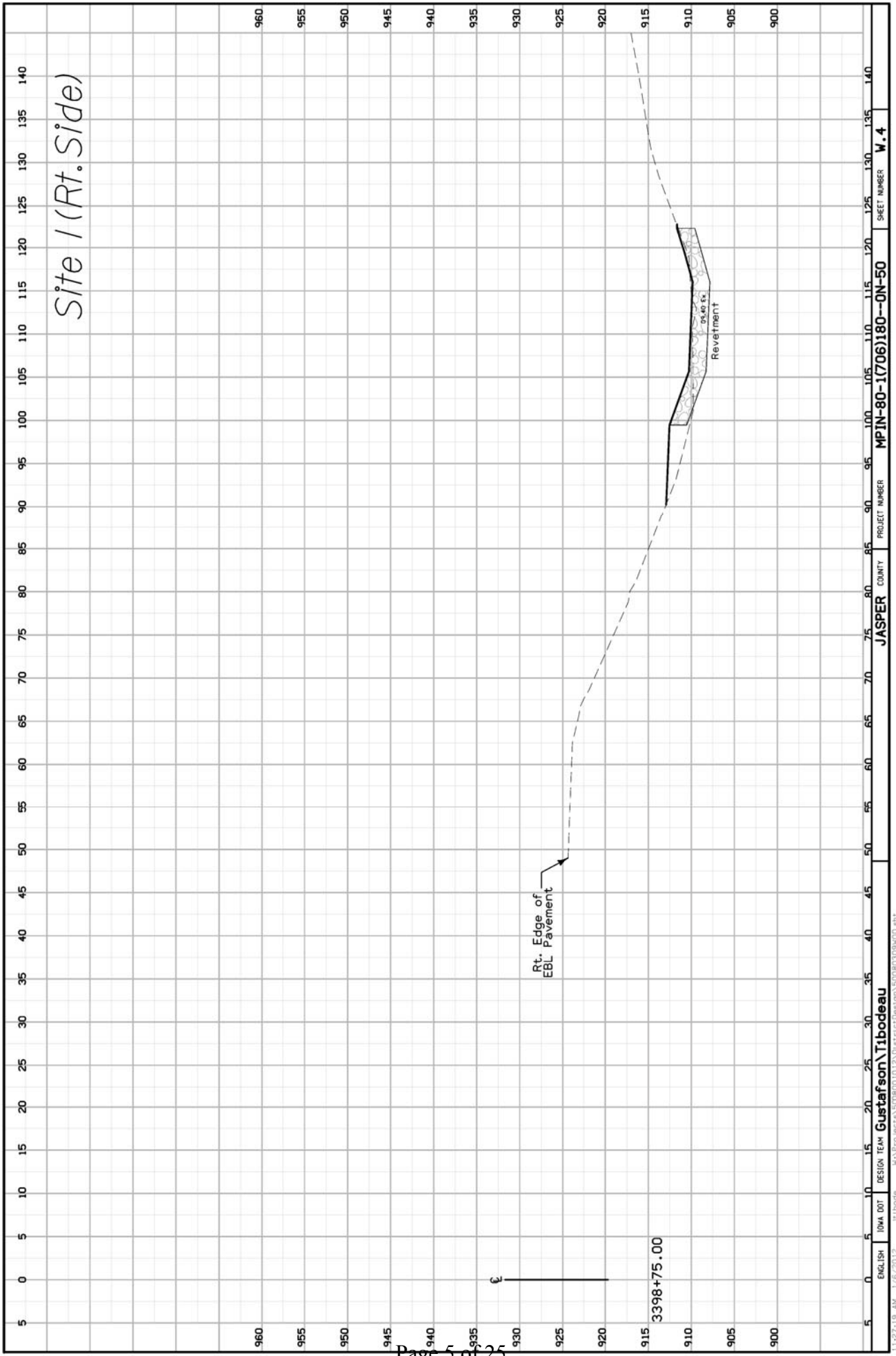

ENGLISH	IOWA DOT	DESIGN TEAM	Gustafson\Tibodeau	COUNTY	JASPER	PROJECT NUMBER	MPIN-80-(1706)180--0N-50	SHEET NUMBER	W.4
---------	----------	-------------	--------------------	--------	--------	----------------	--------------------------	--------------	-----

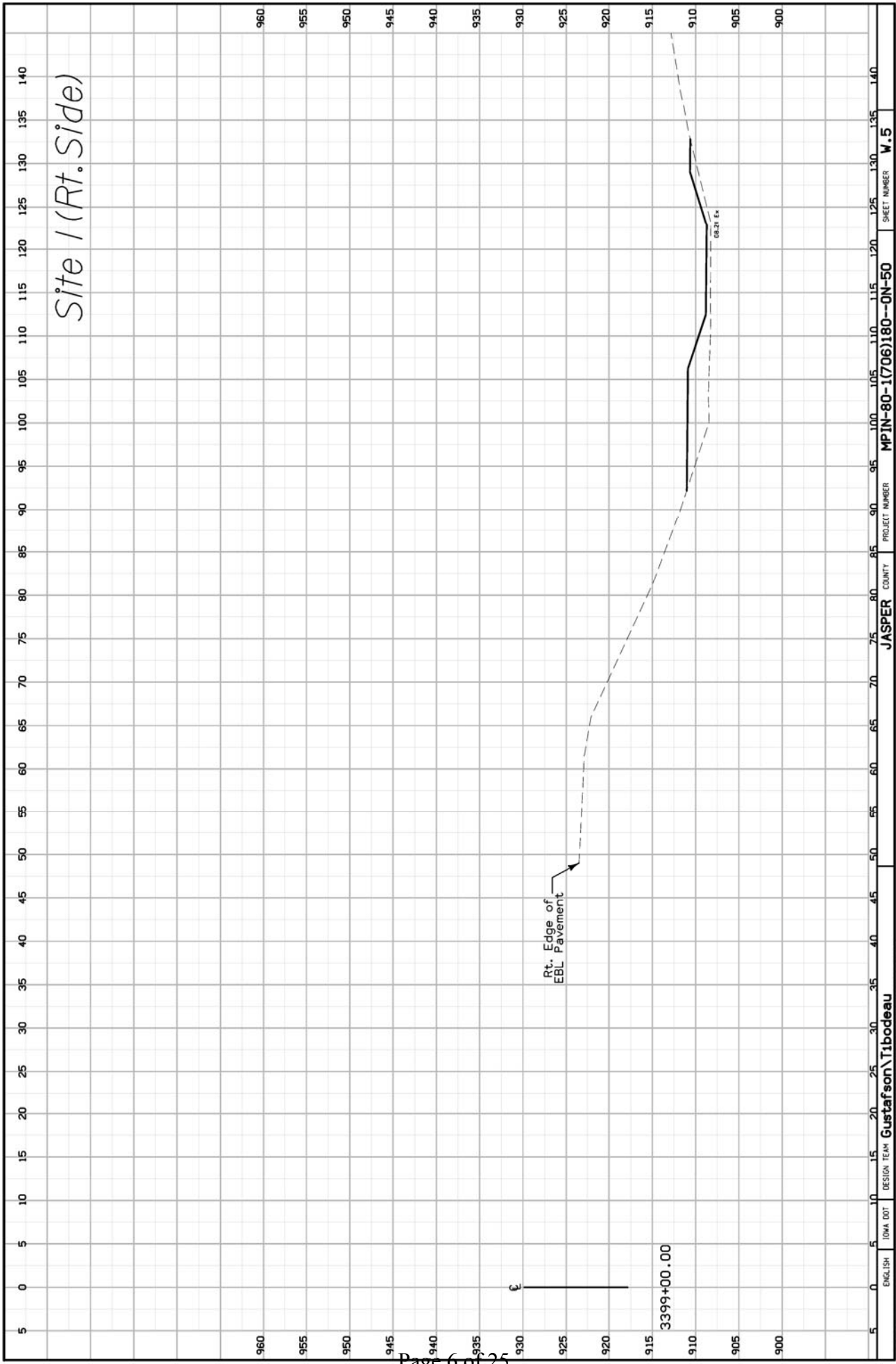

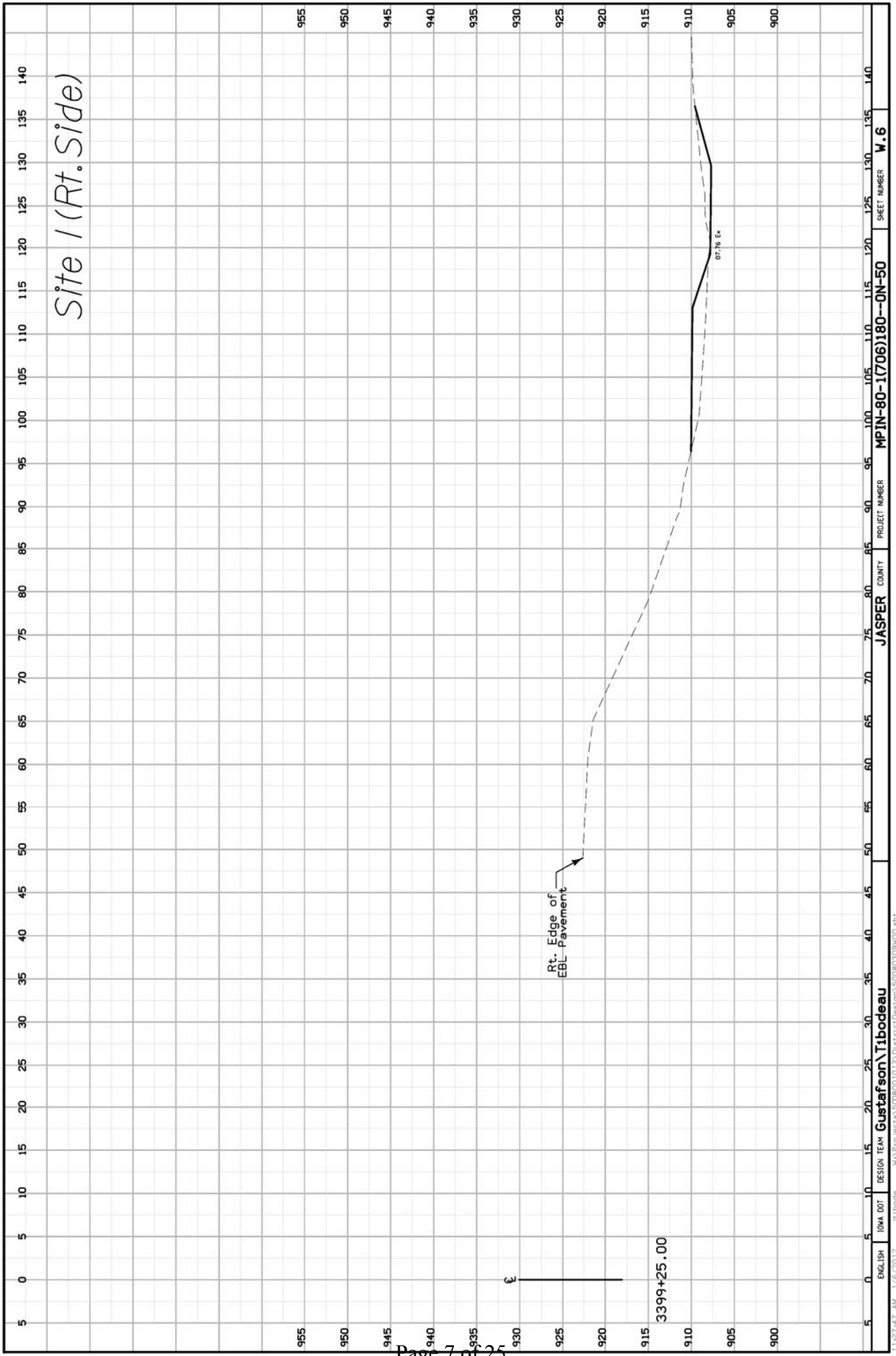

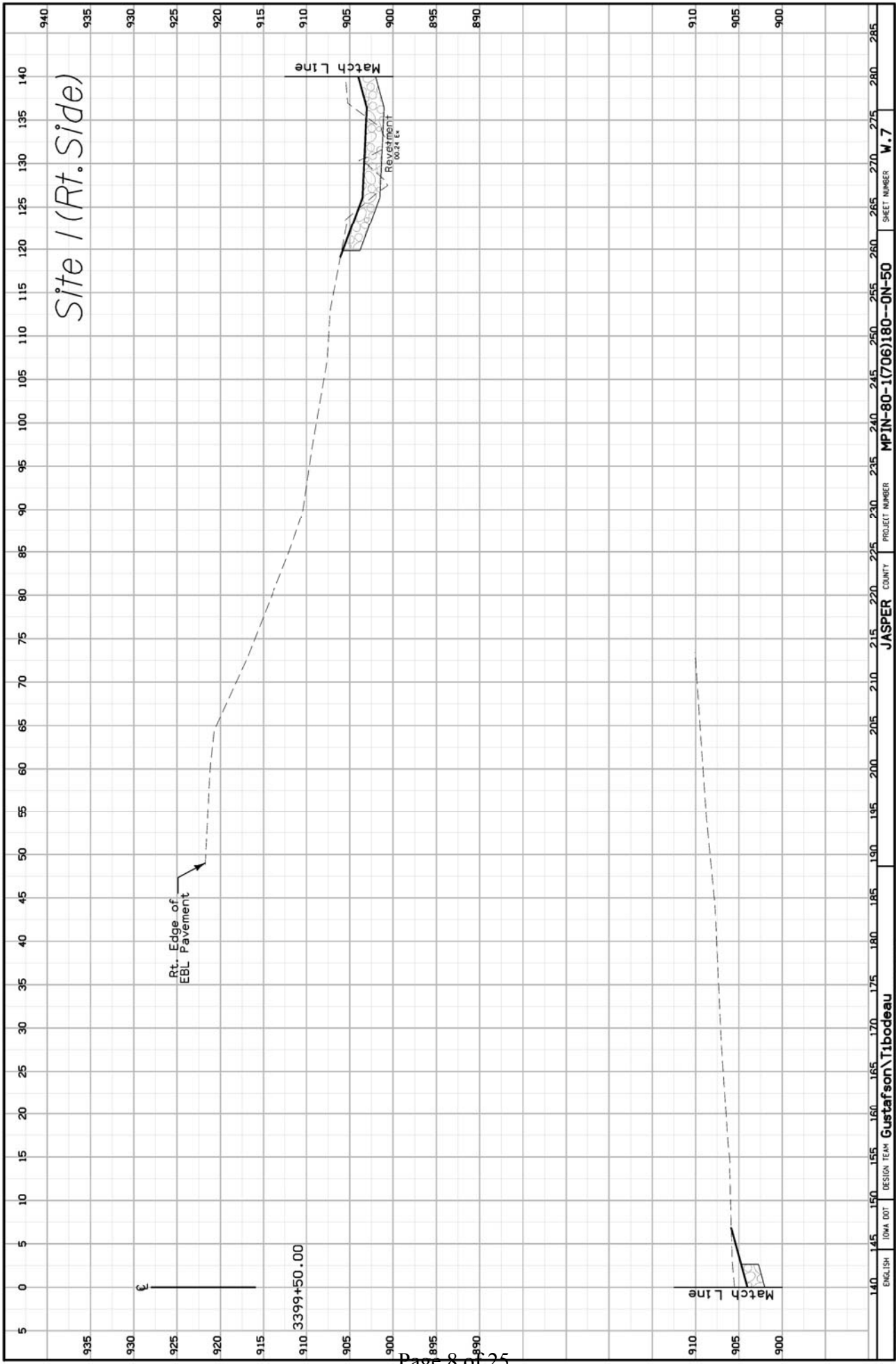

140	145	150	155	160	165	170	175	180	185	190	195	200	205	210	215	220	225	230	235	240	245	250	255	260	265	270	275	280	285							
ENGLISH	1044	007	DESIGN TEAM	Gustafson Tibodeau										JASPER	COUNTY	MPIN-80-1(706)180--0N-50										SHEET NUMBER										W.7
11/28/02 AM	1/6/2012	jtibode	W:\Projects\5008001012\01stricDesign\50080309400.sht																																	

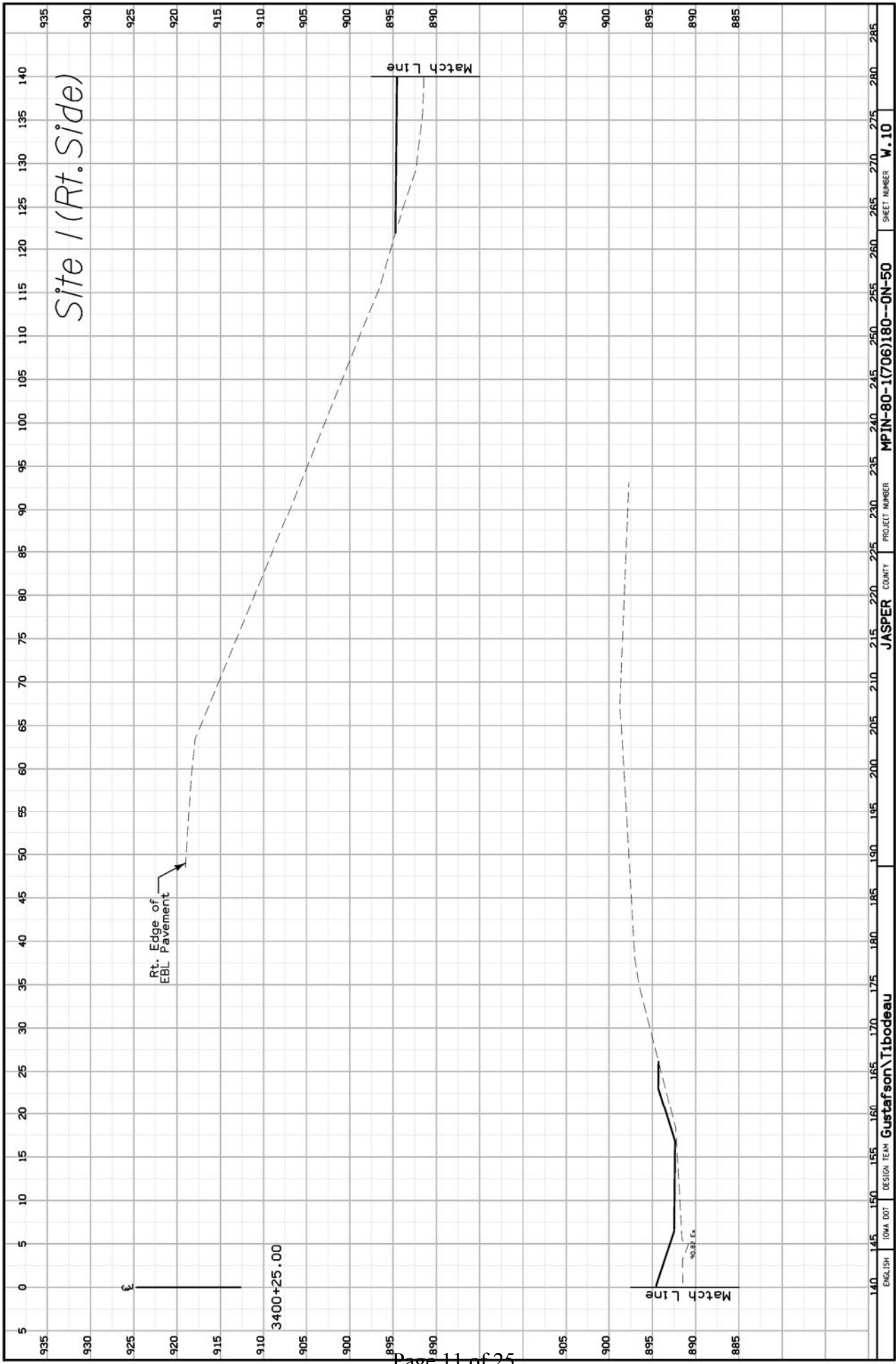

140	135	130	125	120	115	110	105	100	95	90	85	80	75	70	65	60	55	50	45	40	35	30	25	20	15	10	5	0	5	10	15	20	25	30	35	40	45	50	55	60	65	70	75	80	85	90	95	100	105	110	115	120	125	130	135	140	145	150	155	160	165	170	175	180	185	190	195	200	205	210	215	220	225	230	235	240	245	250	255	260	265	270	275	280	285
ENGLISH	1044.007	DESIGN TEAM	Gustafson\Tibodeau	JASPER	COUNTY	MPIN-80-1(706)180--0N-50	PROJECT NUMBER	W.10	SHEET NUMBER	1126149	AM	1/6/2012	jtibodeau	W:\Projects\5008001012\01stricDesign\50080309400.sht																																																																							

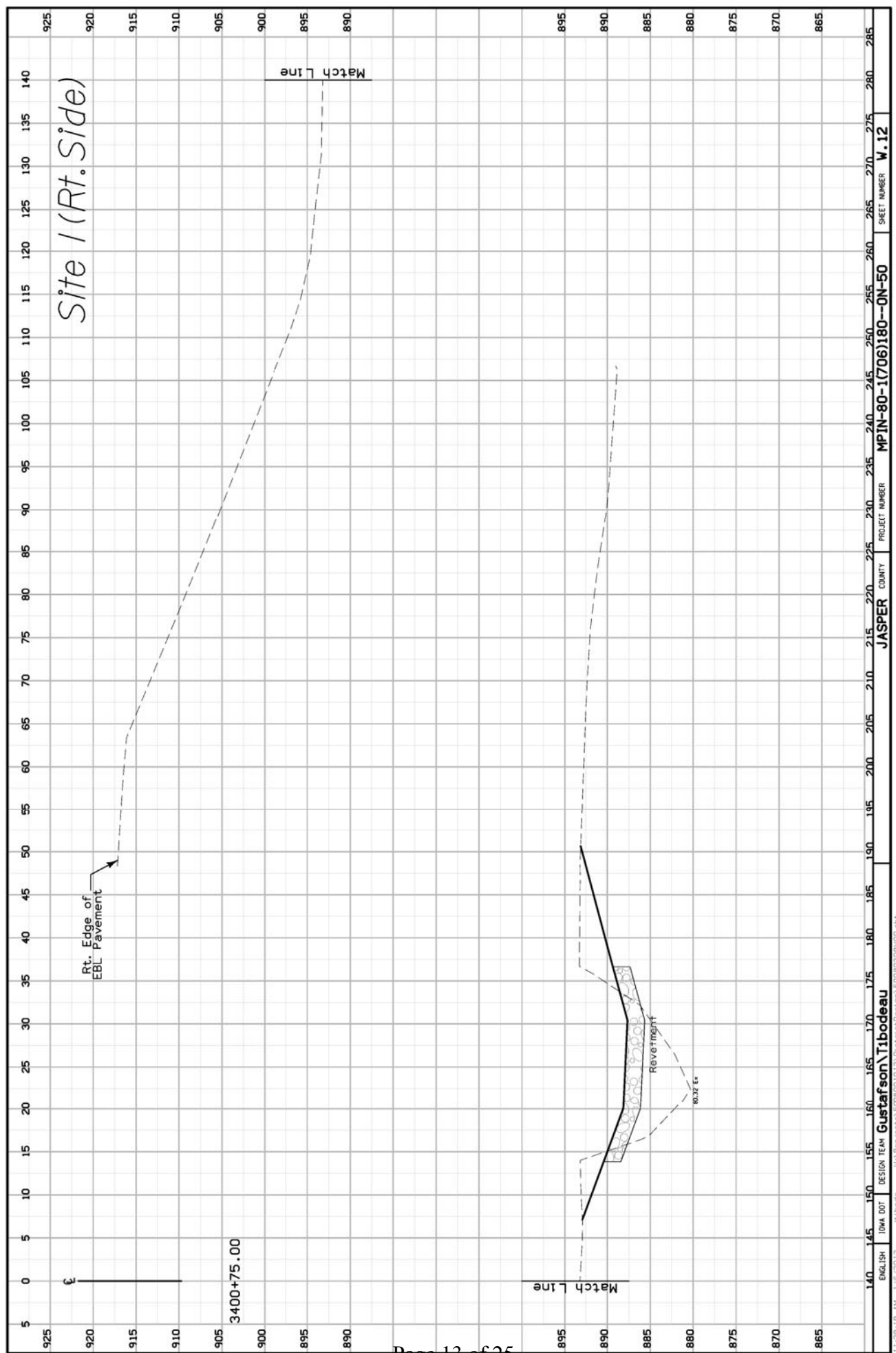

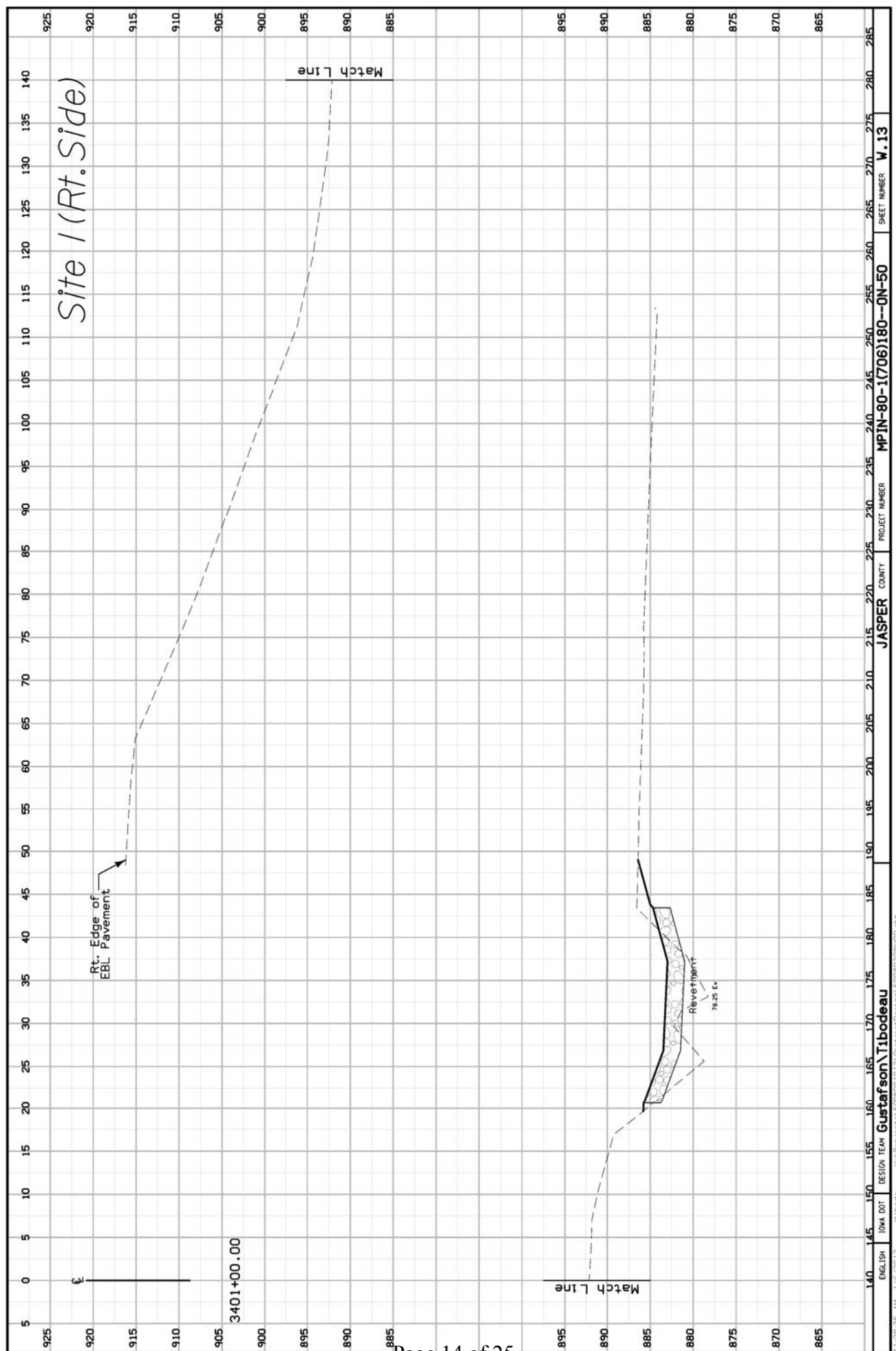

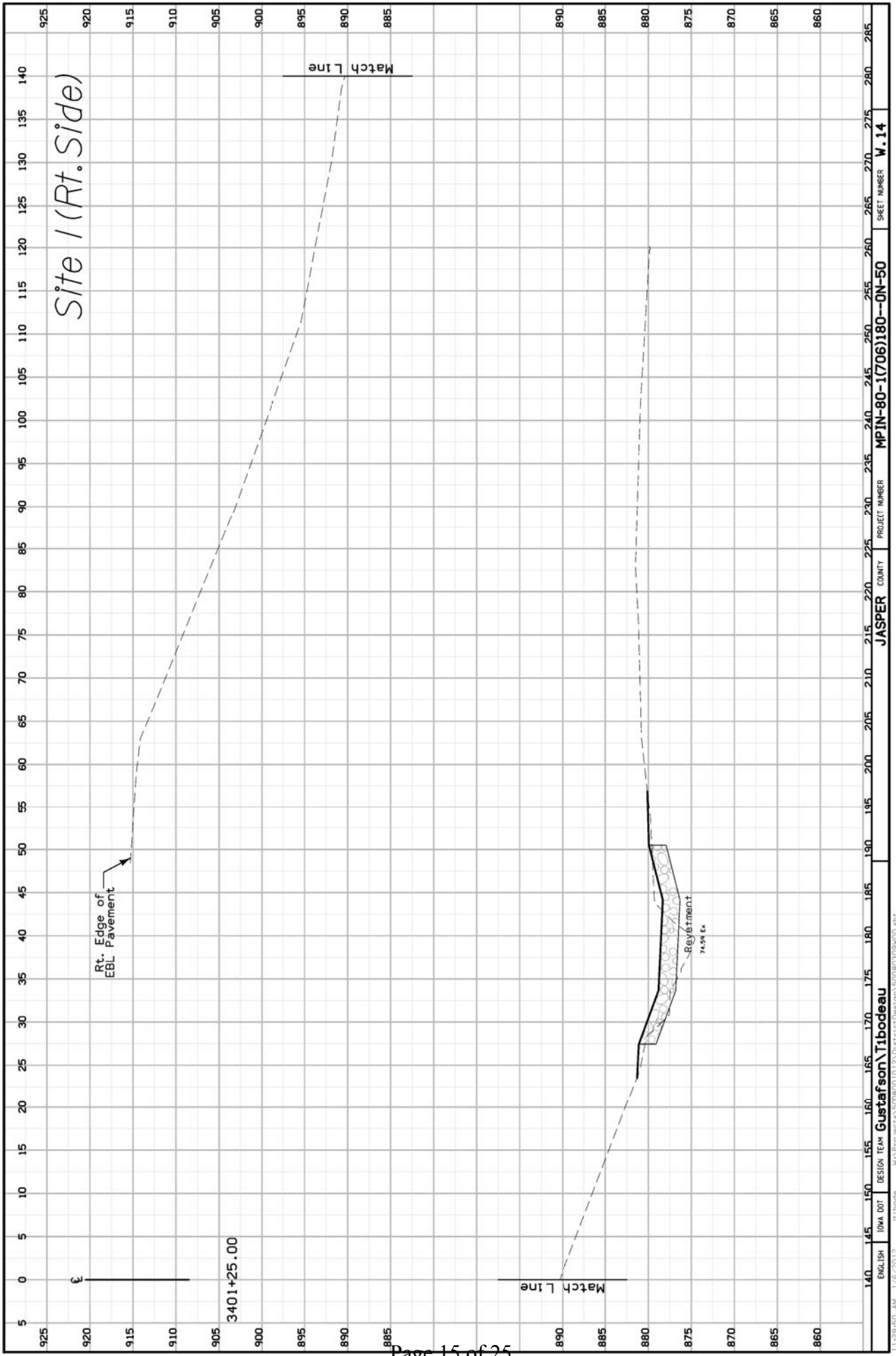

ENGLISH	1044.007	DESIGN TEAM	Gustafson\Tibodeau	JASPER	COUNTY	PROJECT NUMBER	MPIN-80-1(706)180--ON-50	SHEET NUMBER	W.14
---------	----------	-------------	--------------------	--------	--------	----------------	--------------------------	--------------	------

11/6/2012 AM 1/6/2012 jtbodeau W:\Projects\5008001012\01streetDesign\500800309400.dwt

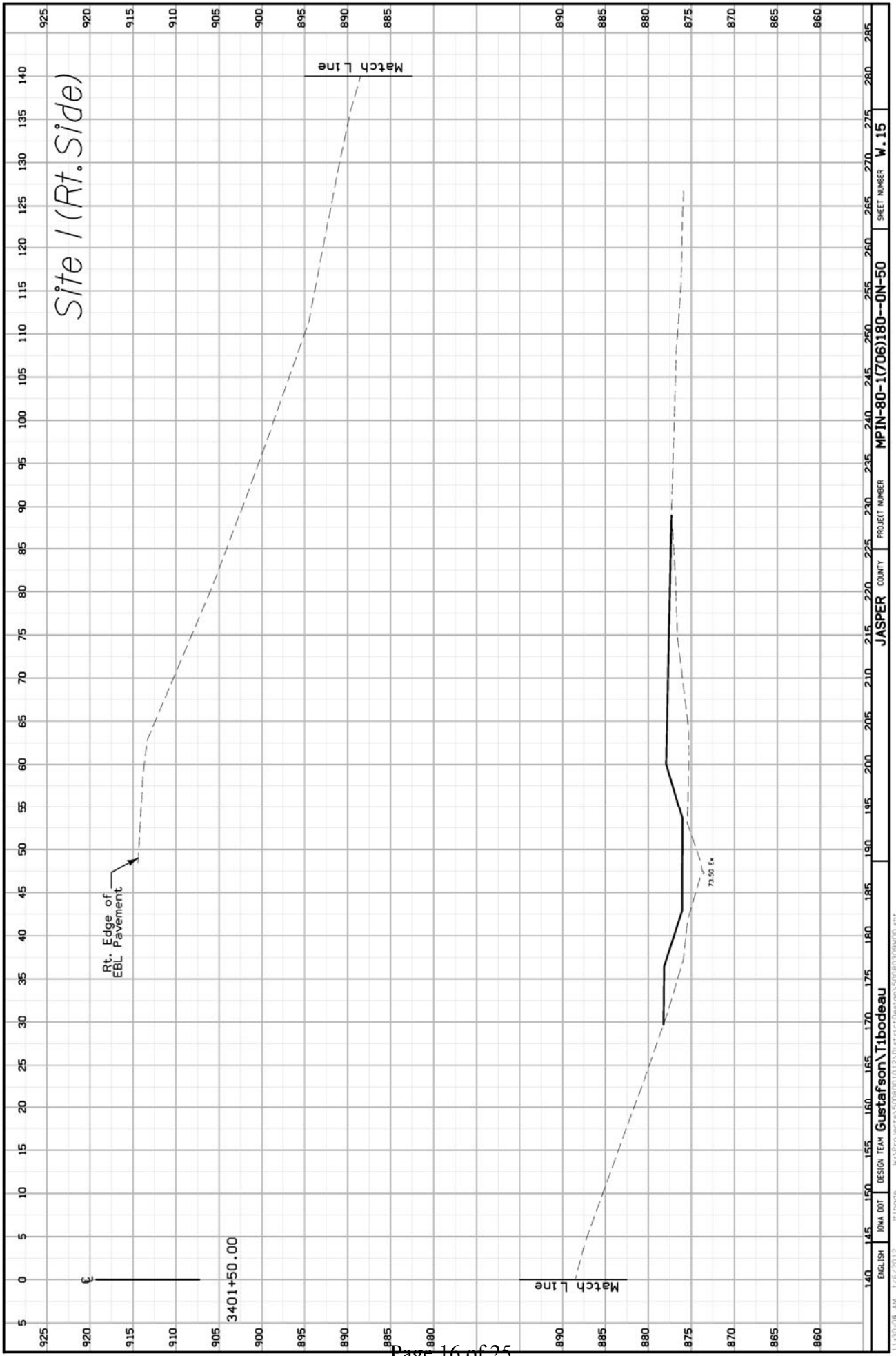

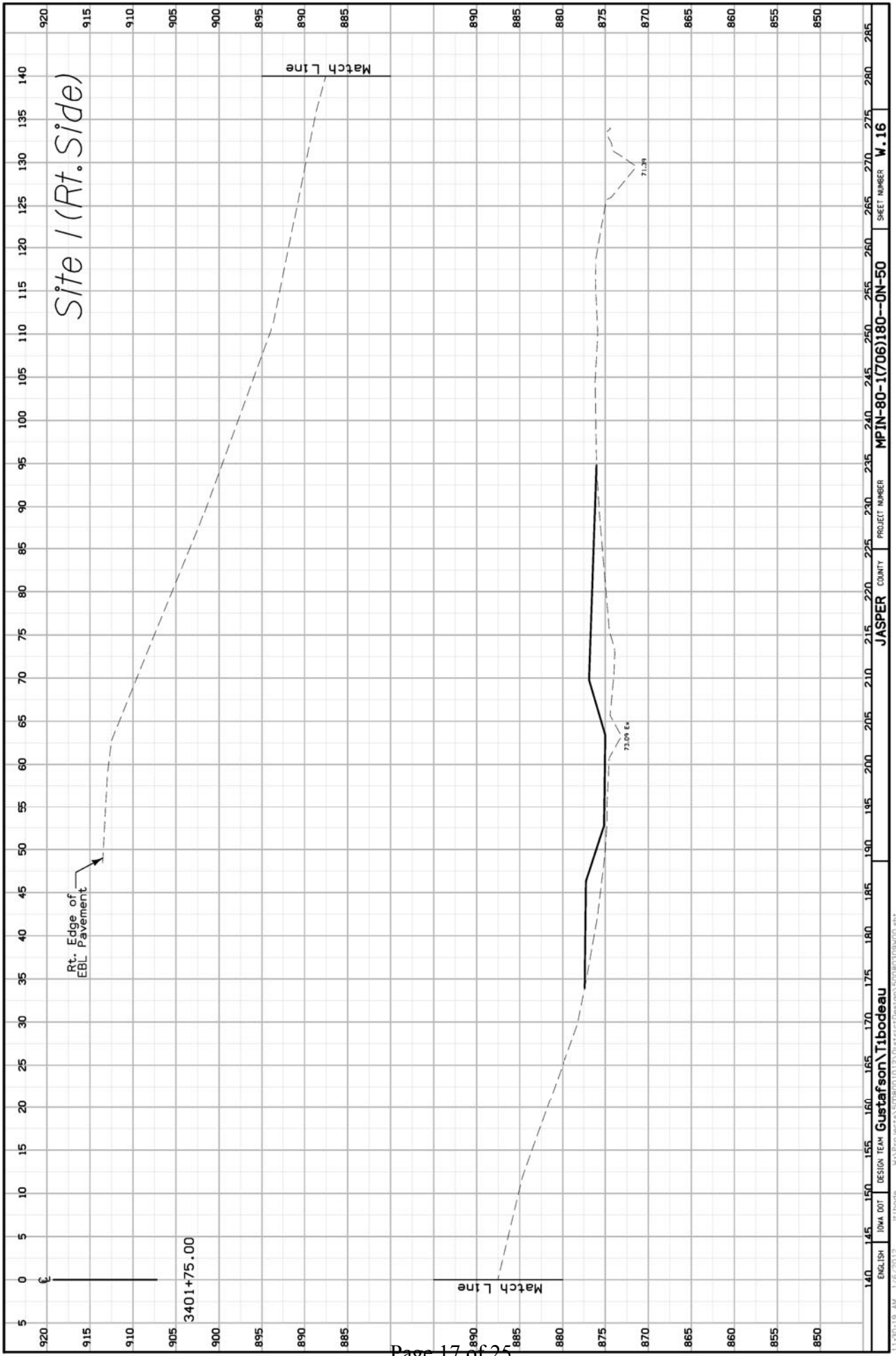

140	135	130	125	120	115	110	105	100	95	90	85	80	75	70	65	60	55	50	45	40	35	30	25	20	15	10	5	0	ENGLISH	1044 007	DESIGN TEAM	Gustafson\Tibodeau	PROJECT NUMBER	MPIN-80-(1706)180--0N-50	SHEET NUMBER	W. 16	285
-----	-----	-----	-----	-----	-----	-----	-----	-----	----	----	----	----	----	----	----	----	----	----	----	----	----	----	----	----	----	----	---	---	---------	----------	-------------	--------------------	----------------	--------------------------	--------------	-------	-----

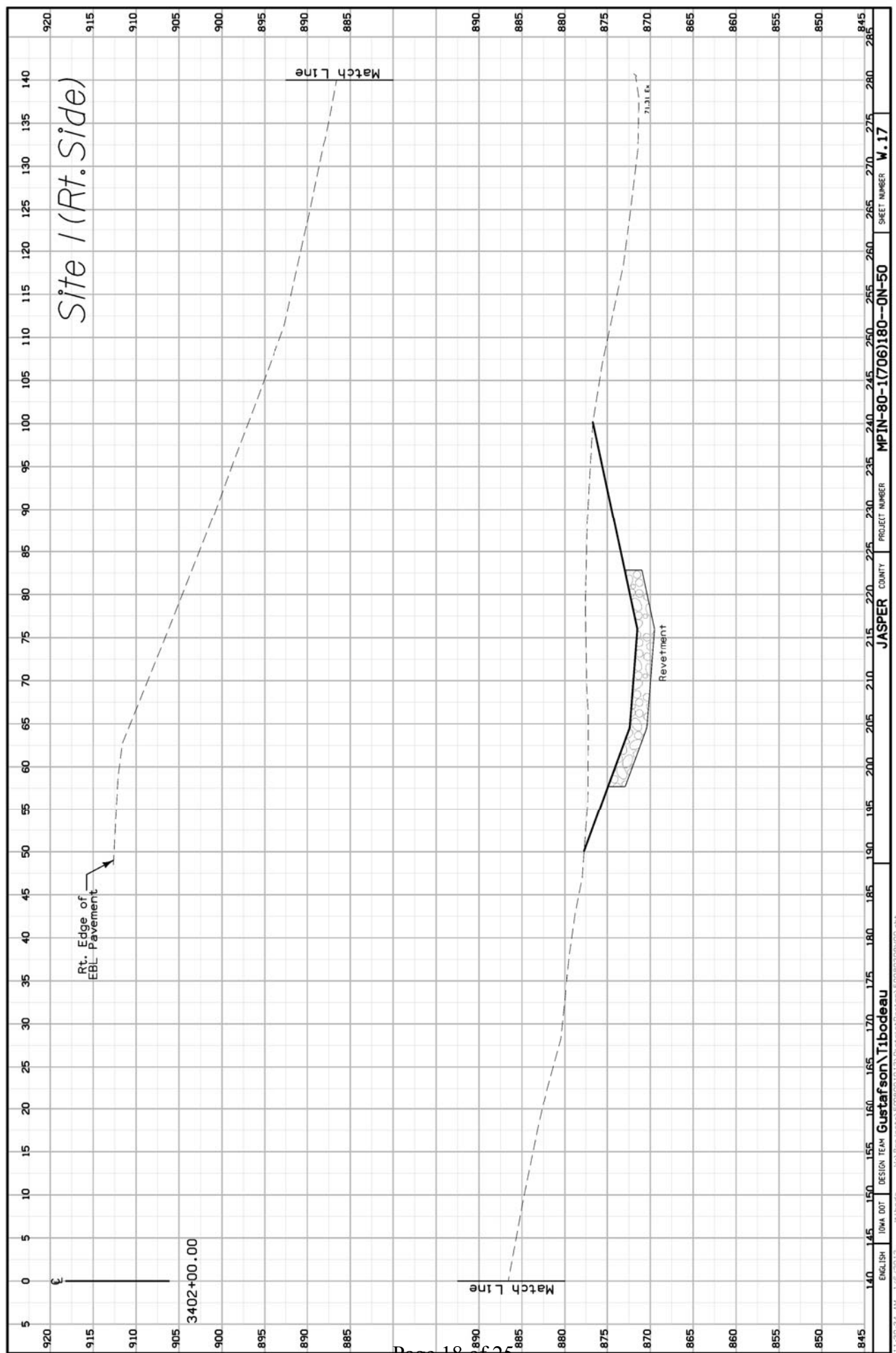

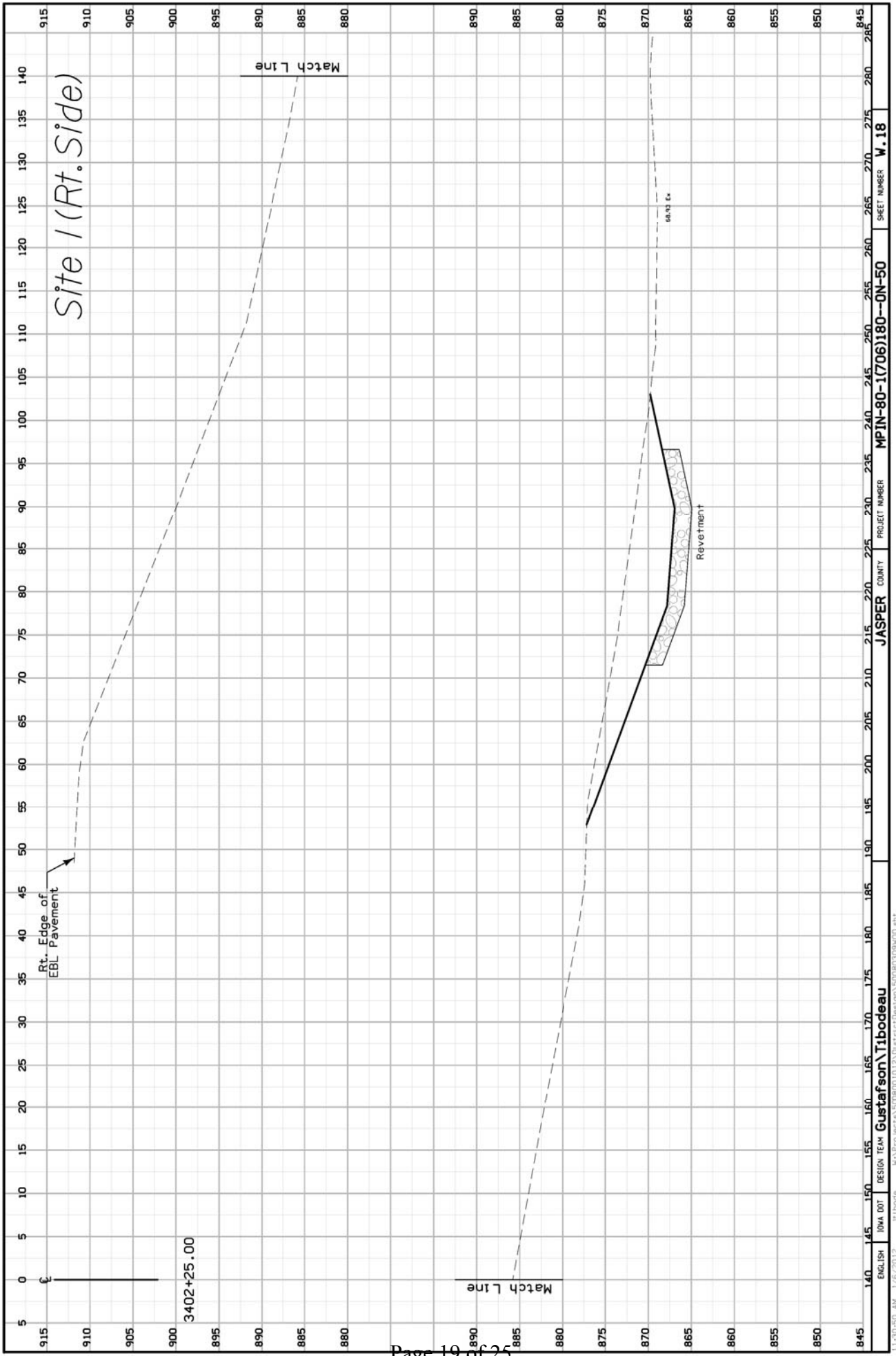

ENGLISH	1/6/2012	11:50:50 AM	145	150	155	160	165	170	175	180	185	190	195	200	205	210	215	220	225	230	235	240	245	250	255	260	265	270	275	280	285	
DESIGN TEAM	1044 007																															
Jtlbode																																
W:\Projects\500800\012\01stricDesign\50080309400.sht																																
MPIN-80-1(706)180--ON-50																																
PROJECT NUMBER																																
COUNTY																																
JASPER																																
SHEET NUMBER																																
W. 18																																

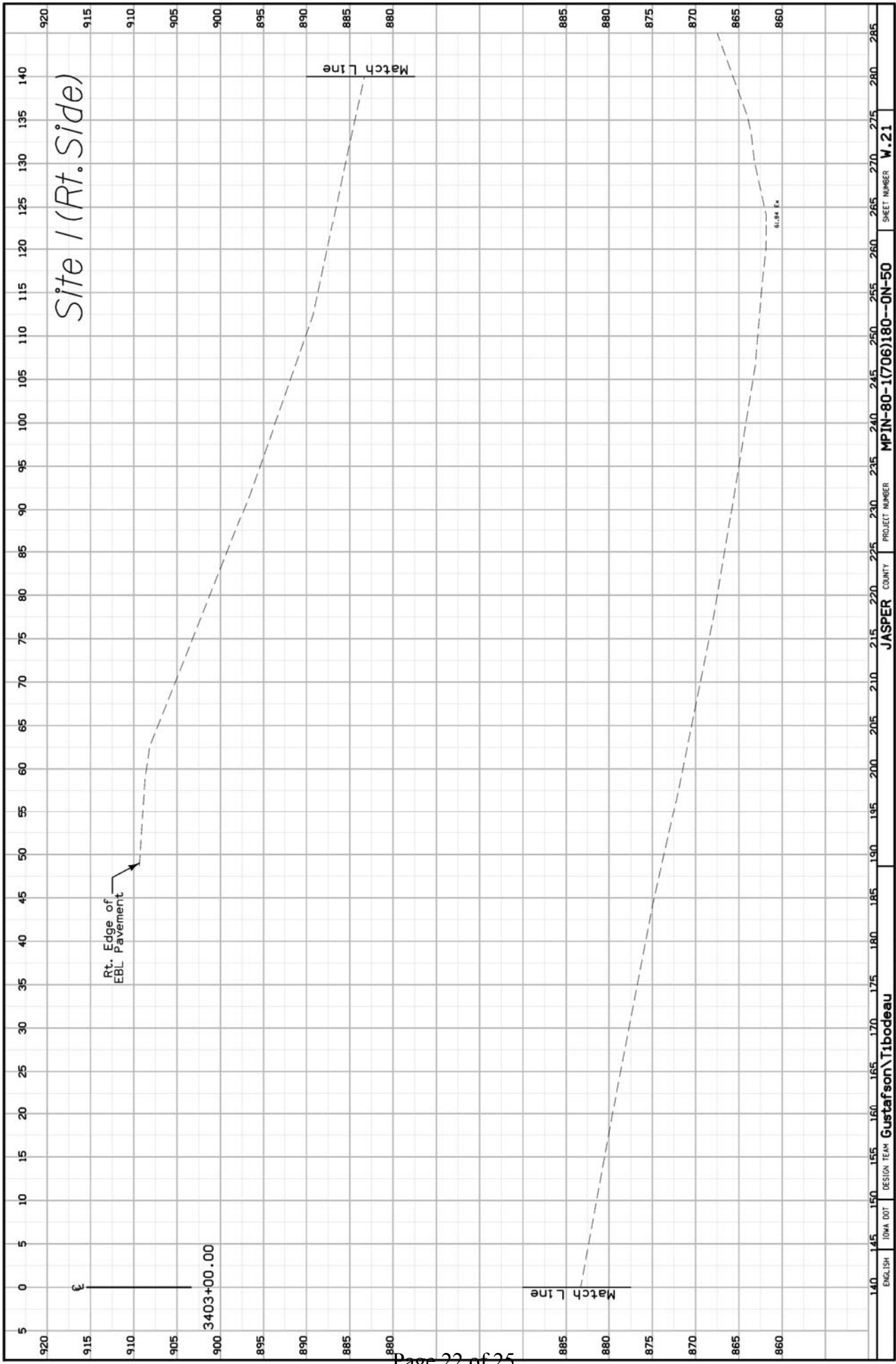

Site 1 (Rt. Side)

Rt. Edge of
EBL Pavement

3403+00.00

Match Line

Match Line

6.14 1x

140	135	130	125	120	115	110	105	100	95	90	85	80	75	70	65	60	55	50	45	40	35	30	25	20	15	10	5	0	ENGLISH	1/6/2012	Jtlbode	DESIGN TEAM	Gustafson\Tibodeau	PROJECT NUMBER	MPIN-80-1(706)180--ON-50	SHEET NUMBER	M.21	285
-----	-----	-----	-----	-----	-----	-----	-----	-----	----	----	----	----	----	----	----	----	----	----	----	----	----	----	----	----	----	----	---	---	---------	----------	---------	-------------	--------------------	----------------	--------------------------	--------------	------	-----

