

A d d e n d u m

Iowa Department of Transportation
Office of Contracts

Date of Letting: February 21, 2012
Date of Addendum: February 3, 2012

B.O.	Proposal ID	Proposal Work Type	County	Project Number	Addendum
109	97-0296-223	PCC PAVEMENT - GRADE & NEW	WOODBURY	IM-NHS-029-6(195)142--03-97 IM-NHS-029-6(223)143--03-97 IM-NHS-029-6(224)143--03-97 ITS-029-6(230)145--25-97 IM-029-6(235)142--13-97	21FEB109.A01

Notice: Only the bid proposal holders receive this addendum and responsibility for notifying any potential subcontractors or suppliers remains with the proposal holder.

Make the following changes to the PROPOSAL SCHEDULE OF PRICES:

Change Line No. 1020 2513-0001000 CONCRETE BARRIER, BA-100 from 4,828.900 LF to 4,793.700 LF.

Delete Line No. 1030 2513-0001010 CONCRETE BARRIER, BA-101

Change Line No. 1040 2513-0001020 CONCRETE BARRIER, BA-102 from 1,130.200 LF to 1,690.000 LF.

Delete Line No. 1060 2513-0474990 CONCRETE BARRIER, REINFORCED, AS PER PLAN

Change Line No. 1070 2513-0475000 CONCRETE BARRIER TRANSITION SECTION from 8.000 EACH to 18.000 EACH.

If the above changes are not made on the proposal form, they will be made as shown here.

Make the following change to plan IM-NHS-029-6(223)143--03-97:

Plan Sheet C.22:

Replace Tabulation 108-18 with attached Tabulation 108-18.

Plan Sheets U.11-U.16:

Replace plan sheets U.11-U.16 with attached plan sheets U.11-U.16.

CONCRETE BARRIER

See BA-100, BA-101, BA-102, and BA-103

No.	Begin Station	End Station	Side	Barrier Type		Transition Section	Footing	Remarks
				Standard Road Plan	Length			
					LF			
1	9002+00.00	9008+33.60	Med.	BA-100	634.0			
2	1262+90.00	1269+13.33	Med.	BA-100	623.4			
3	1269+13.33	1269+19.33	Med.			BA-101		Refer to Sheet U.10 for details, NOTE 1
4	1269+19.33	1269+43.00	Med.	BA-102	47.4			Refer to Sheets U.3, U.10 for details
5	1269+43.00	1269+49.00	Med.			BA-105 Mod.		Refer to Sheet U.10 for details, NOTE 2
6	1269+49.00	1269+51.00	Med.	BA-103	4.0			Refer to Sheet U.10 for details
7	1269+51.00	1269+57.00	Med.			BA-105 Mod.		Refer to Sheet U.10 for details, NOTE 2
8	1269+57.00	1269+80.67	Med.	BA-102	47.3			Refer to Sheet U.3, U.10 for details
9	1269+80.67	1269+86.67	Med.			BA-101		Refer to Sheet U.10 for details, NOTE 1
10	1269+86.67	1274+53.00	Med.	BA-100	466.4			
11	1274+53.00	1274+59.00	Med.			BA-101		Refer to Sheet U.9 for details, NOTE 1
12	1274+59.00	1275+66.01	Med.	BA-102	214.1			Refer to Sheet U.3, U.9 for details
13	1275+66.01	1275+72.01	Med.			BA-101		Refer to Sheet U.9 for details, NOTE 1
14	1275+72.01	1283+08.00	Med.	BA-100	736.0			
15	1283+08.00	1283+14.00	Med.			BA-101		Refer to Sheet U.8 for details, NOTE 1
16	1283+14.00	1284+41.00	Med. LT	BA-102	127.0			Refer to Sheet U.3, U.8 for details
17	1284+41.00	1284+47.00	Med.			BA-101		Refer to Sheet U.8 for details, NOTE 1
18	1284+47.00	1293+91.23	Med.	BA-100	944.2			
19	1293+91.23	1293+97.23	Med.			BA-101		Refer to Sheet U.11-U.12 for details, NOTE 1
20	1293+97.23	1295+17.75	Med.	BA-102	241.0			Refer to Sheet U.3, U.5, U.11-U.12 for details
21	1295+17.75	1295+23.75	Med.			BA-101		Refer to Sheet U.11-U.12 for details, NOTE 1
22	1295+23.75	1299+53.00	Med.	BA-100	429.3			
23	1299+53.00	1299+59.00	Med.			BA-101		Refer to Sheet U.13-U.14 for details, NOTE 1
24	1299+59.00	1302+66.51	Med.	BA-102	615.0			Refer to Sheet U.3, U.5, U.13-U.14 for details
25	1302+66.51	1302+72.51	Med.			BA-101		Refer to Sheet U.13-U.14 for details, NOTE 1
26	1302+72.51	1305+51.55	Med.	BA-100	279.1			
27	1305+51.55	1305+57.55	Med.			BA-101		Refer to Sheet U.15-U.16 for details, NOTE 1
28	1305+57.55	1307+15.65	Med.	BA-102	316.2			Refer to Sheet U.3, U.5, U.15-U.16 for details
29	1307+15.65	1307+21.65	Med.			BA-101		Refer to Sheet U.15-U.16 for details, NOTE 1
30	1307+21.65	1314+02.98	Med.	BA-100	681.3			
31	1314+02.98	1314+08.98	Med.			BA-101		Refer to Sheet U.8 for details, NOTE 1
32	1314+08.98	1314+90.98	Med.	BA-102	82.0			Refer to Sheet U.3, U.8 for details
33	1314+90.98	1314+96.98	Med.			BA-101		Refer to Sheet U.8 for details, NOTE 1
NOTES:								
1. ONE EACH REQUIRED AT EACH LOCATION AND PAID FOR AS CONCRETE BARRIER TRANSITION SECTION								
2. TWO EACH REQUIRED AT EACH LOCATION AND PAID FOR AS CONCRETE BARRIER TRANSITION SECTION								

Use Grade 60 epoxy-coated reinforcing bars. Provide 2 inches minimum cover. Anchor all reinforcement to prevent movement. Secure each section at the front, back, and at 3'-6" intervals using a method approved by the Engineer.

Possible Contract Items:

1. Concrete Barrier: BA-101
 2. Concrete Barrier: BA-102
 3. Reinforced Paved Shoulder
 4. Standard Paved Shoulder
 5. FCC Median Concrete Cap, 4 in.
- ① Barrier Markers

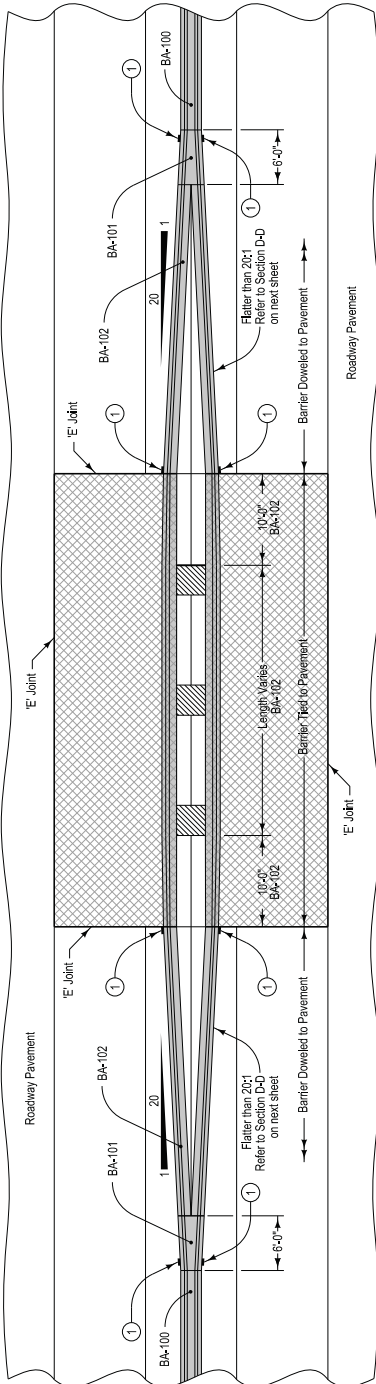

Refer to Standard Road Plans BA-100, BA-101, BA-102, and BA-106 for additional concrete barrier labels.

HRG-CMB-4	
CONCRETE BARRIER AT BRIDGE PIER 1294+57 (SHEET 1 OF 2)	
PROJECT NUMBER	IM-NHS-029-6(223)143-03-97
SHEET NUMBER	U. 11

ENGLISH	WOODBURY COUNTY	PROJECT NUMBER	IM-NHS-029-6(223)143-03-97	SHEET NUMBER	U. 11
DESIGN TEAM	Schoenrock \ HR Green, Inc.				
DATE	10/53:10 AM				

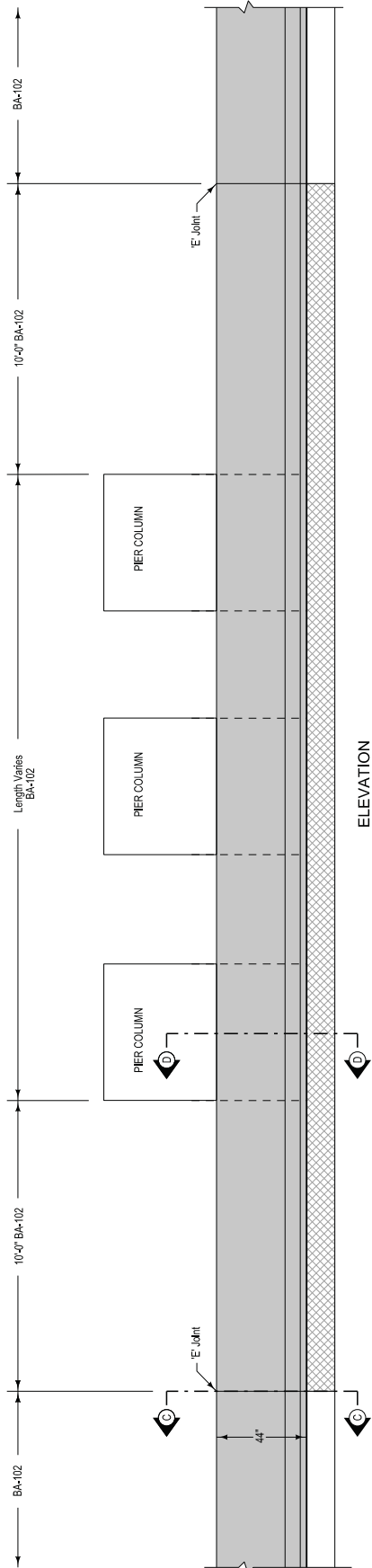

ELEVATION

Reinforced Paved Shoulder
BA-106 (Refer to U.5)

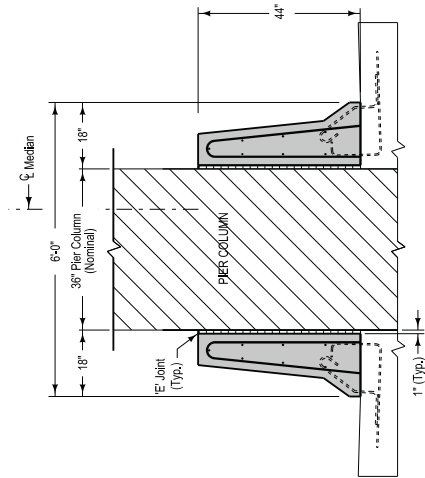

SECTION D-D

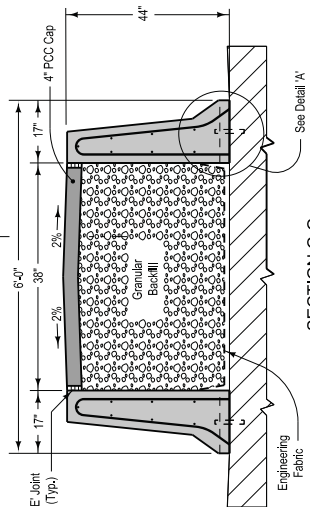

SECTION C-C

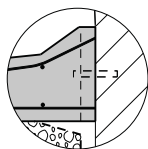

DETAIL 'A'
3" Weep Hole

2 Construct weep holes from 3 inch diameter PVC pipe. Maximum spacing between weep holes is 20 feet. However, keep holes at least 5 feet from any transverse joints. Cover interior of weep holes with copper screening or galvanized hardware cloth. Attach engineering fabric at least 3 inches above top of weep holes in a manner approved by the engineer. The cost of supplying and installing weep holes, engineering fabric, and screening will be considered incidental to concrete barrier items.

NOTE: Do not construct weep holes in areas of reinforced paved shoulder.

HRG-CMB-4

CONCRETE BARRIER AT
BRIDGE PIER
1294+57
(SHEET 2 OF 2)

SHEET NUMBER U.12

PROJECT NUMBER IM-NHS-029-6(223)143--03-97

WOODBURY COUNTY

amuerich \\\ingermar\data\cadd\16440.09\9702223\CAD\Design\970223001.sht
Schoenrock \ HR Green, Inc.
DESIGN TEAM
ENGLISH IDMA DOT

Use Grade 60 epoxy-coated reinforcing bars. Provide 2 inches minimum cover. Anchor all reinforcement to prevent movement. Secure each section at the front, back, and at 3'-6" intervals using a method approved by the Engineer.

Possible Contract Items:

1. Concrete Barrier, BA-101
2. Concrete Barrier, BA-102
3. Reinforced Paved Shoulder
4. Standard Paved Shoulder
5. FCC Median Concrete Cap, 4 in.

① Barrier Markers

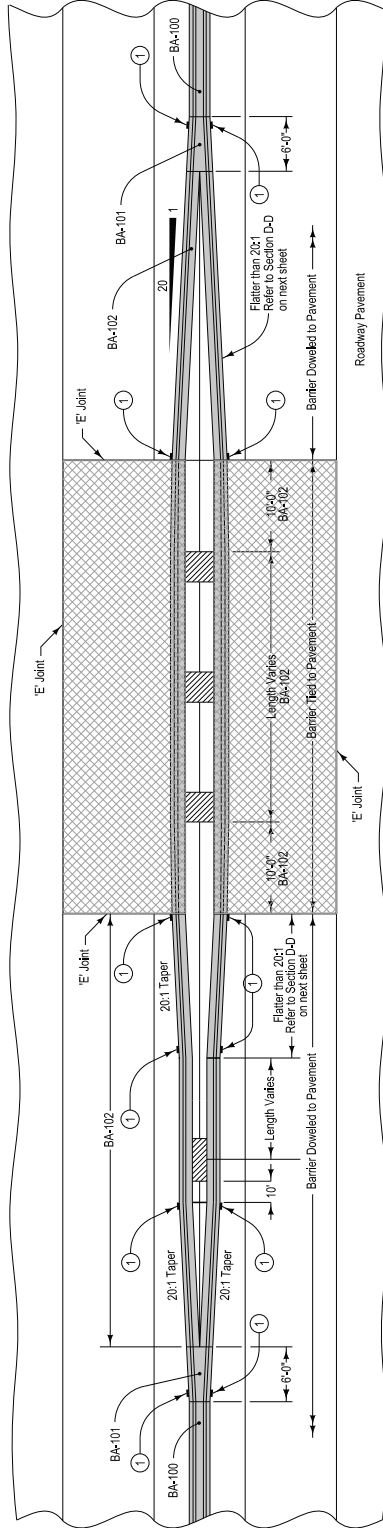

Reinforced Paved Shoulder
BA-106 (Refer to U.5)

Refer to Standard Road Plans BA-100, BA-101, BA-102, and BA-106 for additional concrete barrier labels.

HRG-CMB-5

CONCRETE BARRIER AT
BRIDGE PIER AND SIGN TRUSS
1301+40
(SHEET 1 OF 2)

ENGLISH	DMA DOT	DESIGN TEAM	Schoenrock \ HR Green, Inc.	WOODBURY COUNTY	PROJECT NUMBER	IM-NHS-029-6(223)143-03-97	SHEET NUMBER	U.13
10:53:12 AM	amuerich							

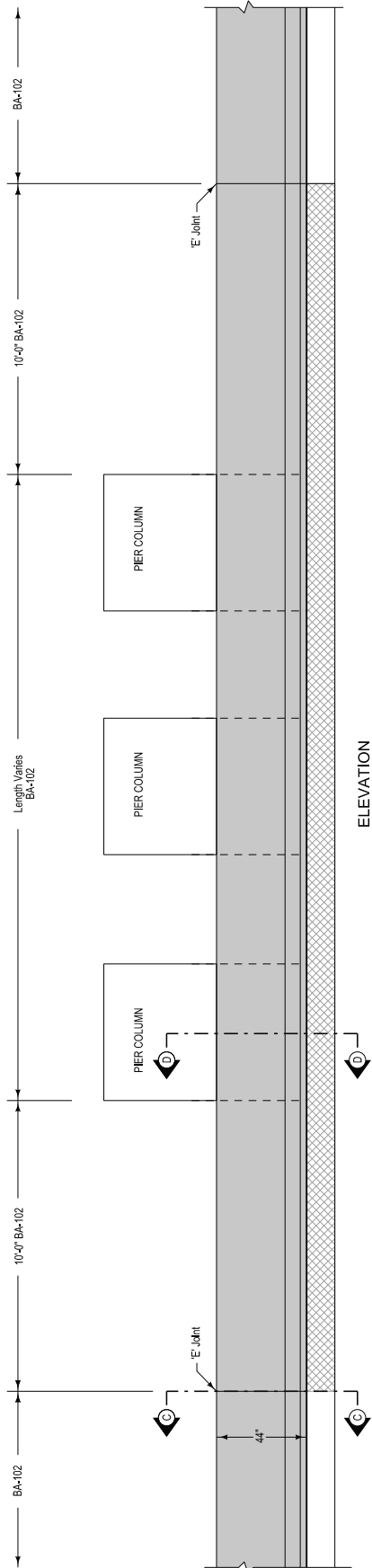

ELEVATION

Reinforced Paved Shoulder
BA-106 (Refer to U.5)

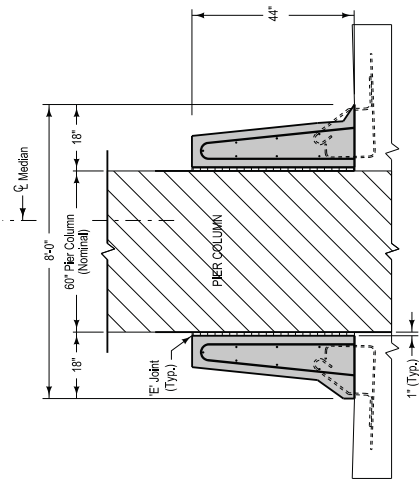

SECTION D-D

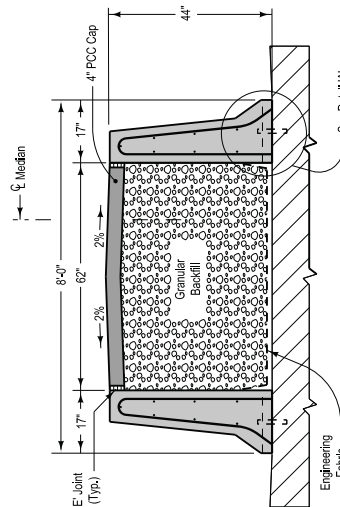

SECTION C-C

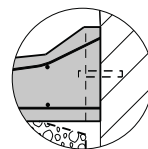

DETAIL 'A'
3" Weep Hole

② Construct weep holes from 3 inch diameter PVC pipe. Maximum spacing between weep holes is 20 feet. However, keep holes at least 5 feet from any transverse joints. Cover interior of weep holes with copper screening or galvanized hardware cloth. Attach engineering fabric at least 3 inches above top of weep holes in a manner approved by the engineer. The cost of supplying and installing weep holes, engineering fabric, and screening will be considered incidental to concrete barrier items.

NOTE: Do not construct weep holes in areas of reinforced paved shoulder.

HRG-CMB-5

CONCRETE BARRIER AT
BRIDGE PIER AND SIGN TRUSS
1301+40
(SHEET 2 OF 2)

SHEET NUMBER U.14

PROJECT NUMBER IM-NHS-029-6(223)143-03-97

WOODBURY COUNTY

DESIGN TEAM **Schoenrock \ HR Green, Inc.**
amuerich \ \ingerman\data\cadd\16440\09\9702\223\CAD\Design\9702\2300 1.sht

ENGLISH

DATE DOT

DESIGN TEAM

Schoenrock \ HR Green, Inc.

3" Weep Hole

10:53:13 AM

Use Grade 60 epoxy-coated reinforcing bars. Provide 2 inches minimum cover. Anchor all reinforcement to prevent movement. Secure each section at the front, back, and at 3'-6" intervals using a method approved by the Engineer.

Possible Contract Items:

1. Concrete Barrier: BA-101
 2. Concrete Barrier: BA-102
 3. Bridge Pier
 4. Reinforced Paved Shoulder
 5. FCC Median Concrete Cap, 4 in.
- ① Barrier Markers

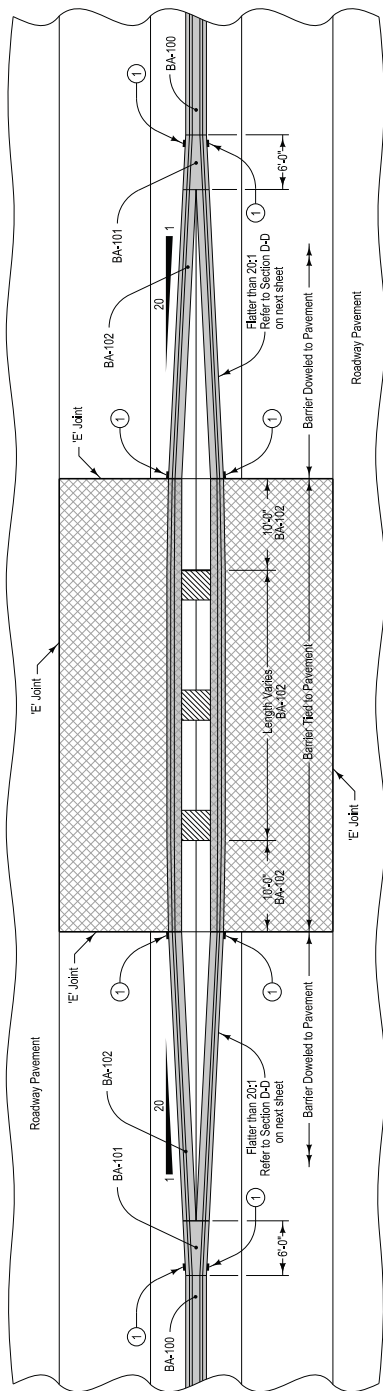

Reinforced Paved Shoulder
BA-106 (Refer to U.5)

PLAN

Refer to Standard Road Plans BA-100, BA-101, BA-102, and BA-106 for additional concrete barrier labels.

HRG-CMB-6

CONCRETE BARRIER AT
BRIDGE PIER
1306+37
(SHEET 1 OF 2)

SHEET NUMBER U. 15

PROJECT NUMBER IM-NHS-029-6(223)143-03-97

WOODBURY COUNTY

Schoenrock \ HR Green, Inc.

DESIGN TEAM

ENGLISH

10:53:14 AM

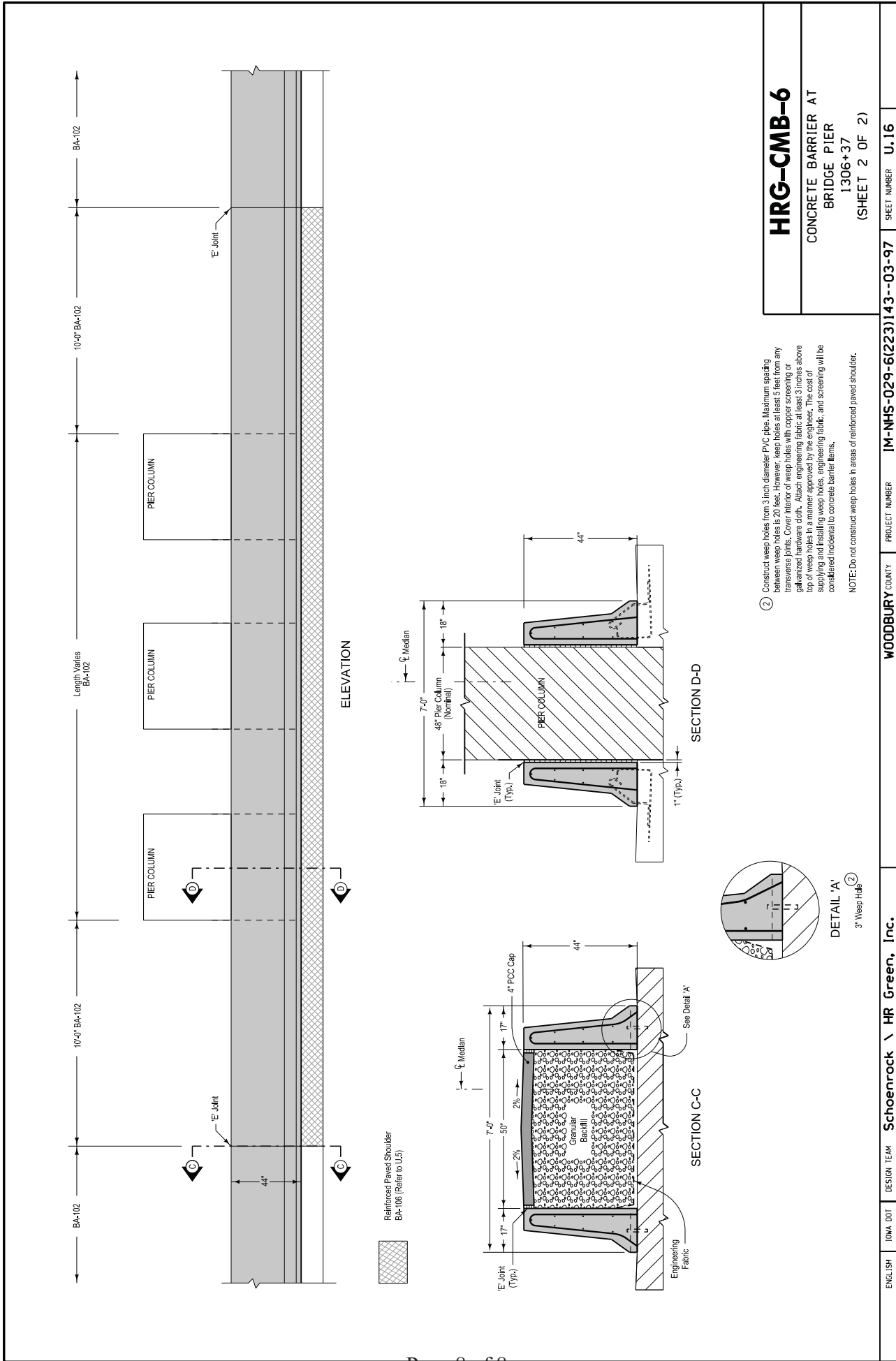

HRG-CMB-6
CONCRETE BARRIER AT
BRIDGE PIER
 1306+37
 (SHEET 2 OF 2)

SHEET NUMBER **U.16**

PROJECT NUMBER **IM-NHS-029-6(223)143-03-97**

WOODBURY COUNTY

DESIGN TEAM **Schoenrock \ HR Green, Inc.**

DATE DOT **amuerich**

10:53:15 AM

10:53:15 AM