

A d d e n d u m

Iowa Department of Transportation
Office of Contracts

Date of Letting: January 18, 2017
Date of Addendum: December 27, 2016

B.O.	Proposal ID	Proposal Work Type	County	Project Number	Addendum
105	56-8290-601	PCC PAVEMENT - GRADE & REPLACE	LEE	STP-U-8290(601)--70-56	18JAN105A01

REPLACE plan sheets M.01, M.02, & M.3 with the attached:

Sheet M.01 - Structure ST-2 Rim height in profile changed from 758.54 to 763.07.

Sheet M.02 - Structure ST-6 Rim height in profile changed from 755.95 to 758.00.

Sheet M.03 – In the Storm Sewer Structure Table column Top of Curb or Rim Elevation changed for ST-2 and ST-6.

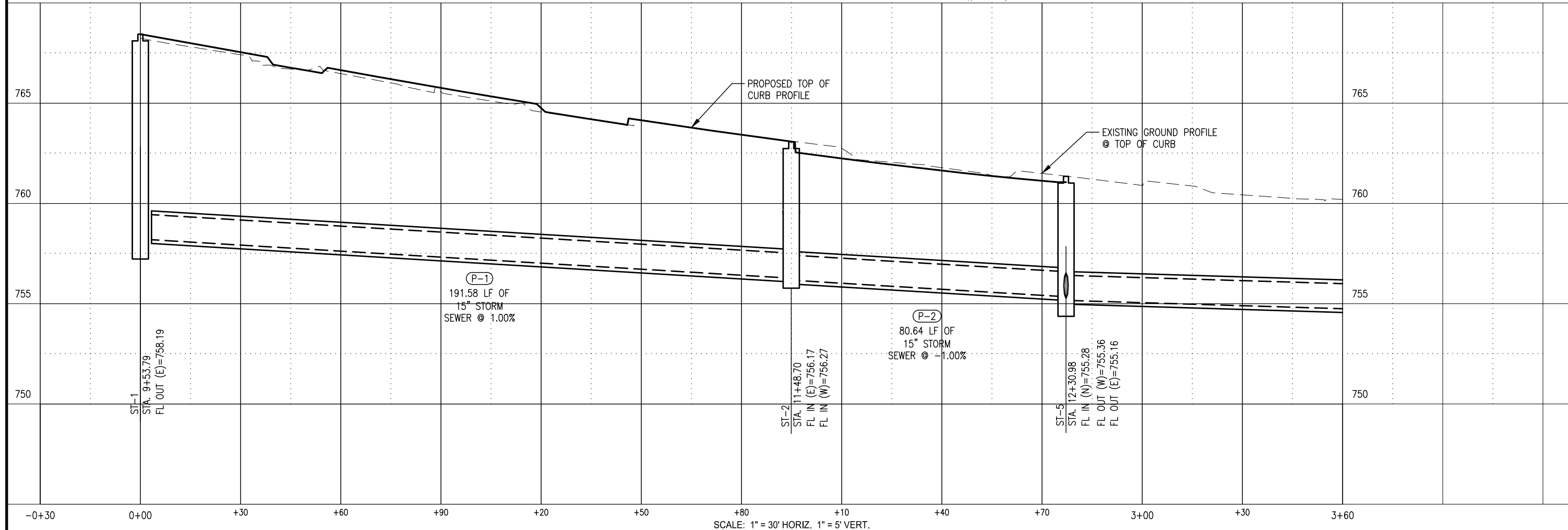
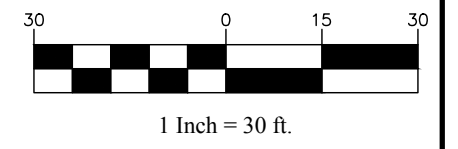
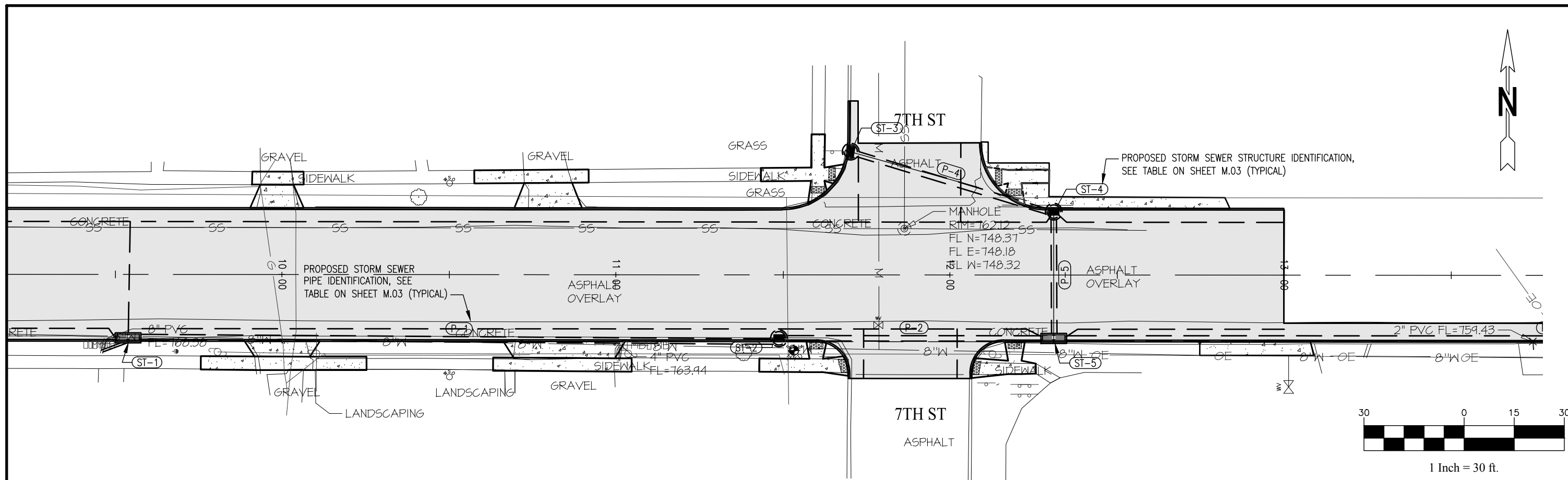

SCALE: 1" = 30' HORIZ. 1" = 5' VERT.

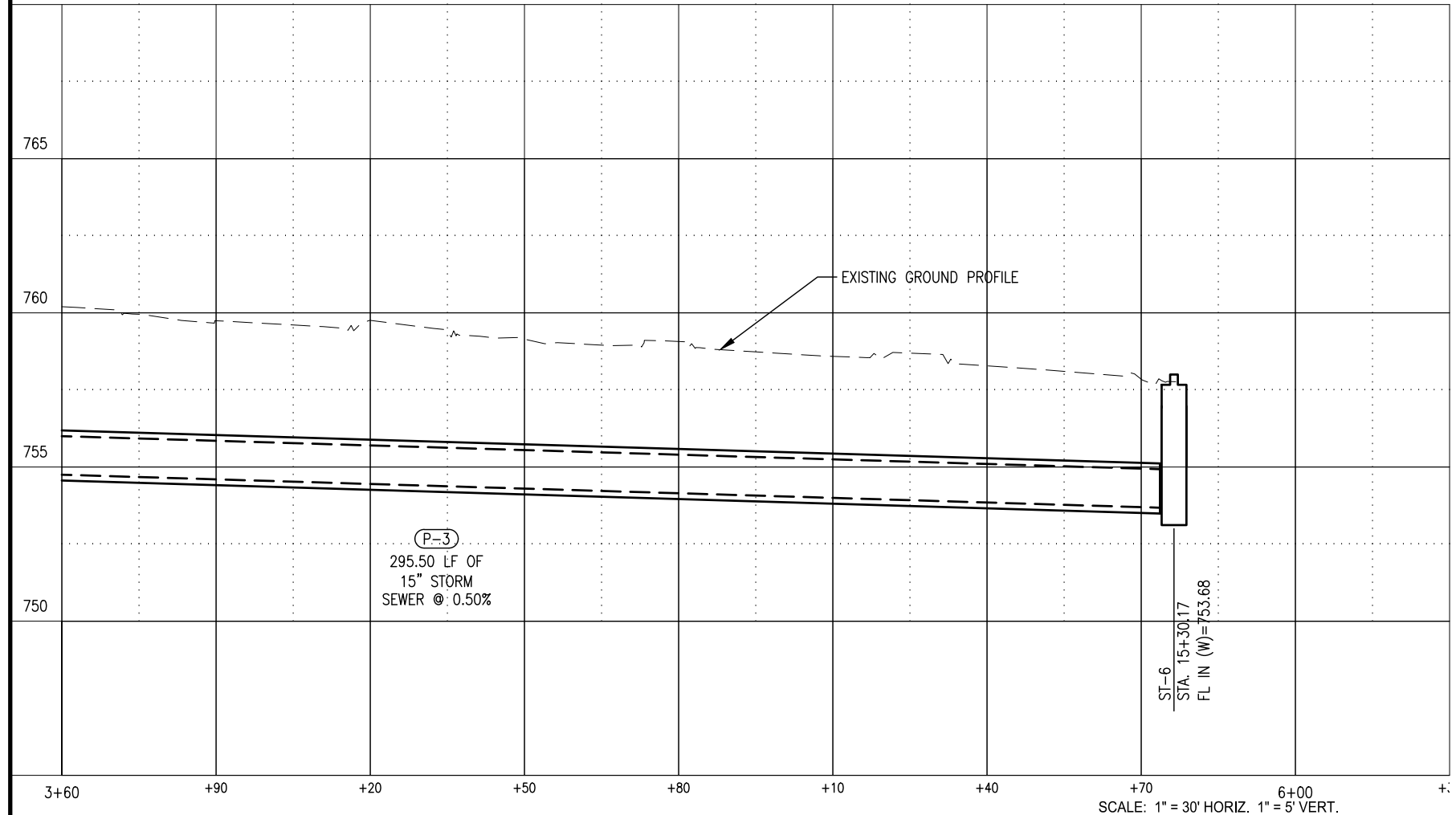
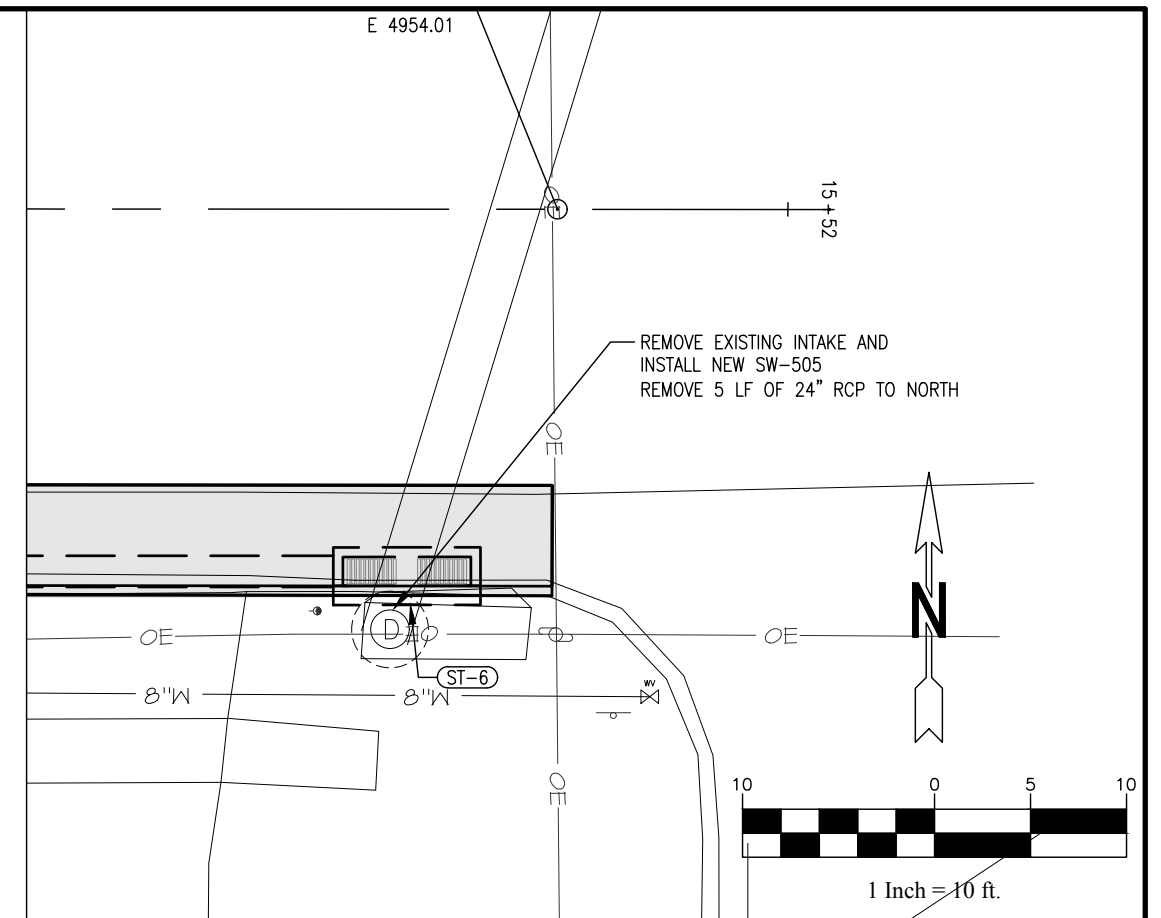
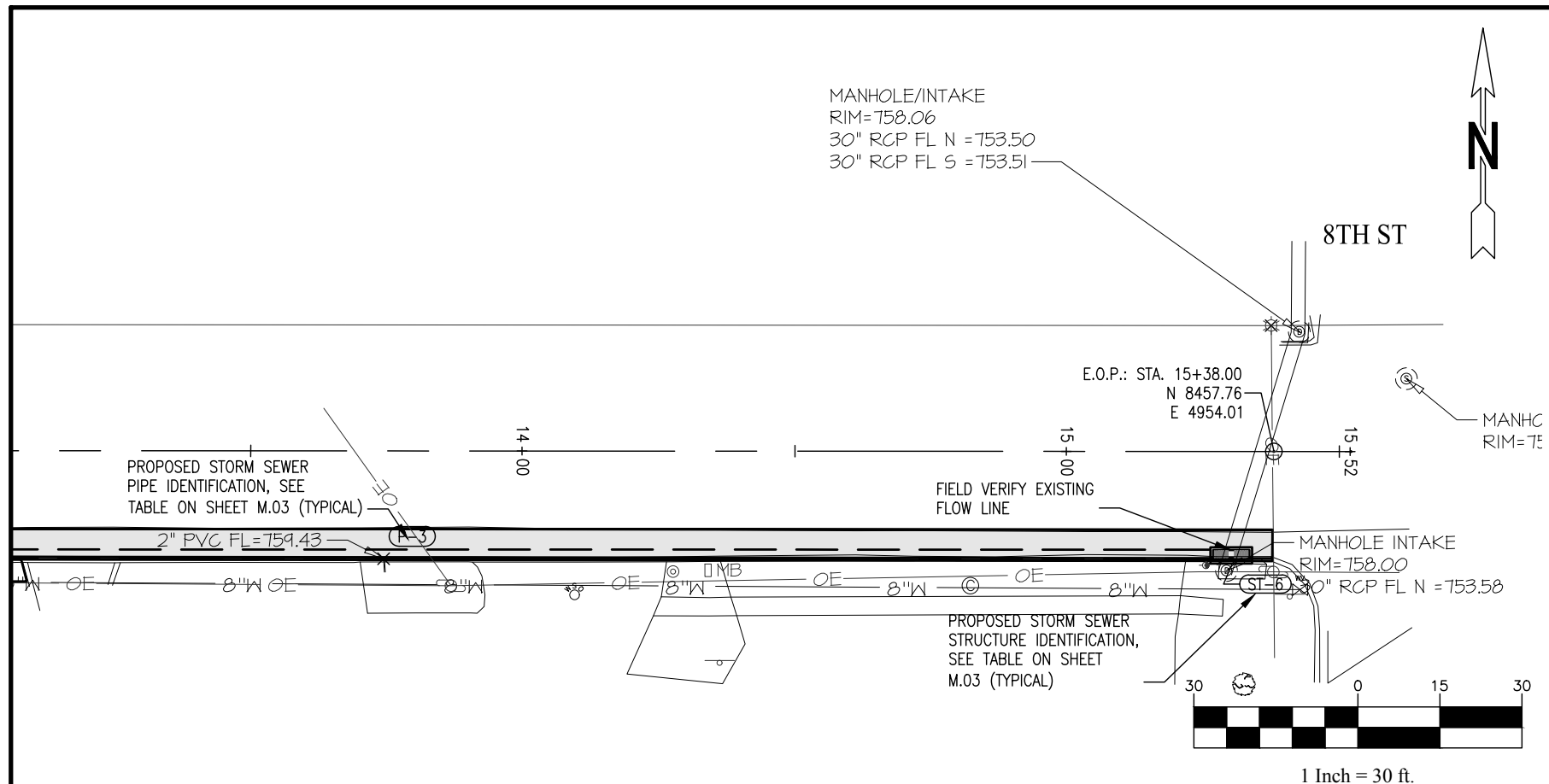

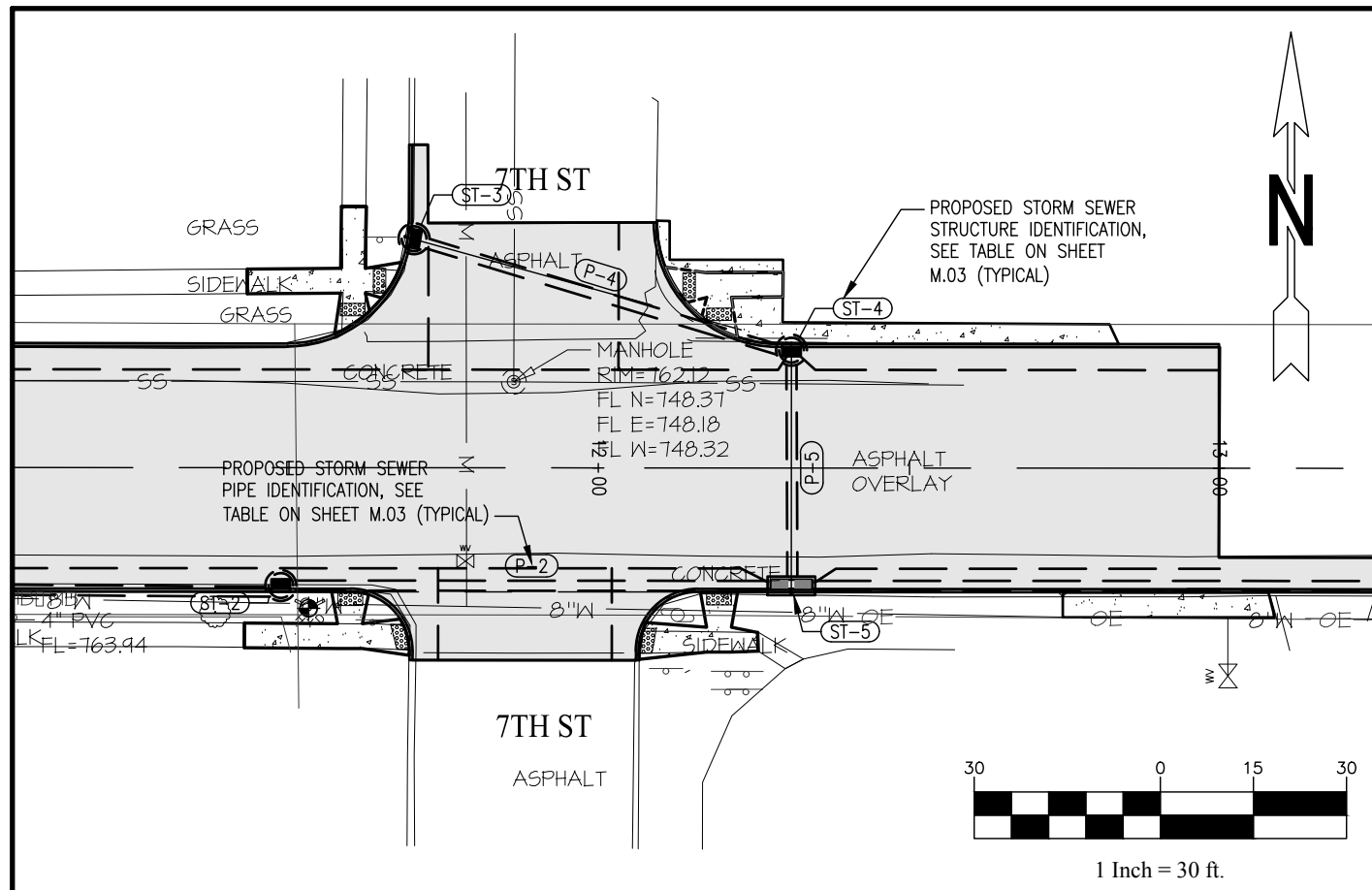

STORM SEWER STRUCTURE TABLE						
STRUCTURE NO.	NORTHING	EASTING	STATION	OFFSET FROM \varnothing	TOP OF CURB OR RIM ELEV.	STRUCTURE TYPE
ST-1	8438.14	4369.78	9+53.79	20.00' RT.	768.44	SW-505
ST-2	8438.01	4564.69	11+48.70	20.00' RT.	763.07	SW-502 48"
ST-3	8495.09	4585.17	11+69.14	37.09' LT.	762.13	SW-502 48"
ST-4	8477.96	4646.97	12+30.96	20.00' LT.	761.35	SW-502 48"
ST-5	8437.96	4646.97	12+30.98	20.00' RT.	761.35	SW-505
ST-6	8437.65	4946.16	15+30.17	20.11' RT.	758.00	SW-505

STORM SEWER PIPE TABLE								
PIPE	DIAMETER	MATERIAL	FROM	TO	LENGTH	SLOPE	PIPE \varnothing IN	PIPE \varnothing OUT
P-1	15"	Reinforced Concrete	ST-1	ST-2	191.6 LF	1.00%	758.19	756.27
P-2	15"	Reinforced Concrete	ST-2	ST-5	80.6 LF	-1.00%	756.17	755.36
P-3	15"	Reinforced Concrete	ST-5	ST-6	295.5 LF	0.50%	755.16	753.68
P-4	15"	Reinforced Concrete	ST-3	ST-4	63.0 LF	0.50%	755.88	755.56
P-5	15"	Reinforced Concrete	ST-4	ST-5	36.0 LF	0.50%	755.46	755.28

