

A d d e n d u m

Iowa Department of Transportation
Office of Contracts

Date of Letting: October 18, 2016
Date of Addendum: October 11, 2016

B.O.	Proposal ID	Proposal Work Type	County	Project Number	Addendum
005	31-2100-664	BRIDGE NEW - PPCB	DUBUQUE	HDP-2100 (664)—71-31	18OCT005A01

Make the following changes to the PROPOSAL SPECIAL PROVISIONS LIST & TEXT:

Delete 005.0014 DIGITAL SIGNING OF CONTRACT AND PERFORMANCE BOND THROUGH DOC EXPRESS

Effective Date: August 16, 2016

Make the following changes to the plans:

Replace SHEET NUMBER C.11, J.1 and J.3 with the attached C.11, J.1 and J.3

ROCK EROSION CONTROL

Refer to EC-301

Location				Rock Erosion Control (REC)		Material Bid Quantities			Remarks					
Road Identification	Begin Station	End Station	Side Lt./Rt.	L FT	W FT	Type 1	Type 2	Type 3		Type 4	Type 5	Erosion Stone	Class E Revetment	Eng. Fabric
						Rock Ditch Check	Rock Ditch	Rock Flume		Rock Splash Basin	Rock Slope Protection	TON	TON	SY
	307+30.00	307+30.00	RT	7	11					1		9.2		11.7
SW Arterial	308+00.00	308+00.00	RT	11	10				1		13.2		17.1	
SW Arterial	311+26.55	311+26.55	LT	13	15				1			21.5	27.4	
SW Arterial	312+00.00	312+00.00	RT	11	7				1		9.2		13.4	
Detour Road	3+30.00	3+30.00	LT	12	8				1		11.5		16.0	
Detour Road	9+00.00	9+00.00	LT	10	8				1		9.6		13.3	
Military Road-O.R.	2039+41.65	2039+41.65	LT	12	6				1		8.6		13.3	
Bike-7	7309+26.98	7309+26.98	LT	10	5				1		6.0		10.0	
Final Stabilization														
Detour Road	2+05.00	2+05.00	LT	22	4	1					15.8		19.6	
Detour Road	2+25.00	2+25.00	LT	22	4	1					15.8		19.6	
Detour Road	2+45.00	2+45.00	LT	22	4	1					15.8		19.6	
Detour Road	2+65.00	2+65.00	LT	22	4	1					15.8		19.6	
Detour Road	3+40.00	3+40.00	LT	22	4	1					15.8		19.6	
Detour Road	3+65.00	3+65.00	LT	22	4	1					15.8		19.6	
Detour Road	4+50.00	4+50.00	RT	22	4	1					15.8		19.6	
Detour Road	4+70.00	4+70.00	RT	22	4	1					15.8		19.6	
Detour Road	4+90.00	4+90.00	RT	22	4	1					15.8		19.6	
Detour Road	5+10.00	5+10.00	RT	22	4	1					15.8		19.6	
Detour Road	5+30.00	5+30.00	RT	22	4	1					15.8		19.6	
Detour Road	5+50.00	5+50.00	RT	22	4	1					15.8		19.6	
Detour Road	5+70.00	5+70.00	RT	22	4	1					15.8		19.6	
Detour Road	5+90.00	5+90.00	RT	22	4	1					15.8		19.6	
Detour Road	6+10.00	6+10.00	RT	22	4	1					15.8		19.6	
Military Road-O.R.	2044+60.00	2044+60.00	LT	70	8			1			84.0		108.9	
Military Road-O.R.	2044+85.00	2044+85.00	RT	28	4	1					20.2		24.9	
Military Road-O.R.	2045+10.00	2045+10.00	RT	28	4	1					20.2		24.9	
Military Road-O.R.	2045+35.00	2045+35.00	RT	28	4	1					20.2		24.9	
Military Road-O.R.	2045+60.00	2045+60.00	RT	28	4	1					20.2		24.9	
Military Road-O.R.	2045+85.00	2045+85.00	RT	28	4	1					20.2		24.9	
Military Road-O.R.	2046+10.00	2046+10.00	RT	28	4	1					20.2		24.9	
Military Road-O.R.	2046+35.00	2046+35.00	RT	28	4	1					20.2		24.9	
Military Road-O.R.	2046+60.00	2046+60.00	RT	28	4	1					20.2		24.9	
Military Road-O.R.	2046+85.00	2046+85.00	RT	28	4	1					20.2		24.9	
Military Road-O.R.	2047+10.00	2047+10.00	RT	28	4	1					20.2		24.9	
SW Arterial	301+60.00	301+60.00	RT	27	4	1					19.4		24.0	
SW Arterial	301+80.00	301+80.00	RT	27	4	1					19.4		24.0	
SW Arterial	302+00.00	302+00.00	RT	27	4	1					19.4		24.0	
SW Arterial	302+20.00	302+20.00	RT	27	4	1					19.4		24.0	
SW Arterial	302+40.00	302+40.00	RT	27	4	1					19.4		24.0	
SW Arterial	308+55.00	308+55.00	LT	22	4	1					15.8		19.6	
SW Arterial	308+75.00	308+75.00	LT	22	4	1					15.8		19.6	
SW Arterial	308+95.00	308+95.00	LT	22	4	1					15.8		19.6	
SW Arterial	309+15.00	309+15.00	LT	22	4	1					15.8		19.6	
SW Arterial	309+35.00	309+35.00	LT	22	4	1					15.8		19.6	
SW Arterial	309+55.00	309+55.00	LT	22	4	1					15.8		19.6	
SW Arterial	309+75.00	309+75.00	LT	22	4	1					15.8		19.6	
SW Arterial	309+95.00	309+95.00	LT	22	4	1					15.8		19.6	
SW Arterial	310+15.00	310+15.00	LT	22	4	1					15.8		19.6	
SW Arterial	310+35.00	310+35.00	LT	22	4	1					15.8		19.6	
SW Arterial	310+55.00	310+55.00	LT	22	4	1					15.8		19.6	
SW Arterial	310+75.00	310+75.00	LT	22	4	1					15.8		19.6	
SW Arterial	310+95.00	310+95.00	LT	22	4	1					15.8		19.6	
SW Arterial	311+15.00	311+15.00	LT	22	4	1					15.8		19.6	
SW Arterial	311+90.00	311+90.00	LT	22	4	1					15.8		19.6	
SW Arterial	312+20.00	312+20.00	LT	22	4	1					15.8		19.6	
SW Arterial	307+55.00	307+55.00	RT	22	4	1					15.8		19.6	
SW Arterial	307+75.00	307+75.00	RT	22	4	1					15.8		19.6	
SW Arterial	308+15.00	308+15.00	RT	22	4	1					15.8		19.6	
SW Arterial	308+35.00	308+35.00	RT	22	4	1					15.8		19.6	
SW Arterial	308+55.00	308+55.00	RT	22	4	1					15.8		19.6	
SW Arterial	308+75.00	308+75.00	RT	22	4	1					15.8		19.6	
SW Arterial	308+95.00	308+95.00	RT	22	4	1					15.8		19.6	
SW Arterial	309+15.00	309+15.00	RT	22	4	1					15.8		19.6	
SW Arterial	309+35.00	309+35.00	RT	22	4	1					15.8		19.6	
SW Arterial	307+30.00	307+30.00	RT	22	4	1					15.8		19.6	
SW Arterial	312+70.00	312+70.00	RT	22	4	1					15.8		19.6	
SW Arterial	313+00.00	313+00.00	RT	22	4	1					15.8		19.6	
SW Arterial	313+30.00	313+30.00	RT	22	4	1					15.8		19.6	
SW Arterial	313+60.00	313+60.00	RT	22	4	1					15.8		19.6	
SW Arterial	313+90.00	313+90.00	RT	22	4	1					15.8		19.6	
SW Arterial	314+20.00	314+20.00	RT	22	4	1					15.8		19.6	
SW Arterial	314+50.00	314+50.00	RT	22	4	1					15.8		19.6	
SW Arterial	312+90.00	312+90.00	RT	22	4	1					15.8		19.6	
SW Arterial	313+15.00	313+15.00	RT	22	4	1					15.8		19.6	
SW Arterial	313+40.00	313+40.00	RT	22	4	1					15.8		19.6	
SW Arterial	313+65.00	313+65.00	RT	22	4	1					15.8		19.6	

COORDINATED OPERATIONS

Other work in progress during the same period of time will include the construction of the projects listed. Coordinate operations with those of other contractors working within the same area.

Project	Type of Work
Southwest Arterial	Grading
East Grading Project	
From Catfish Creek to Olde Davenport Road	
NHSX-032-1(36)-3H-31	
See J-Sheets for Coordination Details.	

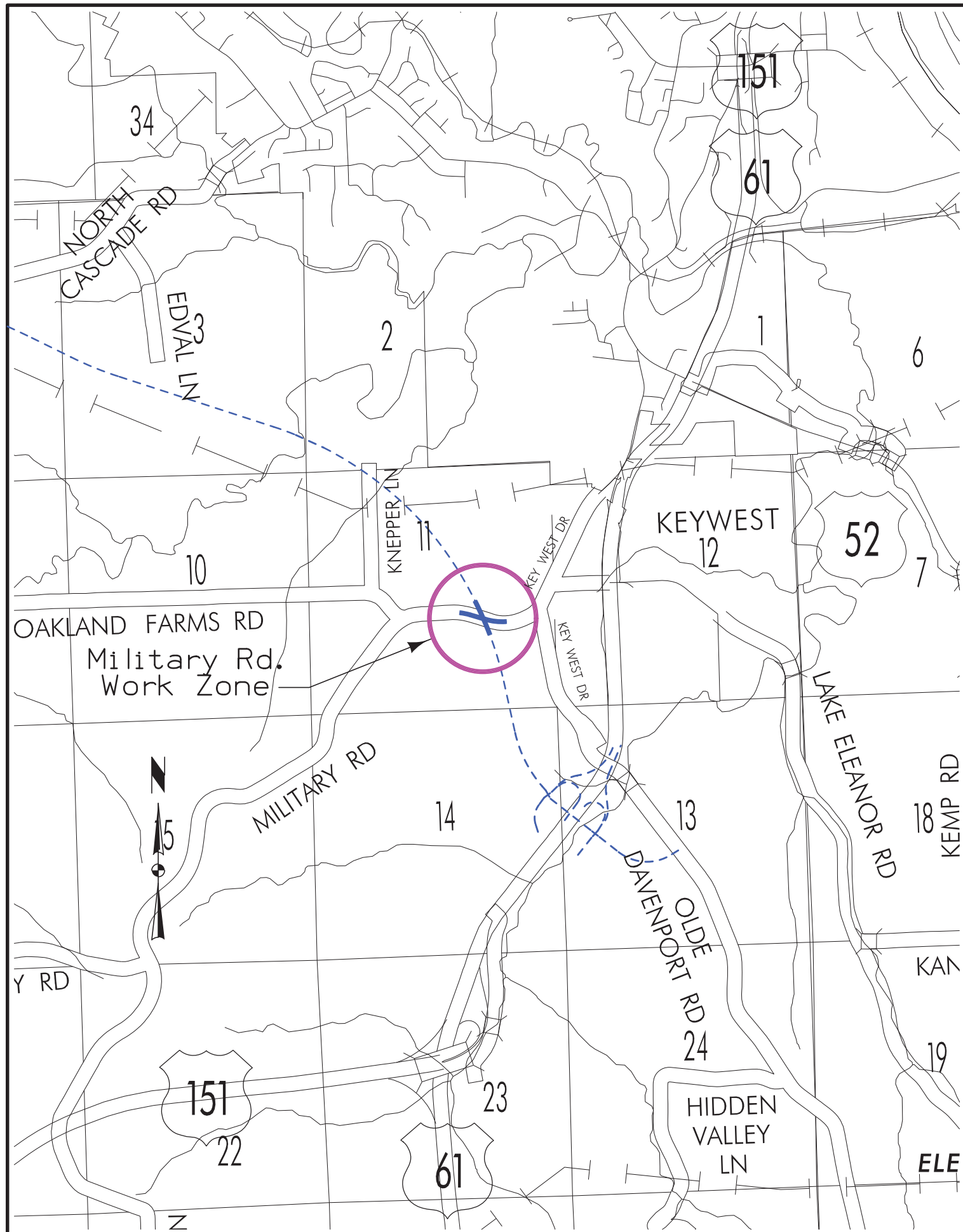

TRAFFIC CONTROL PLAN

108-23A
10-29-02

TRAFFIC CONTROL PLAN:

1. Military Road shall remain open to traffic during the road and bridge construction. Access to all driveways and access points shall be maintained by staging the construction work around the driveways.
2. An on-site detour road will be required. Contractor shall place advance signing on approaching roads as noted in TC-253.
3. A haul road across Military Road to build the Detour Road will not be allowed.

STAGING NOTES

108-26A
10-29-02

GENERAL NOTES:

All work shall be coordinated with other projects which will be under construction concurrently with this project. This may include the mainline Southwest Arterial grading and drainage project on both sides of this construction area. The contractor will coordinate all work with other contractors as needed. Traffic control and barricading measures will also be coordinated with the other contractors' traffic control measures, and will be modified as necessary if any conflicts occur.

Two-way traffic shall be provided at all times on Military Road or the on-site detour.

The contractor shall coordinate construction with the East Grading Project of Southwest Arterial (NHSX-032-1(36)3H-31) during all stages of construction. The East Grading Project is planned to be occurring concurrently with this project. The project limits for the East Grading Project are from Sta. 250+25 to Sta. 300+00 and from Sta. 315+00 to Sta. 380+49. See Staging Notes and Plan Views for each stage for additional information and notes.

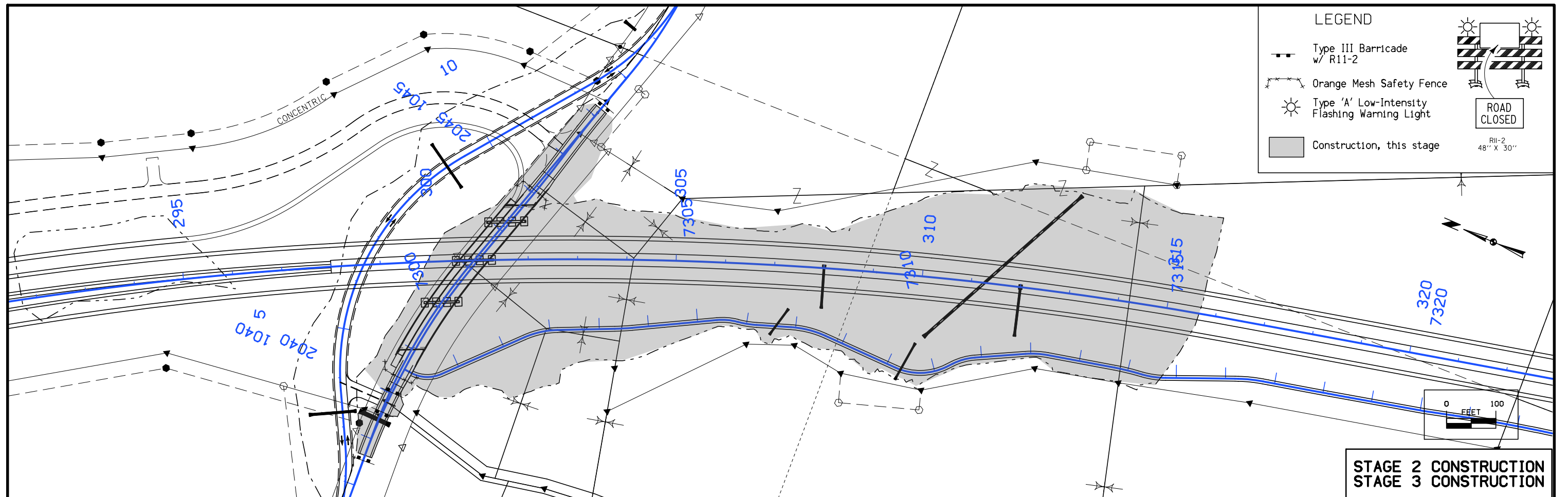

STAGING NOTES

108-26A
10-29-02

Stage 2

CONSTRUCTION STAGING PLAN:

Traffic will be shifted onto the detour road. Refer to TC-253 for traffic control details.

Saw cut and remove existing pavement on Military Road from Sta. 2038+63.89 to Sta. 2047+18.32.

Grade Southwest Arterial, including the bridge abutments, from Sta. 300+00 to Sta. 315+50.

Grade Recreational Trail from Sta. 7299+00.53 to Sta. 7316+00.00.

Construct culverts and median drain.

Install Permanent Soil Nail Slope Reinforcement and Reinforced Vegetation System on exposed shale backslopes along Southwest Arterial.

Complete the slope finishing, topsoil placement and final seeding.

Construct Military Road bridge.

Access to properties shall remain open during construction. Construction activities shall be staged to provide continuous access

A haul road across the detour road will not be allowed.

Stage 3

CONSTRUCTION STAGING PLAN

Traffic will remain on the Detour Road as described in Stage 2.

Grade and Pave Military Road from Sta. 2038+63.89 to Sta. 2041+02.66 and from Sta. 2044+68.35 to Sta. 2047+18.32.