

A d d e n d u m

Iowa Department of Transportation
Office of Contracts

Date of Letting: September 20, 2016
Date of Addendum: September 15, 2016

B.O.	Proposal ID	Proposal Work Type	County	Project Number	Addendum
301	27-0351-179	SLIDE REPAIR	DECATUR	IMN-035-1(179)13--0E-27	20SEP301A01

Make the following changes to the PLAN:

Replace SHEETS B.1, J.3 and J.4 with the attached SHEETS B.1, J.3 and J.4

Add attached Sheet J.1

LOCATION				DIMENSIONS	
INTERCHANGE	RAMP	STATION TO STATION		Ⓡ Feet	Ⓞ Feet
IA 2	C	3566+25	3571+00	4	2

① See Q sheet for additional notes.

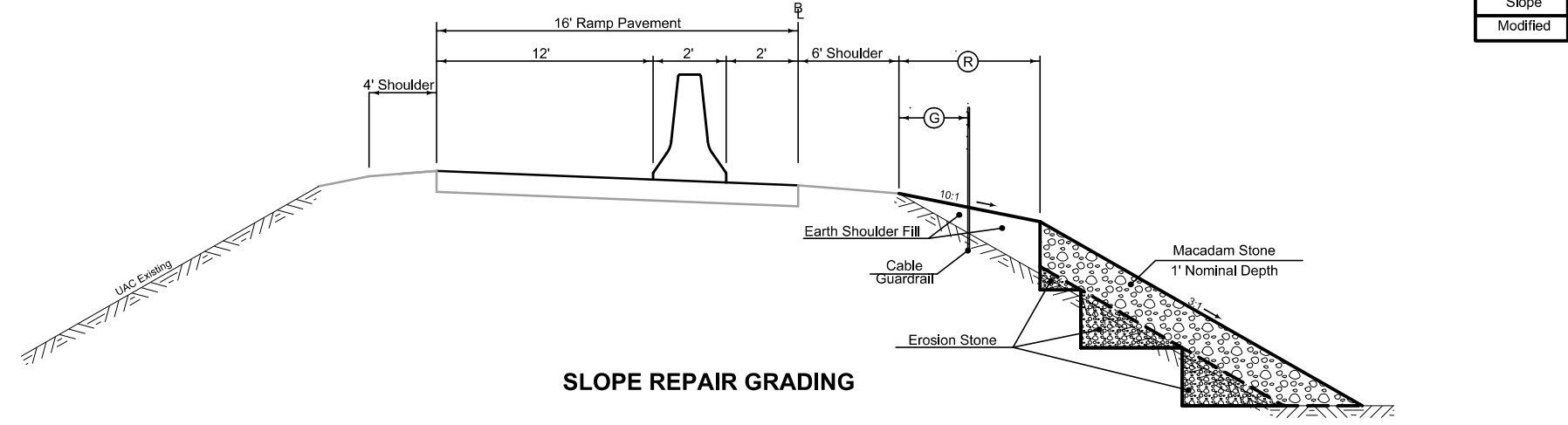

Slope Modified

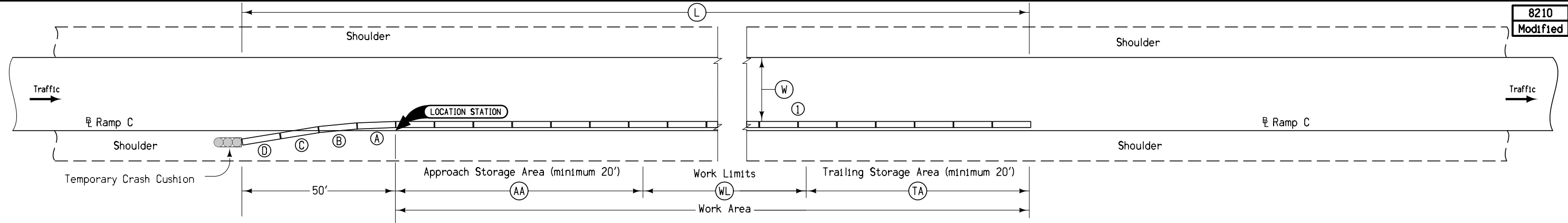

8210 Modified

① Where (W) is less than 14'-6", install restricted width signing as per Standard Road Plan TC-81.

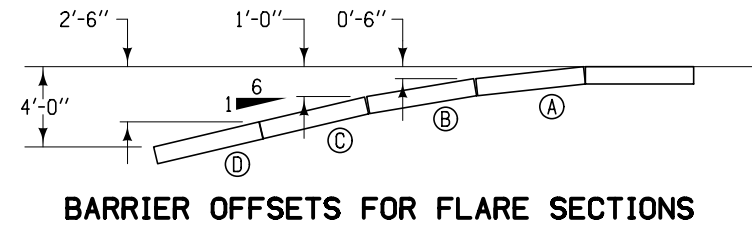

Station	Side	Ⓡ	Ⓞ	Ⓣ	Ⓛ	Anchored	Ⓢ	Remarks
		Feet	Feet	Feet	Feet	X	Ft-Inches	
3566+05 to 3571+20	Rt.	20	475	20	515	465	12	

TEMPORARY CONCRETE BARRIER LAYOUT for One-Way Traffic

108-23A
08-01-08

TRAFFIC CONTROL PLAN

Traffic shall be maintained on Ramp at all times.

108-26A
08-01-08

STAGING NOTES

Stage 1
See Typical Slope and Typical 8210 in the B Sheets, plus J sheets for traffic control.
A) Reconstruct Foreslope and Box Repair work.

Stage 2
See Road Standard TC-416 for traffic control.
A) Paved shoulder, guardrail and all remaining work.

108-25
10-21-14

511 TRAVEL RESTRICTIONS

Route	Direction	County	Location Description	Feature Crossed	Object Type	Maint. Bridge No., Structure ID, or FHWA No.	Type of Restriction	Existing Measurement	Construction Measurement	Construction Measurement as Signed	Projected As Built Measurement	Remarks
IA 2/I-35	Ramp C	Decatur	No Travel Restrictions Expected									

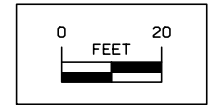
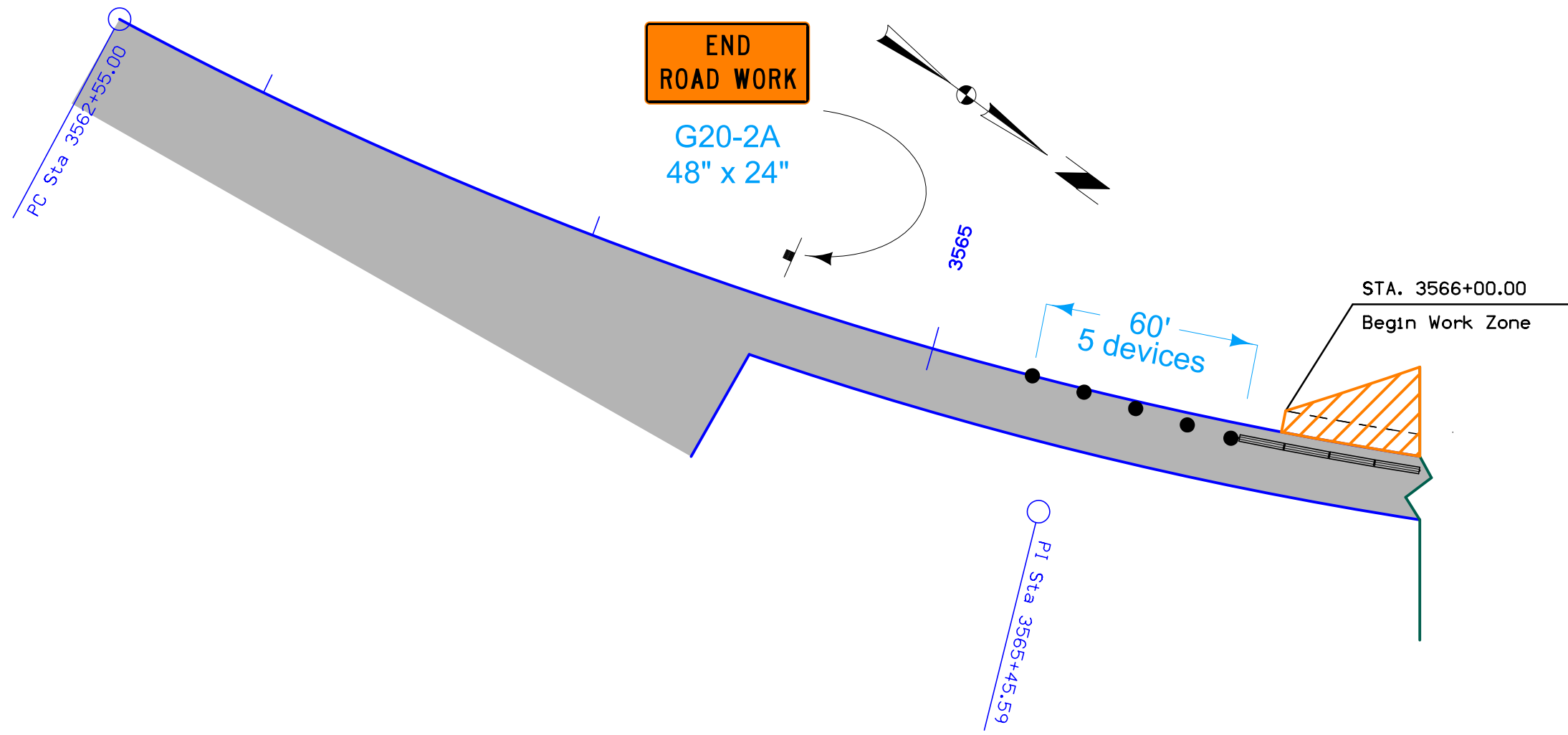

**Ramp C
Traffic Control
Sheet 1 of 2**

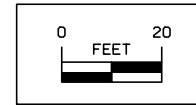
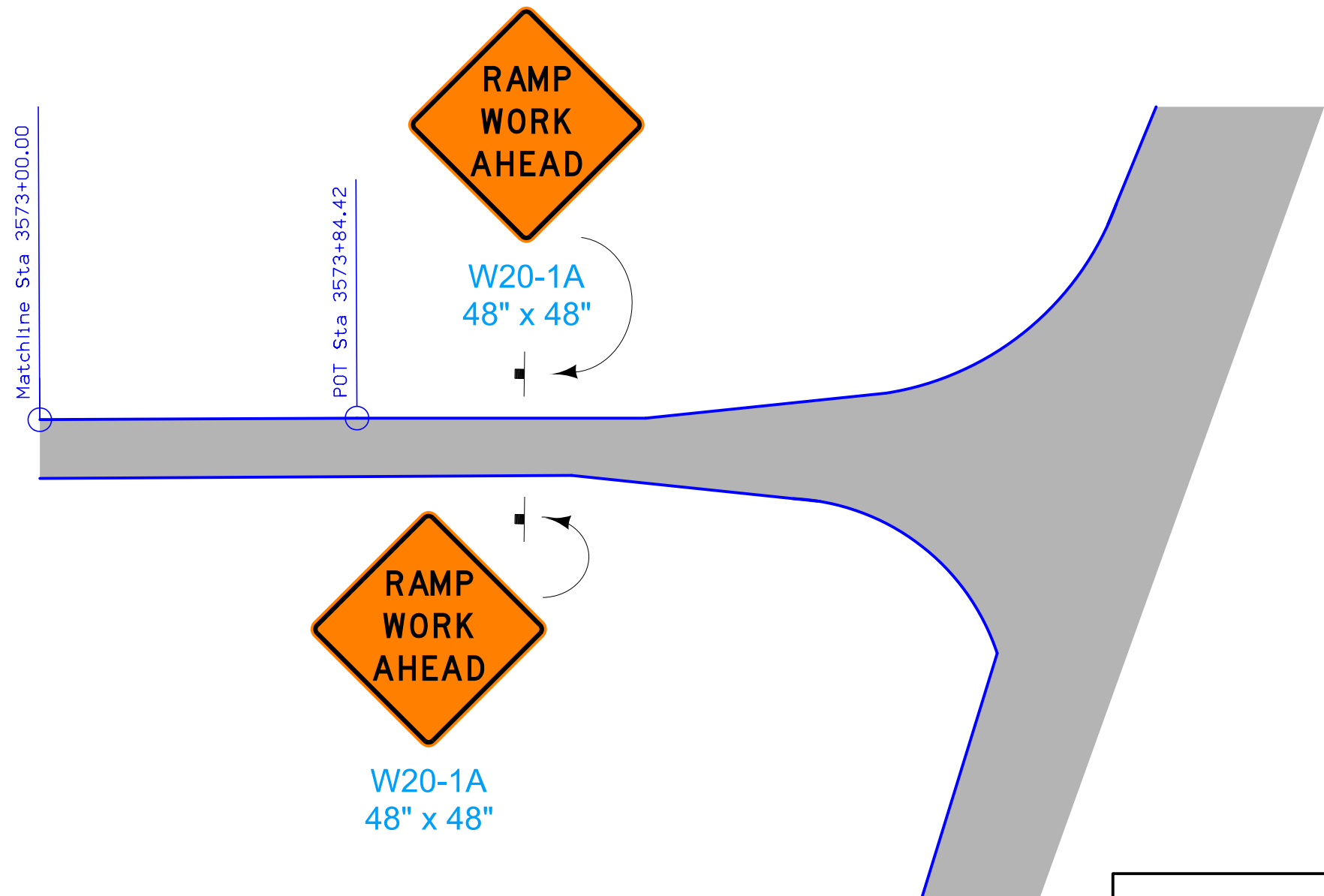
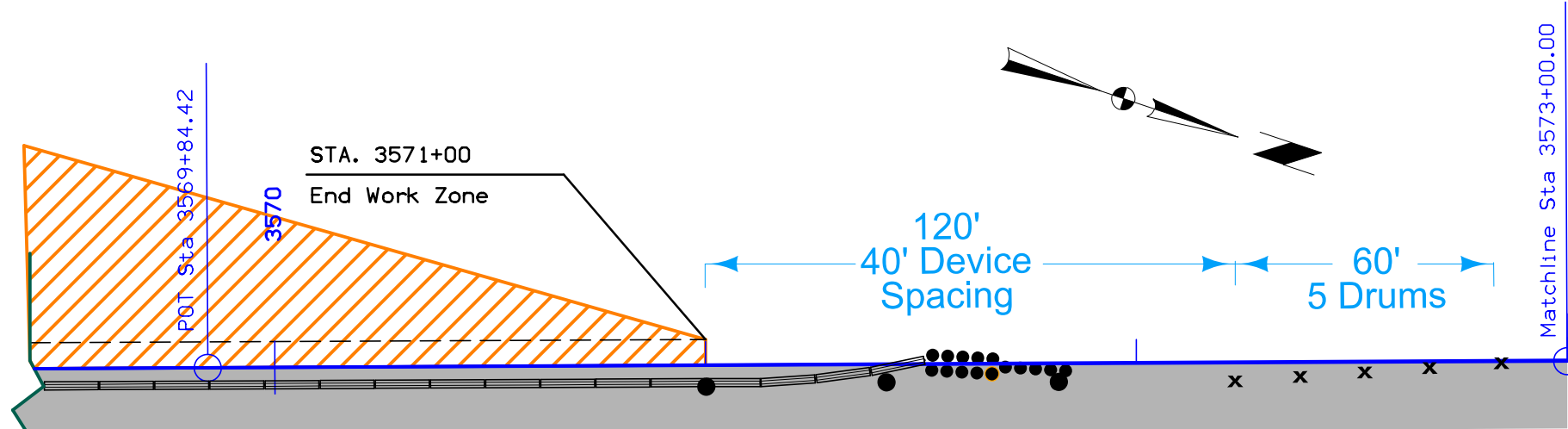

**Ramp C
Traffic Control
Sheet 2 of 2**