

A d d e n d u m

Iowa Department of Transportation
Office of Contracts

Date of Letting: July 21, 2015
Date of Addendum: June 26, 2015

B.O.	Proposal ID	Proposal Work Type	County	Project Number	Addendum
104	08-0304-089	PCC PAVEMENT - GRADE & REPLACE	BOONE	TSF-030-4(89)--92-08	21JUL104.A01

Make the following changes to the PROPOSAL SCHEDULE OF PRICES:

Add Proposal Line No. 0281 2214-5145150 PAVEMENT SCARIFICATION; 885.000 SY

If the above changes are not made, they will be made as shown here.

REPLACE plan sheets C.1 & L.3 with the attached.

C.1: The following Bid Item, Estimated Quantity and corresponding Estimate Reference Notes were added. 2214-5145150 PAVEMENT SCARIFICATION 885.0 SY

L.3: A typo was fixed on sheet L.3.

ESTIMATED PROJECT QUANTITIES (1 DIVISION PROJECT)			
Item No.	Item Code	Item	As Built Qty.
1	2101-0859002	CLEARING AND GRUBBING	37
2	2102-0425070	SPECIAL BACKFILL	332.0
3	2102-2625000	EMBANKMENT-IN-PLACE	1,931.0
4	2102-2713070	EXCAVATION, CLASS 13, ROADWAY AND BORROW	440.0
5	2105-8425015	TOPSOIL, STRIP, SALVAGE AND SPREAD	866.0
6	2121-7425010	GRANULAR SHOULDERS, TYPE A	592.0
7	2121-0425095	CLEANING AND PREPARATION OF BASE	1.0
8	2121-0425095	CLEANING AND PREPARATION OF BASE	1.0
9	2213-8240000	BASE WIDENING, HOT MIX ASPHALT MIXTURE	273.0
10	2214-5145150	PAVEMENT SCARIFICATION	885.0
11	2303-0652500	HOT MIX ASPHALT MIXTURE (10,000,000 ESAL), INTERMEDIATE COURSE, 1/2 IN. MIX	124.0
12	2303-0653593	HOT MIX ASPHALT MIXTURE (10,000,000 ESAL), SURFACE COURSE, 1/2 IN. DIA.	196.0
13	2303-0246428	ASPHALT BINDER, PG 64-28	35.6
14	2303-6911000	HOT MIX ASPHALT PAVEMENT SAMPLES	1.00
15	2502-8212034	SUBDRAIN, LONGITUDINAL, (SHOULDER) 4 IN. DIA.	1,200.0
16	2502-8212303	SUBDRAIN OUTLET, DR-303	4
17	2507-3250005	ENGINEERING FABRIC	606.0
18	2507-6800061	REVEIMENT, CLASS E	416.0
19	2534-6750910	REMOVE AND REINSTALL SIGN AS PER PLAN	398.1
20	2524-6750910	REMOVE AND REINSTALL SIGN AS PER PLAN	1.00
21	2526-8285000	CONSTRUCTION SURVEY	1.00
22	2527-9263109	PAINTED PAVEMENT MARKING, WATERBORNE OR SOLVENT-BASED	51.00
23	2528-8445110	TRAFFIC CONTROL	1.00
24	2528-8445113	FLAGGERS	See Proposal
25	2533-4980005	MOBILIZATION	1.00
26	2602-0000020	SILT FENCE FOR DITCH CHECKS	1,378.0
27	2602-0000020	MOBILIZATIONS, EMERGENCY EROSION CONTROL	728.0
28	2602-0010010	MOBILIZATIONS, EMERGENCY EROSION CONTROL	1
29	2602-0010020	MOBILIZATIONS, EMERGENCY EROSION CONTROL	1

ESTIMATE REFERENCE INFORMATION			
Item No.	Item Code	Description	
1	2101-0859002	CLEARING AND GRUBBING Existing trees & brush are located along the existing ditches & near inlet of existing 66" pipe (Sta. 1021+90 Lt. Exact trees/brush locations will be flagged by the engineer.	100-1A 10-29-02
2	2102-0425070	SPECIAL BACKFILL See Typical LRTL-1 on B.1.	
3	2102-2625000	EMBANKMENT-IN-PLACE Estimated quantity includes 0 Cut & 1931 cu. yds. Fill required. Contractor shall provide all project embankment needs; see cross sections & typical LRTL-1 on B.1.	
4	2102-2713070	EXCAVATION, CLASS 13, ROADWAY AND BORROW See cross sections & typical LRTL-1 on B.1.	
5	2105-8425015	TOPSOIL, STRIP, SALVAGE AND SPREAD Estimated for 12" thick removal and 8" thick replacement. See cross sections.	
6	2121-7425010	GRANULAR SHOULDERS, TYPE A See cross sections & typical LRTL-1 on B.1.	
7	2123-7450020	SHOULDER FINISHING, EARTH See cross sections & typical LRTL-1 on B.1.	
8	2212-0475095	CLEANING AND PREPARATION OF BASE This bid item includes all areas to receive HMA Surface course material.	
9	2213-8240000	BASE WIDENING, HOT MIX ASPHALT MIXTURE See "H" sheets & typical LRTL-1 on B.1. Estimated for 8226 sq. ft. at 5.5" thick and 145 pounds/cu. ft.	
10	2214-5145150	PAVEMENT SCARIFICATION See sheets L.1-2.	

ESTIMATE REFERENCE INFORMATION			
Item No.	Item Code	Description	
11	2303-0652500	HOT MIX ASPHALT MIXTURE (10,000,000 ESAL), INTERMEDIATE COURSE, 1/2 IN. MIX See sheets C.1-C.2 & typical LRTL-1 on B.1. Estimated for 8226 sq. ft. at 2.5" thick and 145 pounds/cu. ft.	100-1A 10-29-02
12	2303-0653593	HOT MIX ASPHALT MIXTURE (10,000,000 ESAL), SURFACE COURSE, 1/2 IN. MIX, FRICTION L-3 See "L" sheets & typical LRTL-1 on B.1. Estimated for (8226 + 7963) sq. ft. at 2.0" thick and 145 pounds/cu. ft.	
13	2303-0246428	ASPHALT BINDER, PG 64-28 Estimated at 6% of HMA tons for: Base widening, Intermediate and Surface	
14	2303-6911000	HOT MIX ASPHALT PAVEMENT SAMPLES	
15	2502-8212034	SUBDRAIN, LONGITUDINAL, (SHOULDER) 4 IN. DIA.	
16	2502-8212303	SUBDRAIN OUTLET, DR-303 Installation placed 36" deep. Place single outlets at beginning and end points and double outlets at midpoint of subdrain installation; see typical section on B.1.	
17	2507-3250005	ENGINEERING FABRIC	
18	2507-6800061	REVEIMENT, CLASS E See "R" sheets and tab. 100-23 on sheet C.2. Revetment quantity assumes all new material however, approximately 75% of this material may be salvaged and reused from the existing rock lined ditches within the limits of the proposed ditch. Payment for revetment will only be for tons of new material accepted & placed on the project.	
19	2510-6745850	REMOVAL OF PAVEMENT See tab. 11-1 sheet C.3, sheets L.1-2.	
20	2524-6750910	REMOVE AND REINSTALL SIGN AS PER PLAN Refer to Tab. 100-10 with sheet C.2 for traffic control to provide more room for trucks turning NB US30 to NB Swedden at existing Stop sign located on raised stop island on Snedden Dr. at US 30 (north side of westbound US 30). Measurement and payment will be for removal, storage and replacement per MUTCD of all signs at this one location plus their support posts and all hardware. Item includes replacing signs, support posts and hardware with new if they are or become damaged while in the contractor's care.	
21	2526-8285000	CONSTRUCTION SURVEY See "G" sheets.	
22	2527-9263109	PAINTED PAVEMENT MARKING, WATERBORNE OR SOLVENT-BASED Refer to Tab. 108-22 on Sheet C.2.	
23	2528-8445110	TRAFFIC CONTROL Refer to Traffic Control Plan on Sheet J.1.	
24	2528-8445113	FLAGGERS Flaggers are intended for use on Snedden Dr. and per standard road plans listed on sheet C.2. See sheet J.1.	
25	2533-4980005	MOBILIZATION This project includes incidental seeding, fertilization and mulch per standard notes on sheet C.2	
26	2602-0000020	SILT FENCE Refer to Tab. 100-17 on sheet C.2. The tabulation includes estimated locations for placement of "Silt Fence" to address erosion to be encountered during construction. Verify the specific locations with the Engineer prior to beginning placement. Bid item includes 25% additional quantity for field adjustments and replacements.	
27	2602-0000030	SILT FENCE FOR DITCH CHECKS Refer to Tab. 100-18 on sheet C.2. Locations for placement of "Silt Fence for Ditch Checks" to address erosion to be encountered during construction. Verify the specific locations with the Engineer prior to beginning placement. Bid item includes 50% additional quantity for field adjustments and replacements.	
28	2602-0010010	MOBILIZATIONS, EROSION CONTROL	
29	2602-0010020	MOBILIZATIONS, EMERGENCY EROSION CONTROL	

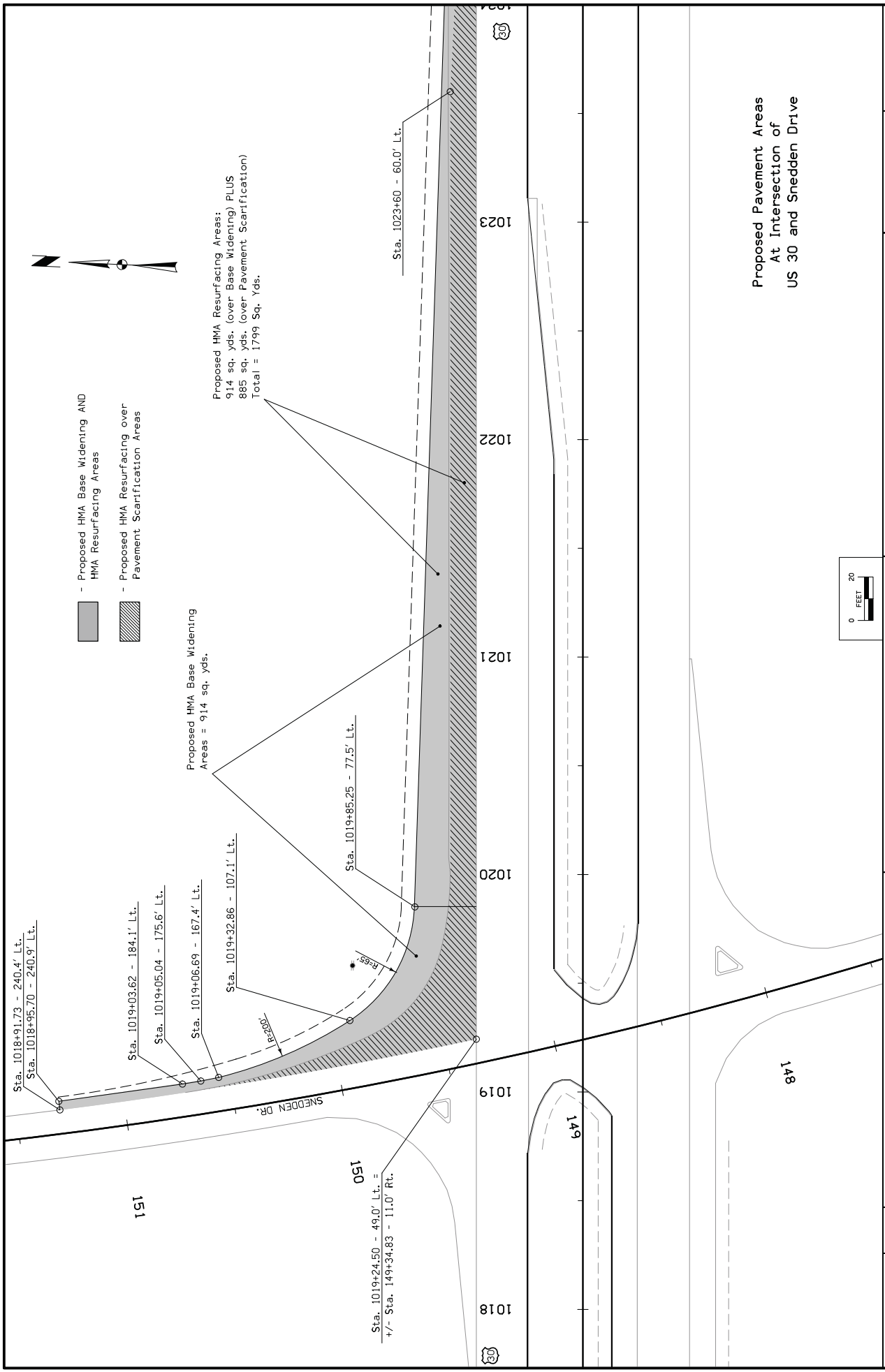

- Proposed HMA Base Widening AND HMA Resurfacing Areas
- Proposed HMA Resurfacing over Pavement Scarification Areas

Proposed HMA Resurfacing Areas:
 914 sq. yds. (over Base Widening) PLUS
 885 sq. yds. (over Pavement Scarification)
 Total = 1799 Sq. Yds.

Proposed HMA Base Widening
 Areas = 914 sq. yds.

Proposed Pavement Areas
 At Intersection of
 US 30 and Snedden Drive

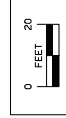

FILE NO.	ENGLISH	DESIGN TEAM	Gustafson \ Vortherms \ Ibarra	COUNTY	BOONE	PROJECT NUMBER	TSF-30-4(89)-92-08	SHEET NUMBER	L-3
1056:59 AM - 6/24/2015	r:\north	p:\projects\wise.doc\int.\anp\Main\Documents\Projects\0803002014\0istrictDesign\08030089_L03.sht							