

# A d d e n d u m

Iowa Department of Transportation  
Office of Contracts

Date of Letting: January 16, 2013  
Date of Addendum: January 14, 2013

<b>B.O.</b>	<b>Proposal ID</b>	<b>Proposal Work Type</b>	<b>County</b>	<b>Project Number</b>	<b>Addendum</b>
00A	77-0654-135-M	BRIDGE NEW - PPCB	POLK	NHSX-065-4(127)--3H-77 NHSX-065-4(135)--3H-77	16JAN00A.A03

---

Notice: Only the bid proposal holders receive this addendum and responsibility for notifying any potential subcontractors or suppliers remains with the proposal holder.

---

Make the following changes to the PROPOSAL SCHEDULE OF PRICES:

Section 0002 Roadway Items

Change Proposal Line No. 0170 2102-2710070 EXCAVATION, CLASS 10 ROADWAY AND BORROW:

From: 34,861.000CY

To: 35,457.000CY

Section 0006 Roadway Items

Change Proposal Line No. 0680 2102-2710070 EXCAVATION, CLASS 10 ROADWAY AND BORROW:

From: 43,005.000CY

To: 43,082.000CY

If the above changes are not made, they will be made as shown here.

Make the following changes to NHSX-065-4(127)--3H-77 plan sheet C.2

Add the following to the reference note: 2102-2710070 EXCAVATION, CLASS 10 ROADWAY AND BORROW

Item includes an estimated 233 cy of excavation of shale material, to be wasted, in order to remove the existing 54" pipe (refer to sheet D.2 for location). This quantity is based on a trench size of 8.5' wide at the bottom, 4' deep, and a side slope of 2:1. The trench will be left in place to facilitate drainage from the remaining western half of the 54" pipe.

Item also includes an estimated 363 cy of excavation of shale material, to be wasted, in order for Mid-American Energy Company (MEC) to remove an abandoned 8" gas line (approximately 815.7' - see sheet E.1 for location). The quantity is based on a trench size of 3' wide and 4' deep. The trench will need to be backfilled with Class 10 material (approximately 472 cy with 30% shrink) which is available on the project. Any work involved in lifting the gas line to a convenient nearby location for MEC to cut and remove from the site will be considered incidental to this item.

Replace the following plan sheets to NHSX-065-4(127)--3H-77 with the attached files:

D2 and E.1

Make the following changes to NHSX-065-4(135)--3H-77 plan sheet C.2

Add the following to the reference note: 2102-2710070 EXCAVATION, CLASS 10  
ROADWAY AND BORROW

Item also includes an estimated 77 cy of excavation of Class 10 material, to be wasted, in order to remove the existing 48" pipe at approximately Sta. 229+17 (refer to sheet D.2 for location). The excavation quantity is based on a trench size of 8' wide at the bottom, 2' deep, and a side slope of 2:1. The trench will be left in place to facilitate drainage from the remaining western half of the 48" pipe.

Replace the following plan sheet to NHSX-065-4(127)--3H-77 with the attached files:

D.2

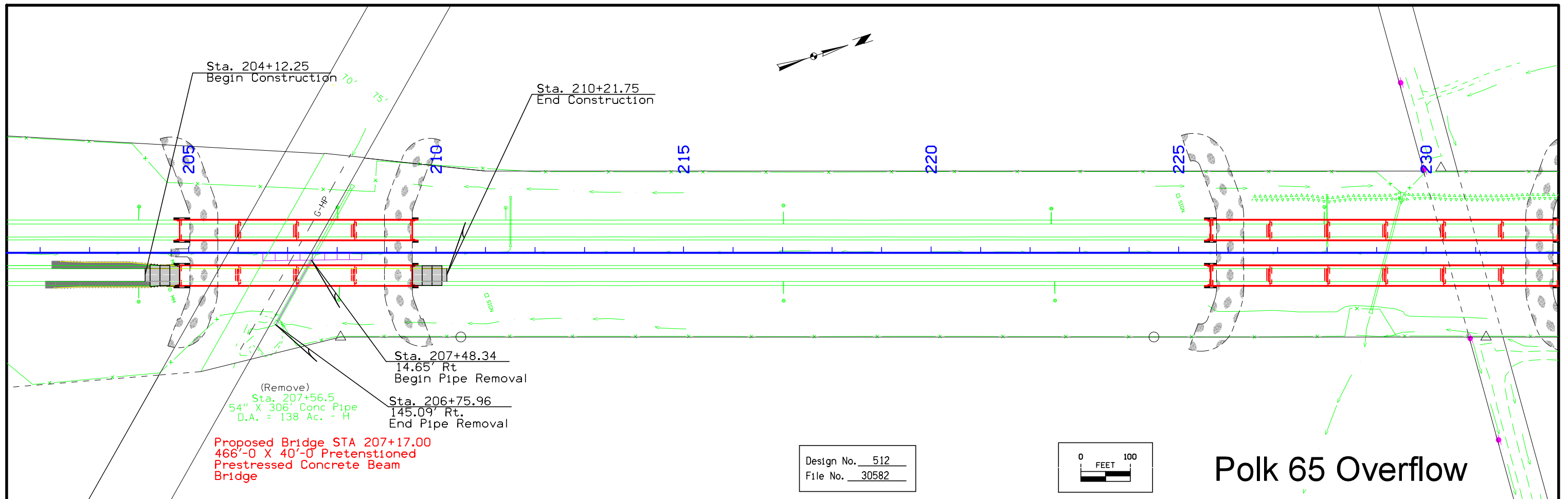

Design No. 512  
File No. 30582

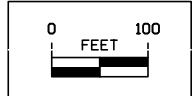

### Polk 65 Overflow

Suitable Cut = 10583 CY	Fill+30% = 262 CY
Unsuitable Cut = 24278 CY	Suitable Waste = 10321 CY
= 34861 CY	Unsuitable Waste = 24278 CY
	= 34861 CY

End (127)      Begin (135)

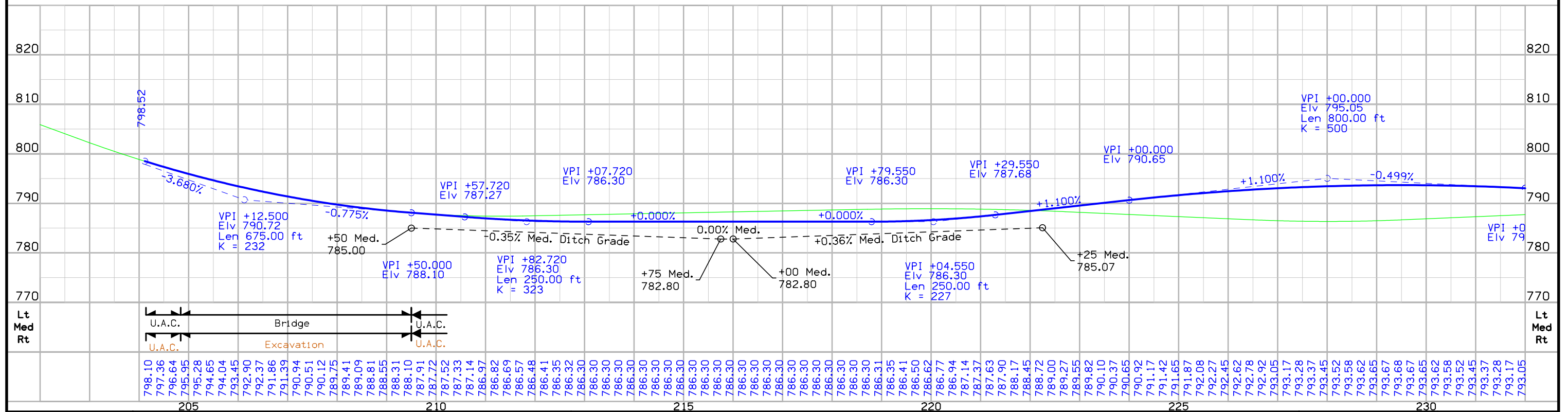



ALLEN TWP.  
T-78N R-23W  
SEC. 28

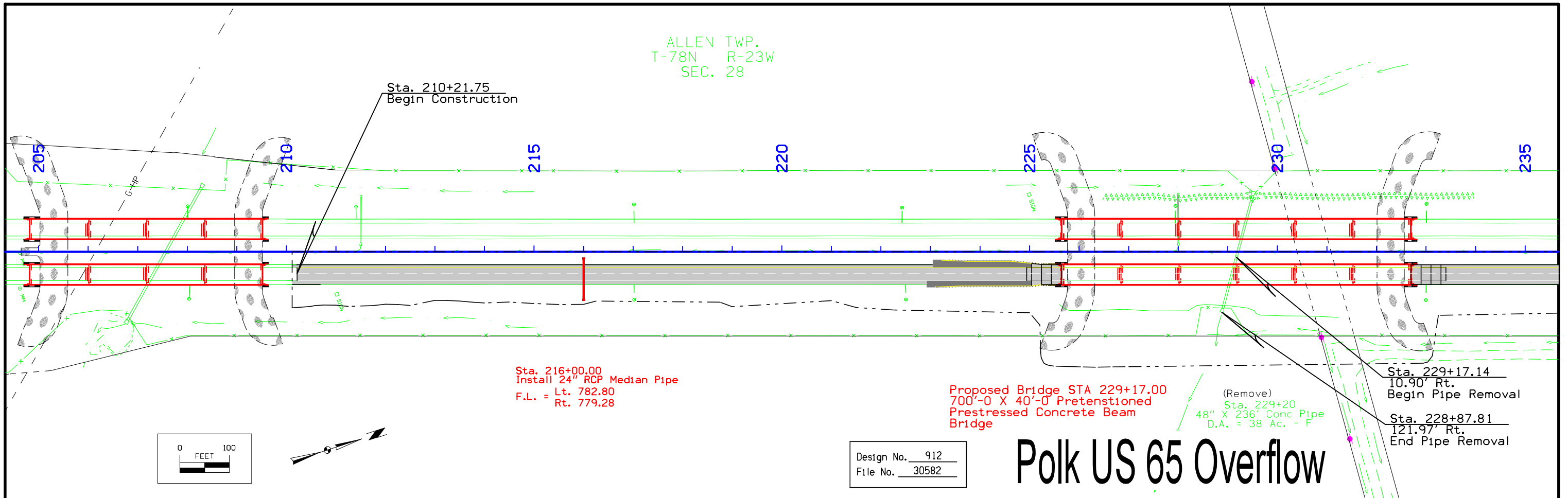

Suitable Cut = 14827 CY  
Unsuitable Cut = 28136 CY  
= 42963 CY

Fill+30% = 11287 CY  
Suitable Waste = 3540 CY  
Unsuitable Waste = 28136 CY  
= 42963 CY

